

| WETLAND IMPACT SUMMARY |                        |          |                        |   |                               |    |           |    |
|------------------------|------------------------|----------|------------------------|---|-------------------------------|----|-----------|----|
| WETLAND NUMBER         | WETLAND CLASSIFICATION | LOCATION | AREA IMPACTS           |   |                               |    |           |    |
|                        |                        |          | PERMANENT              |   |                               |    | TEMPORARY |    |
|                        |                        |          | N.H.W.B. (NON-WETLAND) |   | N.H.W.B. & A.C.O.E. (WETLAND) |    | SF        | LF |
| 1                      | L2RBr                  | A        | -                      | - | 17                            | 13 | -         | -  |
| 1                      | L2RBr                  | B        | -                      | - | 16                            | 11 | -         | -  |
| 1                      | L2RBr                  | C        | -                      | - | -                             | -  | 422       | 64 |
| 1                      | BANK                   | D        | -                      | - | -                             | -  | 8         | 4  |
| 1                      | BANK                   | E        | -                      | - | -                             | -  | 10        | 10 |
| TOTAL                  |                        |          | -                      | - | 33                            | 24 | 440       | 78 |

PERMANENT IMPACTS: 33 SF/24 LF  
 TEMPORARY IMPACTS: 440 SF/78 LF  
 TOTAL IMPACTS: 473 SF/102 LF

| TYPE OF WETLAND IMPACT   |  | SHADING/HATCHING      | #                     | WETLAND DESIGNATION NUMBER  |
|--|--|-----------------------|-----------------------|---|
| NEW HAMPSHIRE WETLANDS BUREAU & ARMY CORP OF ENGINEERS (PERMANENT WETLAND) |  | [Solid Grey]          | #                     | WETLAND IMPACT LOCATION   |
| TEMPORARY IMPACTS  |  | [Cross-hatch]         | -TOB-                 | TOP OF BANK   |
|  |  | [Dashed Line]         | -NHW-                 | NORMAL HIGH WATER   |
|  |  | [Circle with 'NB/PC'] | [Circle with 'NB/PC'] | NATURAL BUFFER/PERIMETER CONTROL  |
|  |  | [Dashed Line]         | [Dashed Line]         | SILT FENCE (2 ROWS)<br>EROSION CONTROL MIX BERM<br>EROSION CONTROL MIX SOX<br>TURBIDITY CURTAIN<br>SHEET PILE<br>COFFER DAM |

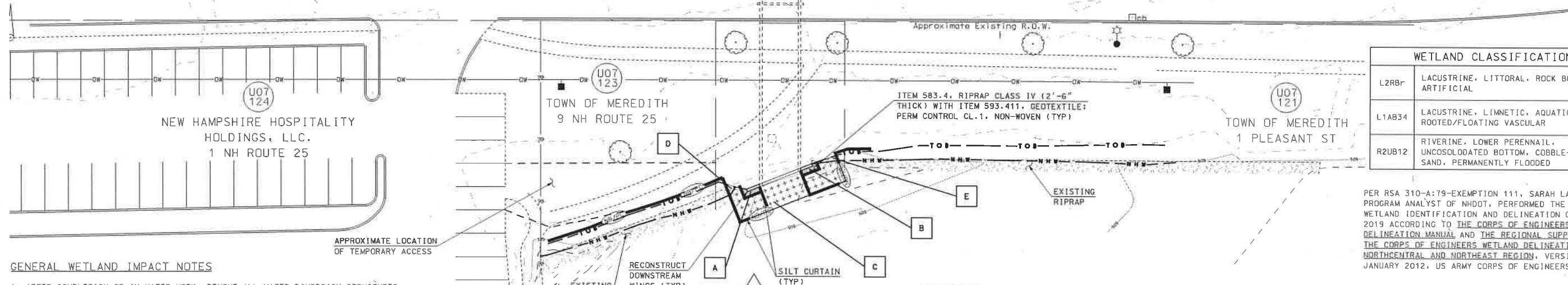
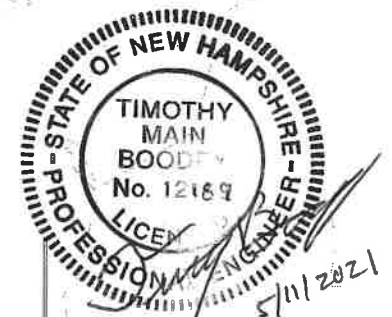
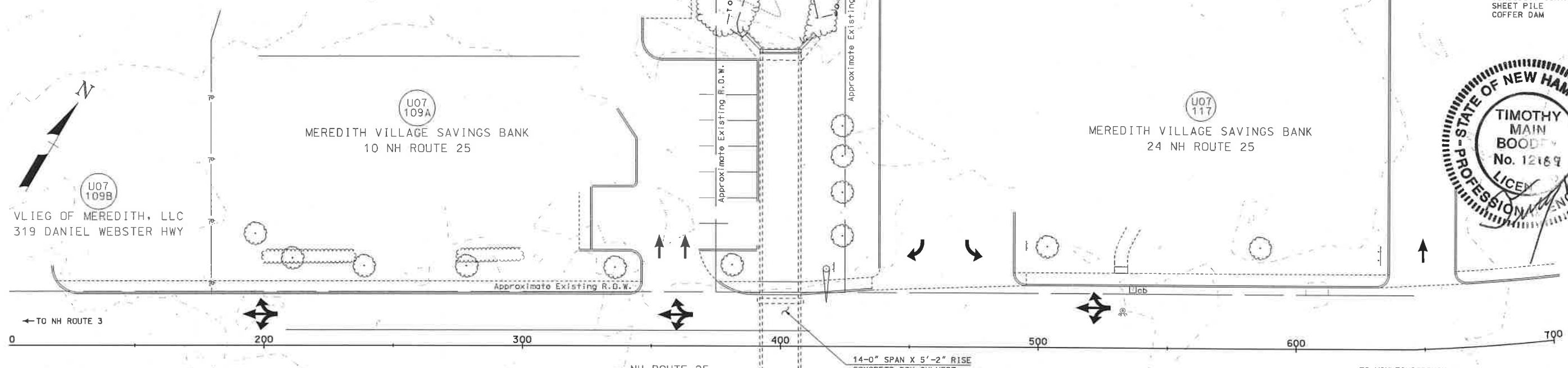

| WETLAND CLASSIFICATION |  |
|------------------------|--|
| L2RBr                  | LACUSTRINE, LITTORAL, ROCK BOTTOM, ARTIFICIAL  |
| L1AB34                 | LACUSTRINE, LIMNETIC, AQUATIC BED, ROOTED/FLOATING VASCULAR                                |
| R2UB12                 | RIVERINE, LOWER PERENNIAL, UNCONSOLIDATED BOTTOM, COBBLE-GRAVEL, SAND, PERMANENTLY FLOODED |

PER RSA 310-A:79-EXEMPTION 111, SARAH LARGE WETLANDS PROGRAM ANALYST OF NHDDT, PERFORMED THE ORIGINAL WETLAND IDENTIFICATION AND DELINEATION ON AUGUST 6, 2019 ACCORDING TO THE CORPS OF ENGINEERS WETLAND DELINEATION MANUAL AND THE REGIONAL SUPPLEMENT TO THE CORPS OF ENGINEERS WETLAND DELINEATION MANUAL, NORTH-CENTRAL AND NORTHEAST REGION, VERSION 2.0, JANUARY 2012, US ARMY CORPS OF ENGINEERS.

- GENERAL WETLAND IMPACT NOTES**
- AFTER COMPLETION OF IN-WATER WORK, REMOVE ALL WATER DIVERSION STRUCTURES AND RESTORE ALL DISTURBED AREAS TO PRE-CONSTRUCTION CONDITIONS. RESTORATION OF DISTURBED AREAS BEYOND THE LIMITS AS SHOWN ON THESE PLANS TO SUIT CONTRACTOR'S MEANS AND METHODS SHALL BE SUBSIDIARY TO ITEM 503.101.
  - EFFLUENT REMOVED FROM DEWATERING EFFORTS SHALL BE PUMPED INTO A TANK AND REMOVED FROM SITE.
  - NO STAGING SHALL BE PERMITTED WITHIN THE LIMITS OF THE PARK.
  - ALL CONSTRUCTION SHALL REMAIN WITHIN THE NHDDT RIGHT-OF-WAY LIMITS.
  - WRITTEN PERMISSION HAS BEEN OBTAINED FROM THE TOWN OF MERIDITH TO ACCESS AT LOCATION SHOWN ON THE PLAN.

WETLAND PLAN BR NO 189/150  
 SCALE IN FEET

Hoyle, Tanner & Associates, Inc.

| STATE OF NEW HAMPSHIRE                                      |  |                                  |  |                     |  |                                  |  |              |  |
|---|--|----------------------------------|--|---------------------|--|----------------------------------|--|--------------|--|
| DEPARTMENT OF TRANSPORTATION * BUREAU OF BRIDGE MAINTENANCE |  |                                  |  |                     |  |                                  |  |              |  |
| TOWN MERIDITH   |  | BRIDGE NO. 189/150               |  | STATE PROJECT 42828 |  | LOCATION NH 25 OVER SWAMP OUTLET |  | BRIDGE SHEET |  |
| WETLAND IMPACTS PLAN  |  |                                  |  |                     |  |                                  |  | OF           |  |
| HTA PROJECT NO. 092592.05                                   |  | MODEL 41768wetplan 189_150       |  | DESIGNED            |  | BY DATE                          |  | BY DATE      |  |
| SUBDIRECTORY XX   |  | DGN LOCATOR 41768wetplan 189-150 |  | DRAWN               |  | B/JN 04/21                       |  | CHECKED      |  |
|   |  |                                  |  | QUANTITIES          |  | ---                              |  | ---          |  |
|   |  |                                  |  | ISSUE DATE          |  | FEDERAL PROJECT NO.              |  | SHEET NO.    |  |
|   |  |                                  |  | REV. DATE           |  |                                  |  | 1            |  |
|   |  |                                  |  |                     |  |                                  |  | 2            |  |

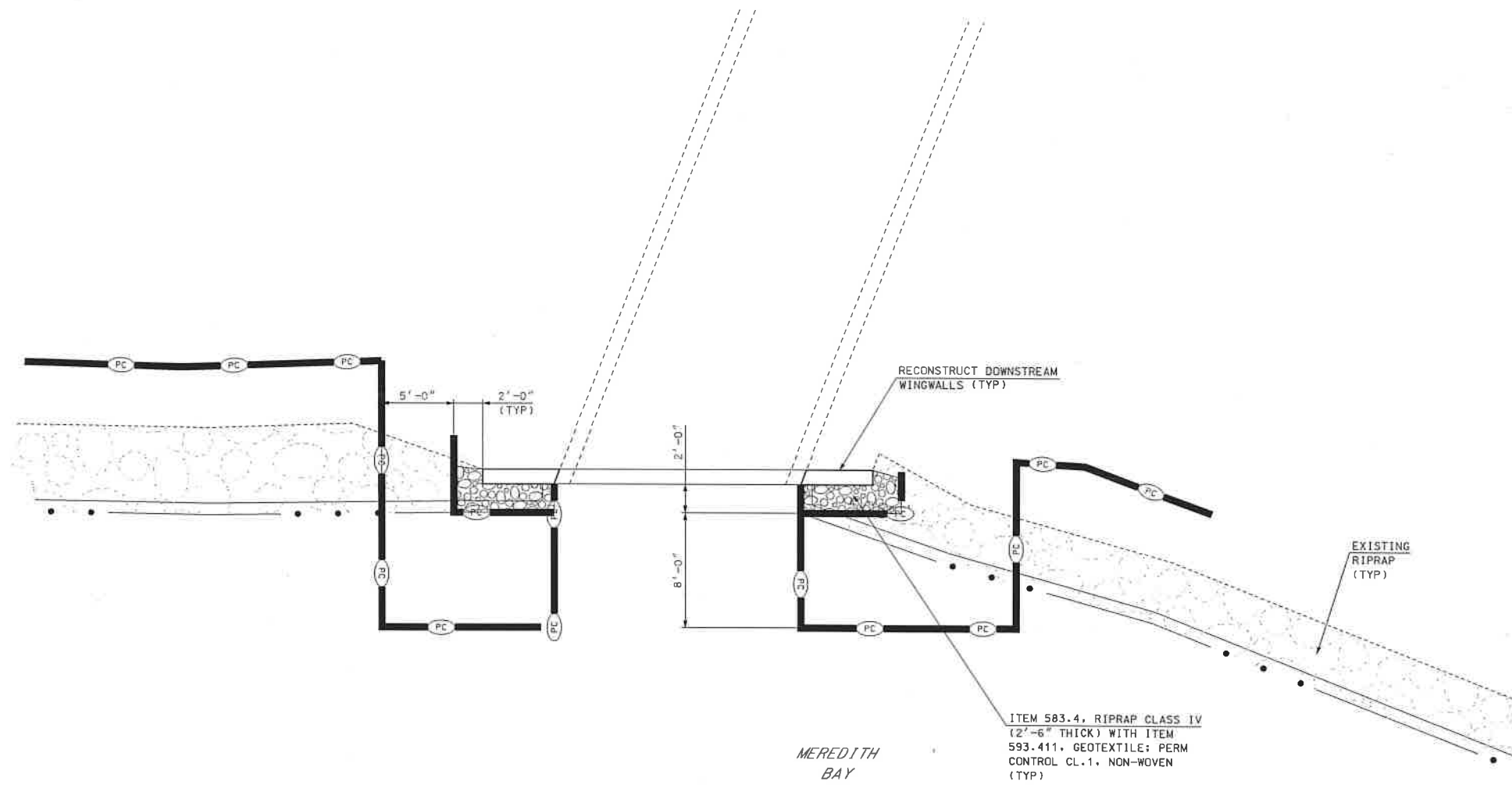

DOWNSTREAM WING DETAIL

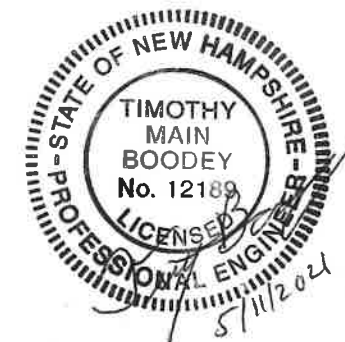

**Hoyle, Tanner & Associates, Inc.**

|                 |                                |             |
|-----------------|--------------------------------|-------------|
| HTA PROJECT NO. | MODEL                          |             |
| 092592.05       | R1768Siteplan 189 150 60 Scale |             |
| SUBDIRECTORY    | DGN LOCATOR                    | SHEET SCALE |
| XX              | 41768Siteplan 189-150          | AS SHOWN    |

|   |          |                     |         |               |         |              |             |  |  |
|---|----------|---------------------|---------|---------------|---------|--------------|-------------|--|--|
| STATE OF NEW HAMPSHIRE                                      |          |                     |         |               |         |              |             |  |  |
| DEPARTMENT OF TRANSPORTATION * BUREAU OF BRIDGE MAINTENANCE |          |                     |         |               |         |              |             |  |  |
| TOWN  | MEREDITH | BRIDGE NO.          | 189/150 | STATE PROJECT | 42R28   |              |             |  |  |
| LOCATION NII 25 OVER SWAMP OUTLET                           |          |                     |         |               |         |              |             |  |  |
| DOWNSTREAM DETAIL   |          |                     |         |               |         |              |             |  |  |
| REVISIONS AFTER PROPOSAL                                    |          | BY                  | DATE    | BY            | DATE    | BRIDGE SHEET | OF          |  |  |
|   |          | DESIGNED            | ---     | CHECKED       | ---     | ---          | FILE NUMBER |  |  |
|   |          | DRAWN               | BJN     | 04/21         | CHECKED | ---          | ---         |  |  |
|   |          | QUANTITIES          | ---     | CHECKED       | ---     | ---          | ---         |  |  |
| ISSUE DATE  |          | FEDERAL PROJECT NO. |         | SHEET NO.     |         | TOTAL SHEETS |             |  |  |
| REV. DATE   |          |                     |         | 2             |         | 2            |             |  |  |