

SIMPLE RAMP TERMINAL

THE TRAFFIC MOVEMENT WITH THE HIGHEST VOLUME WILL BE STRAIGHT THRU. THIS CASE SHOWS HEAVY VOLUMES TO THE RIGHT.

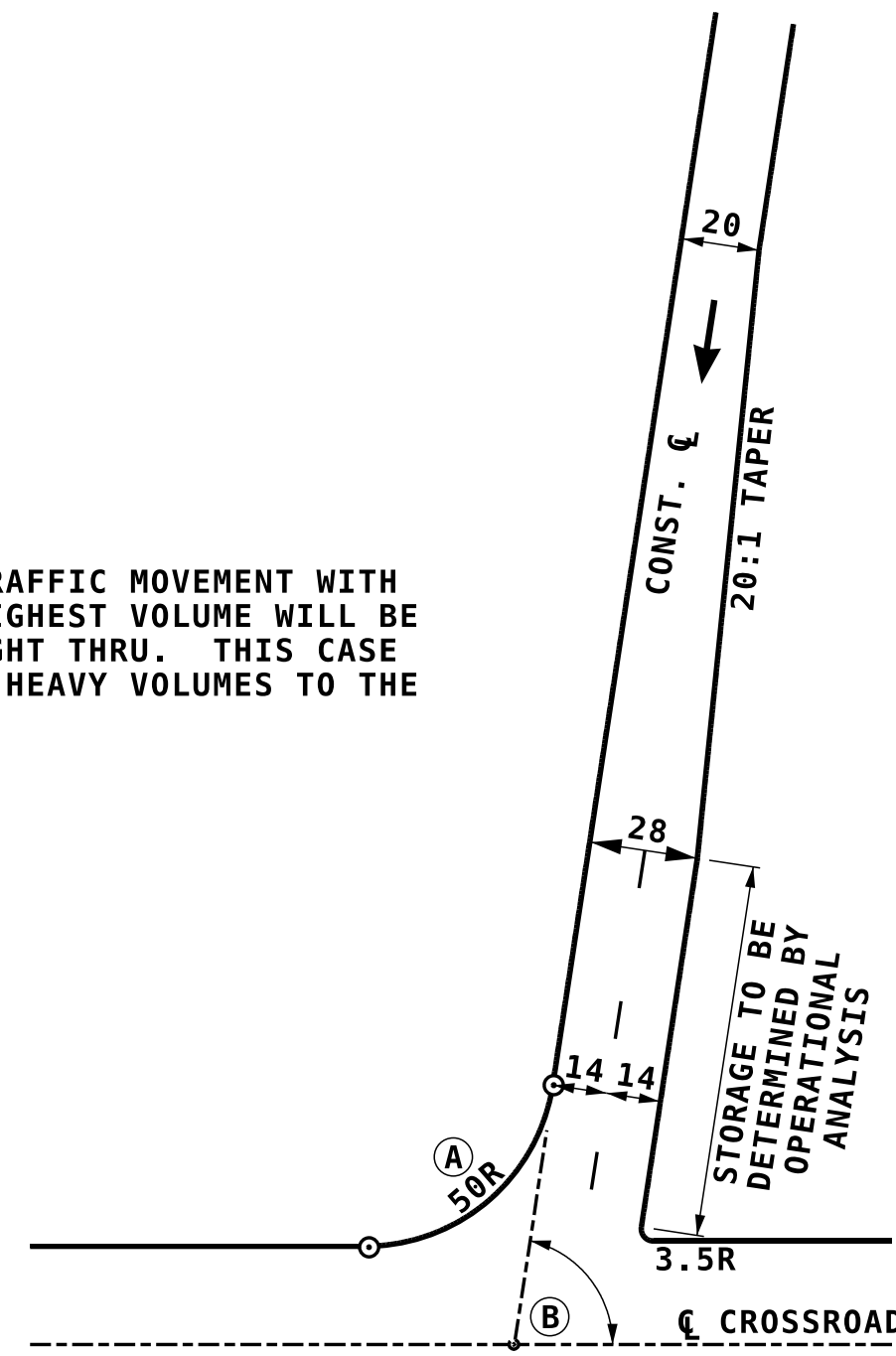

RAMP TERMINAL WITH RIGHT TURN LANE

THE COMPOUND CURVES WILL BE ADJUSTED WITH DIFFERING SKEW ANGLES IN ORDER TO MAINTAIN AN ANGLE OF ENTRANCE NOT LESS THAN 45°, BUT DESIRABLY GREATER THAN 60°.

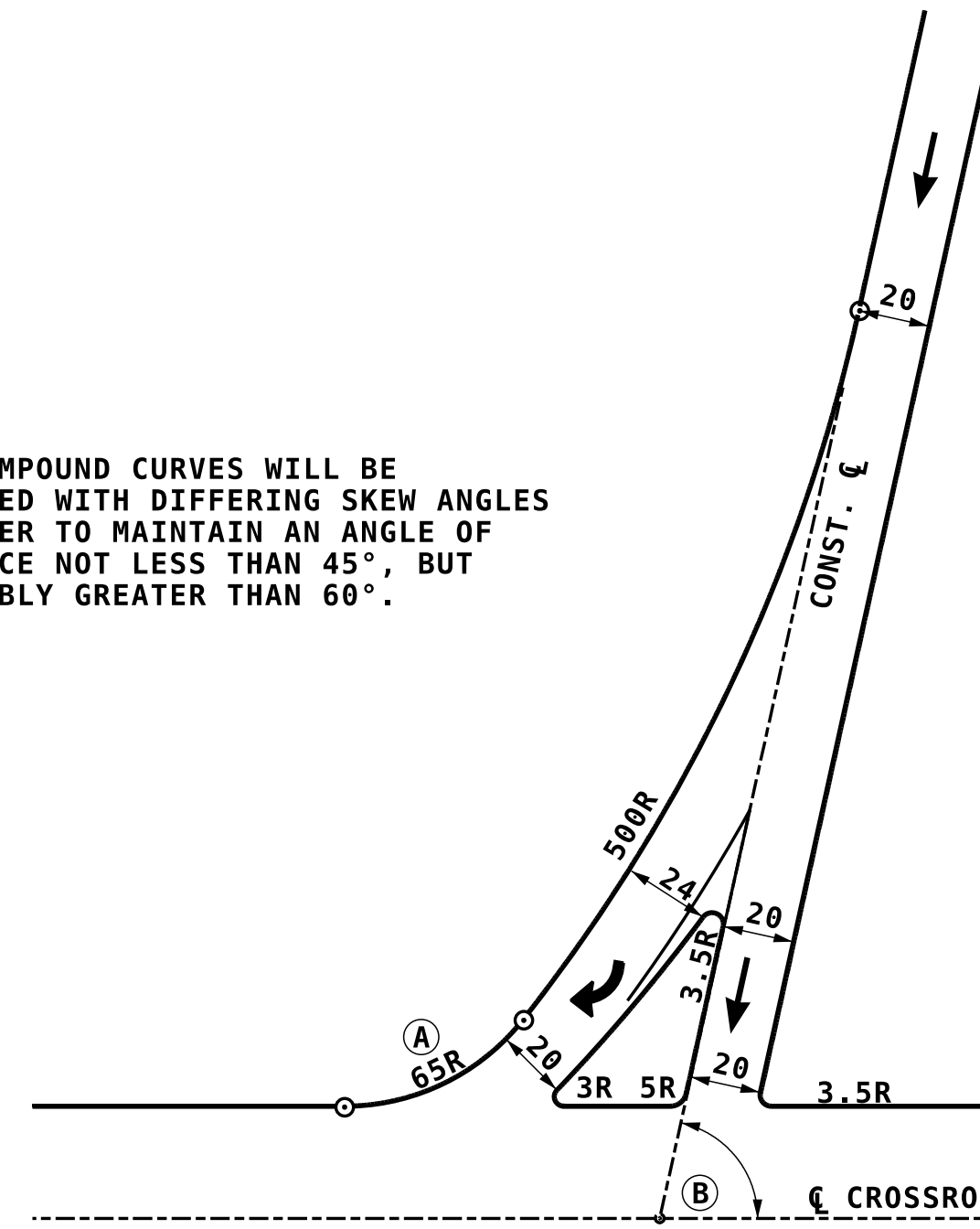

RAMP TERMINAL WITH RIGHT TURN LANE AND YIELD CONDITION

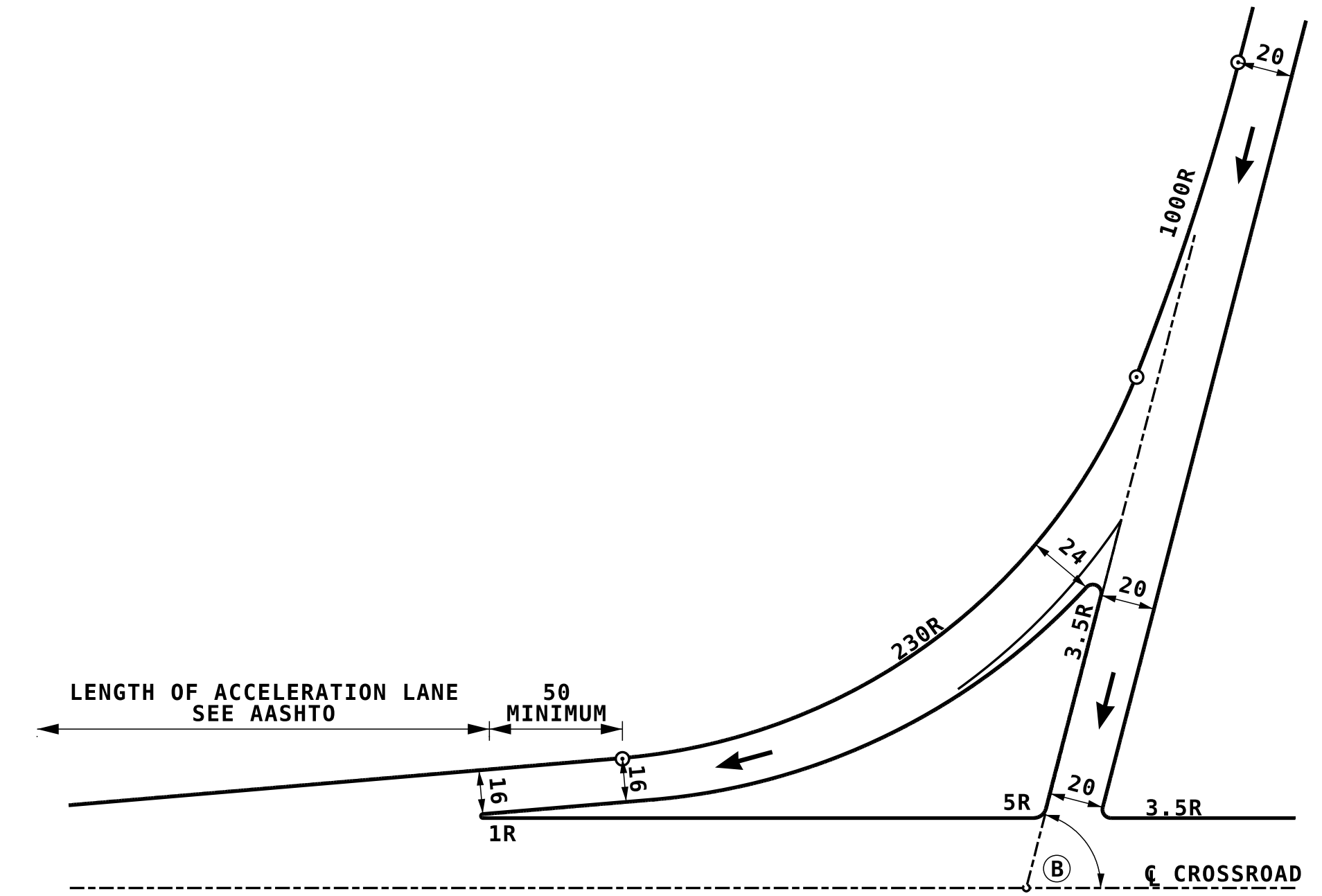

RAMP TERMINAL WITH FREE RIGHT TURN

CURBED RAMP TERMINALS

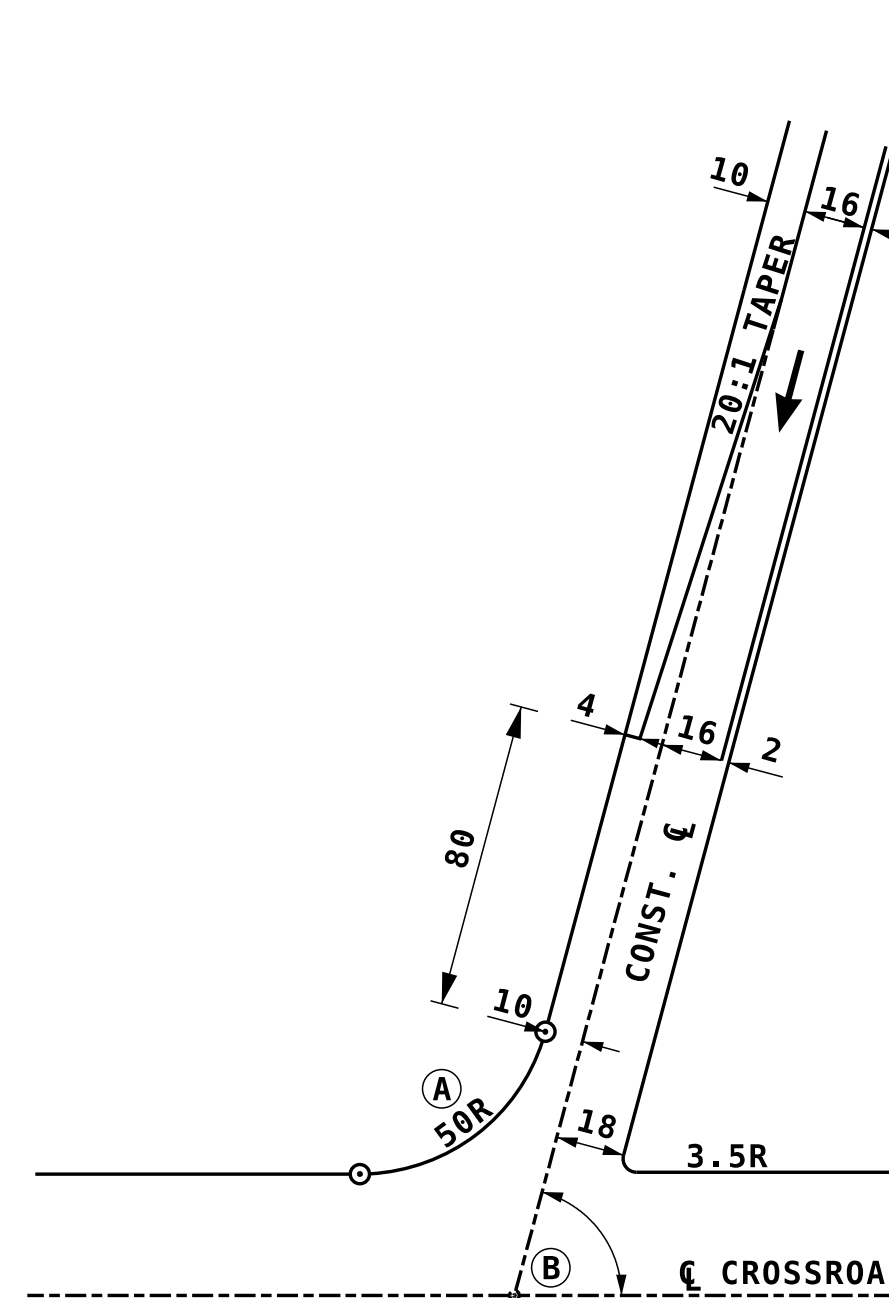

SIMPLE RAMP TERMINAL

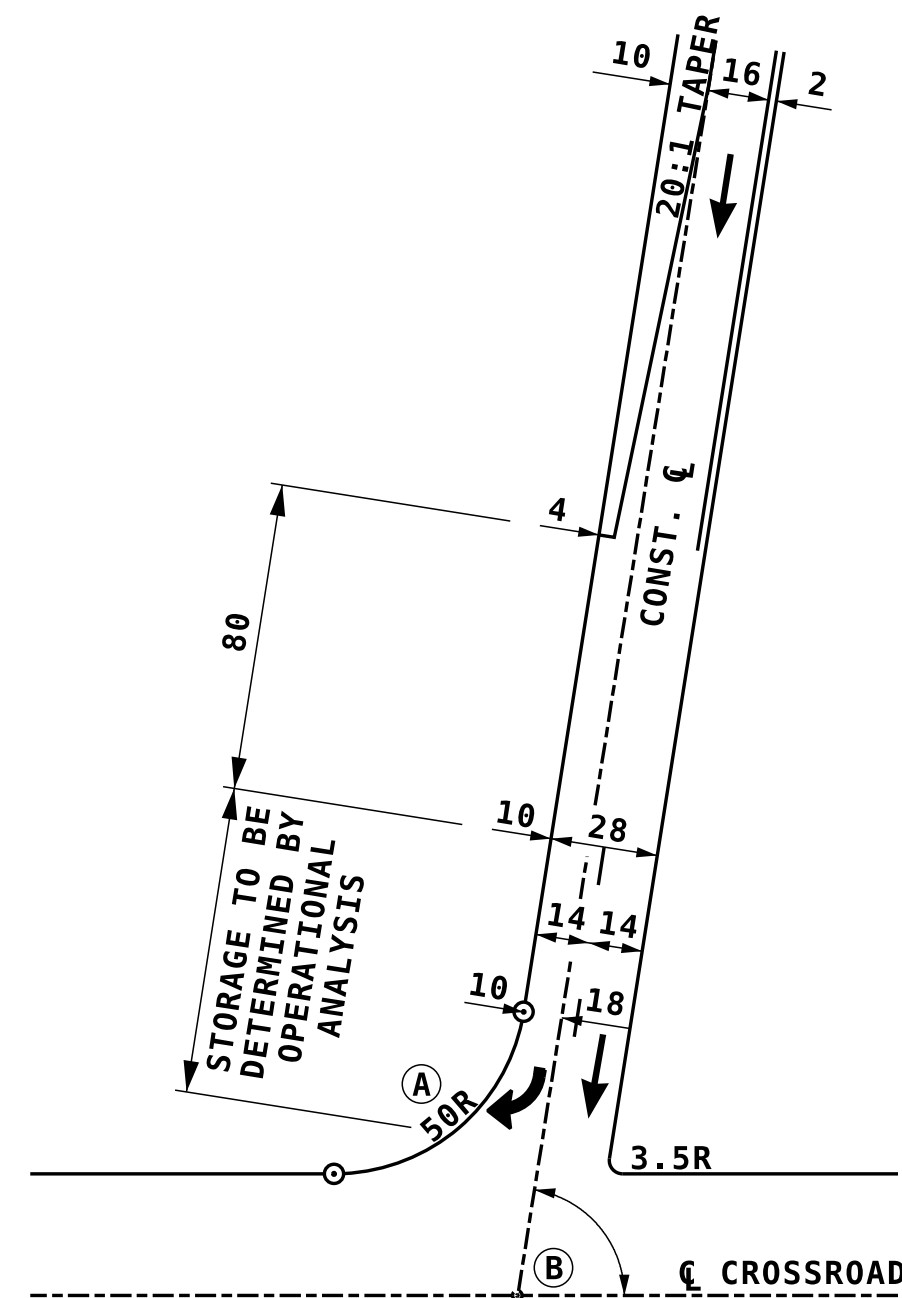

RAMP TERMINAL WITH RIGHT TURN LANE

THE COMPOUND CURVES WILL BE ADJUSTED WITH DIFFERING SKEW ANGLES IN ORDER TO MAINTAIN AN ANGLE OF ENTRANCE NOT LESS THAN 45°, BUT DESIRABLY GREATER THAN 60°.

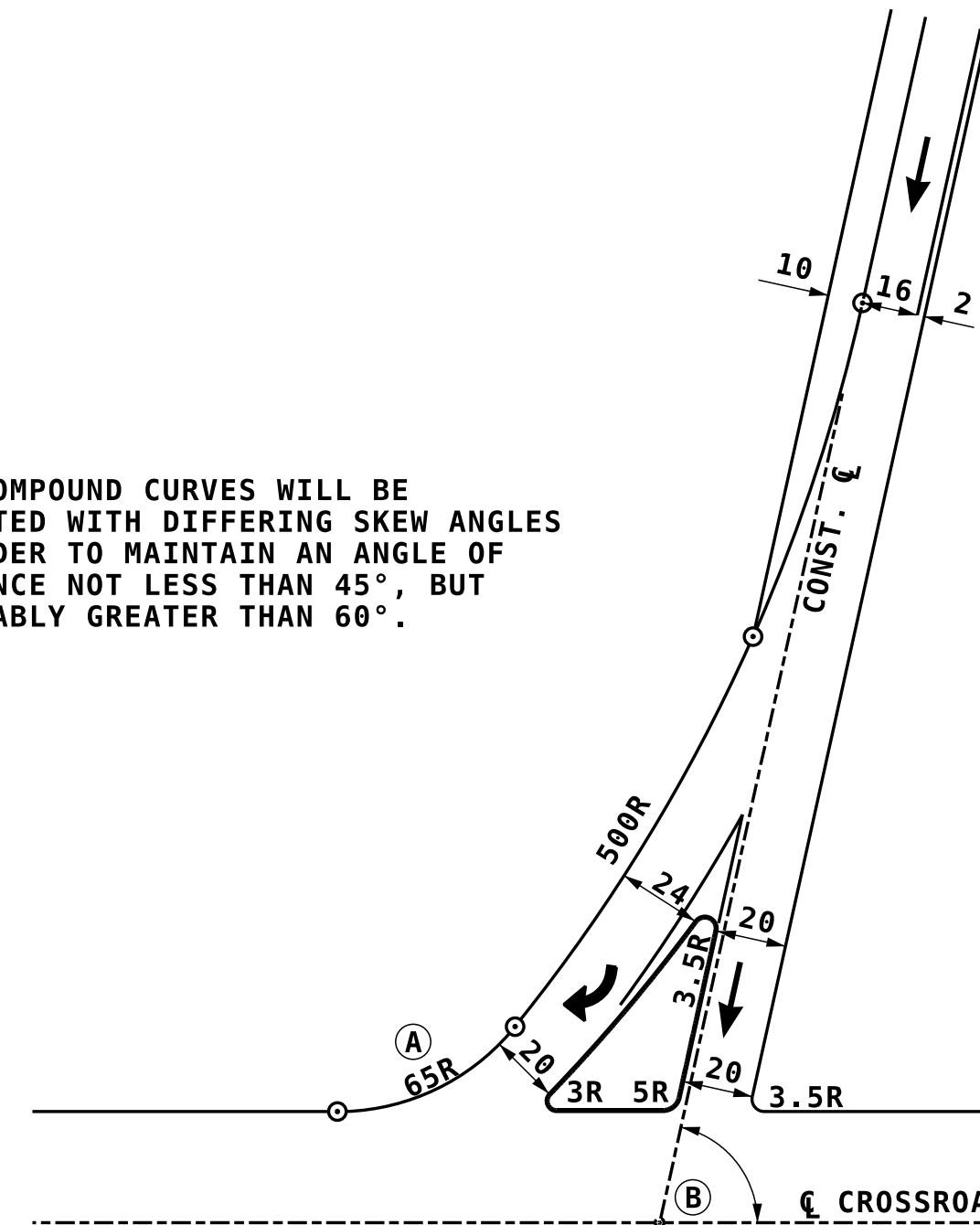

RAMP TERMINAL WITH RIGHT TURN LANE AND YIELD CONDITION

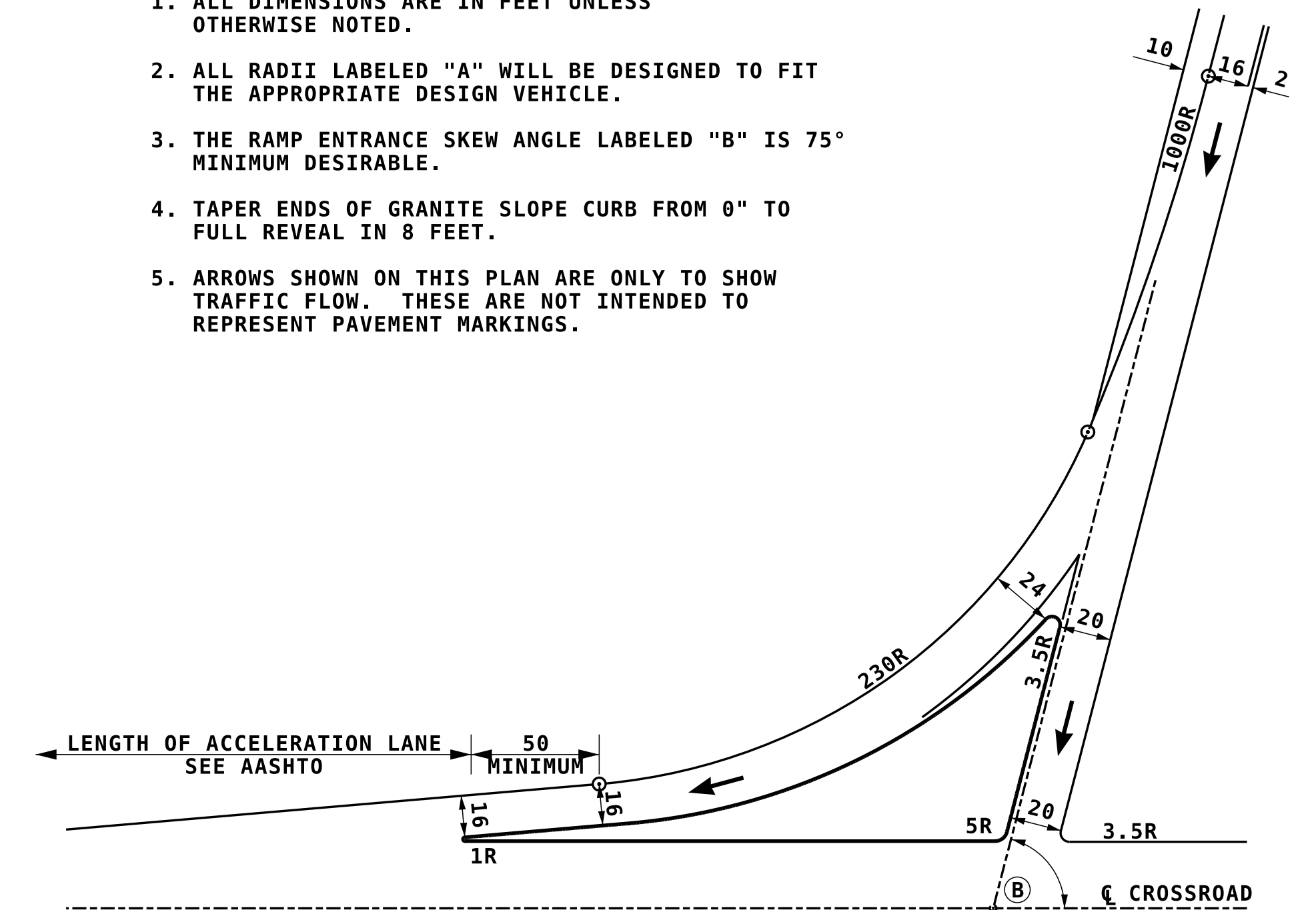

RAMP TERMINAL WITH FREE RIGHT TURN

NOTES:

1. ALL DIMENSIONS ARE IN FEET UNLESS OTHERWISE NOTED.
2. ALL RADII LABELED "A" WILL BE DESIGNED TO FIT THE APPROPRIATE DESIGN VEHICLE.
3. THE RAMP ENTRANCE SKEW ANGLE LABELED "B" IS 75° MINIMUM DESIRABLE.
4. TAPER ENDS OF GRANITE SLOPE CURB FROM 0" TO FULL REVEAL IN 8 FEET.
5. ARROWS SHOWN ON THIS PLAN ARE ONLY TO SHOW TRAFFIC FLOW. THESE ARE NOT INTENDED TO REPRESENT PAVEMENT MARKINGS.

UNCURBED RAMP TERMINALS

STATE OF NEW HAMPSHIRE
SAMPLE
DEPARTMENT OF TRANSPORTATION BUREAU OF HIGHWAY DESIGN

RAMP EXIT TERMINALS

REVISION DATE	DGN	STATE PROJECT NO.	SHEET NO.	TOTAL SHEETS
DM_SAM-5 08/29/2023	dm-sam-5	12345	5	19