

STATE OF NEW HAMPSHIRE
DEPARTMENT OF TRANSPORTATION

WETLAND PLANS

X-A002(923)
N.H. PROJECT NO. 24579

DESIGN DATA	
AVERAGE DAILY TRAFFIC 2017	438
AVERAGE DAILY TRAFFIC 2039	648
PERCENT OF TRUCKS	10%
DESIGN SPEED	20 M.P.H.
LENGTH OF PROJECT	0.101 MILES

WAUKEWAN ROAD BRIDGE OVER LAKE WAUKEWAN INLET
BRIDGE REPLACEMENT

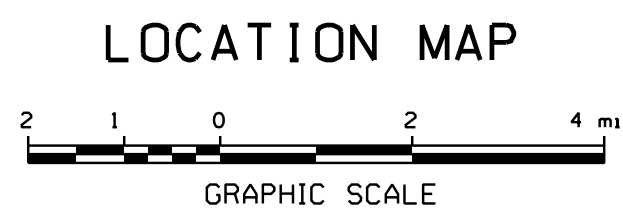
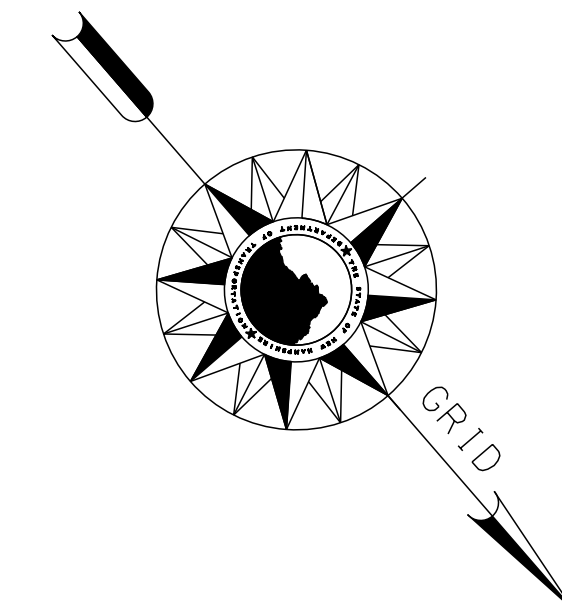
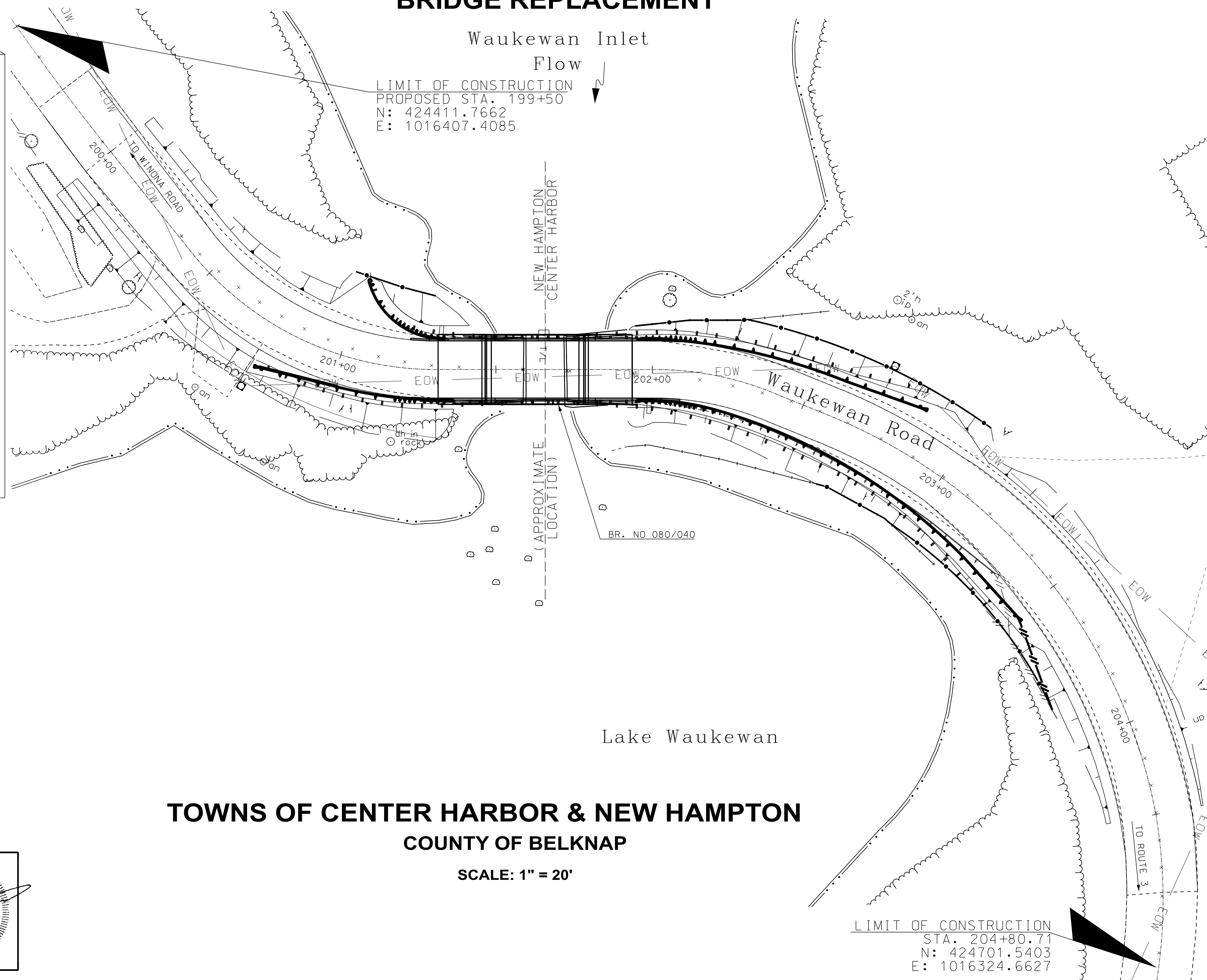
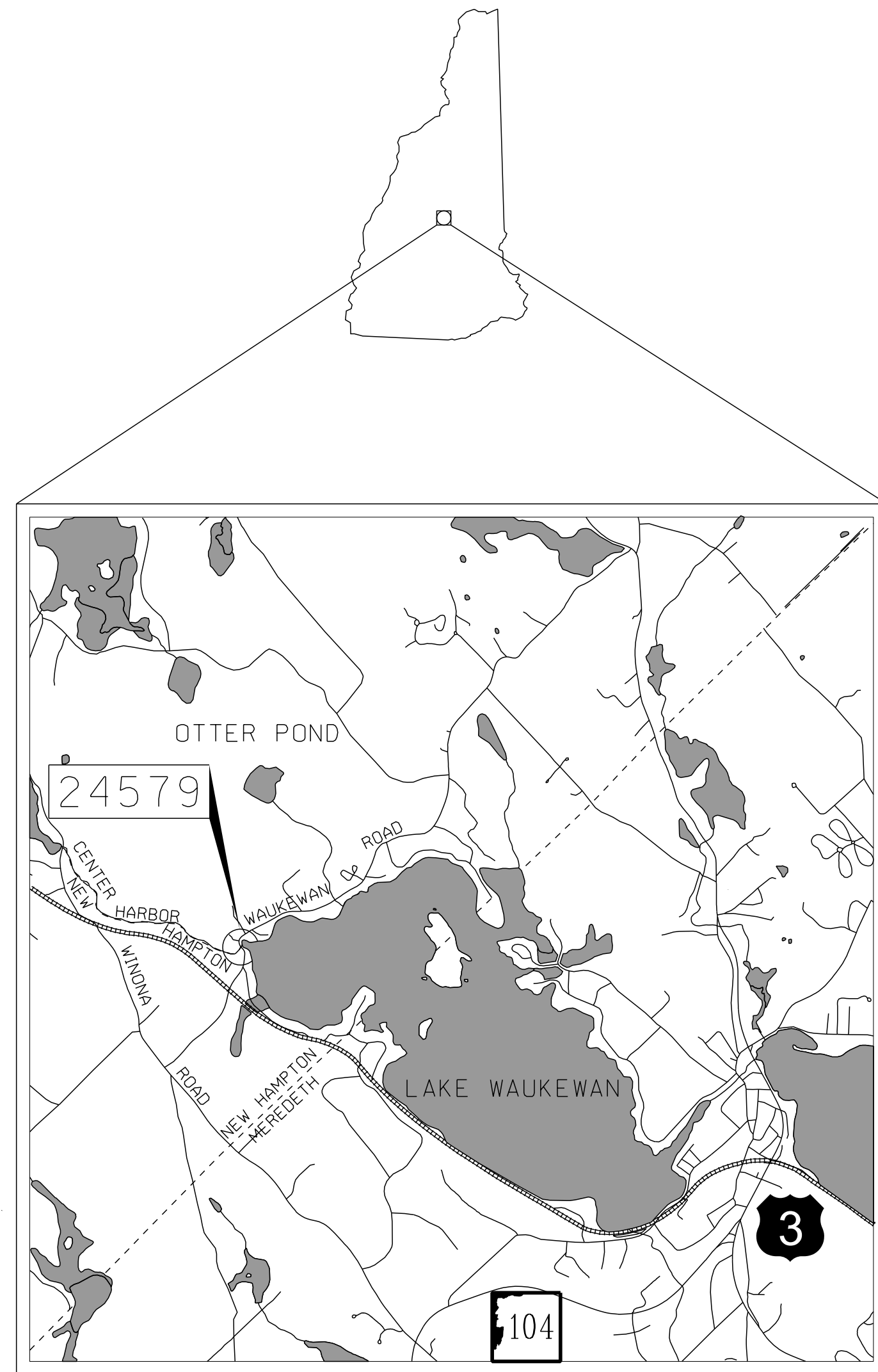

INDEX OF SHEETS

- 1 COVER SHEET
- 2-3 STANDARD SYMBOLS SHEETS
- 4 WETLAND IMPACT SUMMARY
- 5 WETLAND IMPACT PLAN
- 6 EROSION CONTROL STRATEGIES
- 7 EROSION CONTROL PLAN
- 8 LANDSCAPING PLAN

TOWNS OF CENTER HARBOR & NEW HAMPTON
COUNTY OF BELKNAP

SCALE: 1" = 20'

NH DOT THE STATE OF
NEW HAMPSHIRE
DEPARTMENT OF
TRANSPORTATION

RECOMMENDED FOR APPROVAL:

DIRECTOR OF PROJECT DEVELOPMENT DATE

APPROVED:

ASSISTANT COMMISSIONER AND CHIEF ENGINEER DATE

FEDERAL PROJECT NO.	STATE PROJECT NO.	SHEET NO.	TOTAL SHEETS
X-A002(923)	24579	1	8

DRAWN BY EYS DATE 10/20/2020
CHECKED BY CRF DATE 10/20/2020

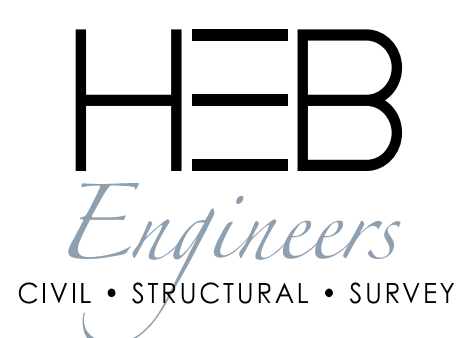

HEB Engineers, Inc.
Post Office Box 440
2605 White Mountain Hwy.
North Conway, NH 03860
www.hebenengineers.com
Office (603) 356-6936
Fax (603) 356-7715

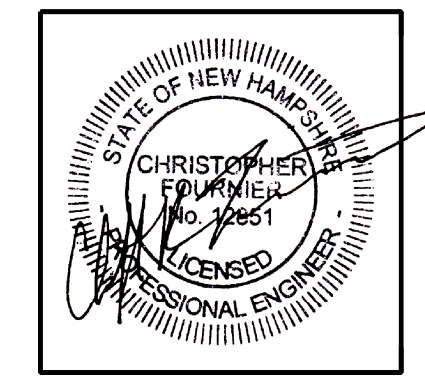

LIMIT OF CONSTRUCTION
STA. 204+80.71
N: 424701.5403
E: 1016324.6627

GENERAL

EDGE OF PAVEMENT TRAVELED WAY			
DRIVEWAYS			
BUILDINGS			
FOUNDATION			
LEACH FIELD			
BRIDGE CROSSINGS			
STEPS AND WALK			
INTERMITTENT WATER COURSE			
SHORE LINE			
POTENTIAL WET AREA SYMBOL			
BRUSH OR WOODS LINE			
TREES (PLANS)			
TREE OR STUMP (CROSS-SECTIONS)			
HEDGE			
MONITORING WELL			
WELL			
FLAG POLE			

ORIGINAL GROUND (TYPICALS)	
ROCK OUTCROP	
ROCK LINE (TYPICALS & SECTIONS ONLY)	
GUARDRAIL (label type)	
JERSEY BARRIER	
CURB (LABEL TYPE)	
STONE WALL	
RETAINING WALL (LABEL TYPE)	
FENCE (LABEL TYPE)	
SIGNS	
GAS PUMP	
FUEL TANK (ABOVE GROUND)	
STORAGE TANK FILLER CAP	
SEPTIC TANK	
GRAVE	
MAILBOX	
VENT PIPE	
SATELLITE DISH ANTENNA	
PHONE	
GROUND LIGHT/LAMP POST	
BORING LOCATION	
TEST PIT	
INTERSTATE NUMBERED HIGHWAY	
UNITED STATES NUMBERED HIGHWAY	
STATE NUMBERED HIGHWAY	

SHORELAND - WETLAND

WETLAND DESIGNATION AND TYPE	
DELINEATED WETLAND	
ORDINARY HIGH WATER	
TOP OF BANK	
TOP OF BANK & ORDINARY HIGH WATER	
NORMAL HIGH WATER	
WIDTH AT BANK FULL	
PRIME WETLAND	
PRIME WETLAND 100' BUFFER	
NON-JURISDICTIONAL DRAINAGE AREA	
COWARDIN DISTINCTION LINE	
TIDAL BUFFER ZONE	
DEVELOPED TIDAL BUFFER ZONE	
HIGHEST OBSERVABLE TIDE LINE	
MEAN HIGH WATER	
MEAN LOW WATER	
VERNAL POOL	
SPECIAL AQUATIC SITE	
REFERENCE LINE	
WATER FRONT BUFFER	
NATURAL WOODLAND BUFFER	
PROTECTED SHORELAND	
INVASIVE SPECIES LABEL	
INVASIVE SPECIES	

FLOODPLAIN / FLOODWAY

500 YEAR FLOODPLAIN BOUNDARY	
100 YEAR FLOODPLAIN BOUNDARY	
FLOODWAY	

ENGINEERING

CONSTRUCTION BASELINE	
PC, PT, POT (ON CONST BASELINE)	
PI (IN CONSTRUCTION BASELINES)	
INTERSECTION OR EQUATION OF TWO LINES	
ORIGINAL GROUND LINE (PROFILES AND CROSS-SECTIONS)	
PROFILE GRADE LINE (PROFILES AND CROSS-SECTIONS)	
CLEARING LINE	
SLOPE LINE	
SLOPE LINE (FILL)	
SLOPE LINE (CUT)	
PROFILES AND CROSS SECTIONS:	
ORIGINAL GROUND ELEVATION (LEFT)	
FINISHED GRADE ELEVATION (RIGHT)	

DRAINAGE

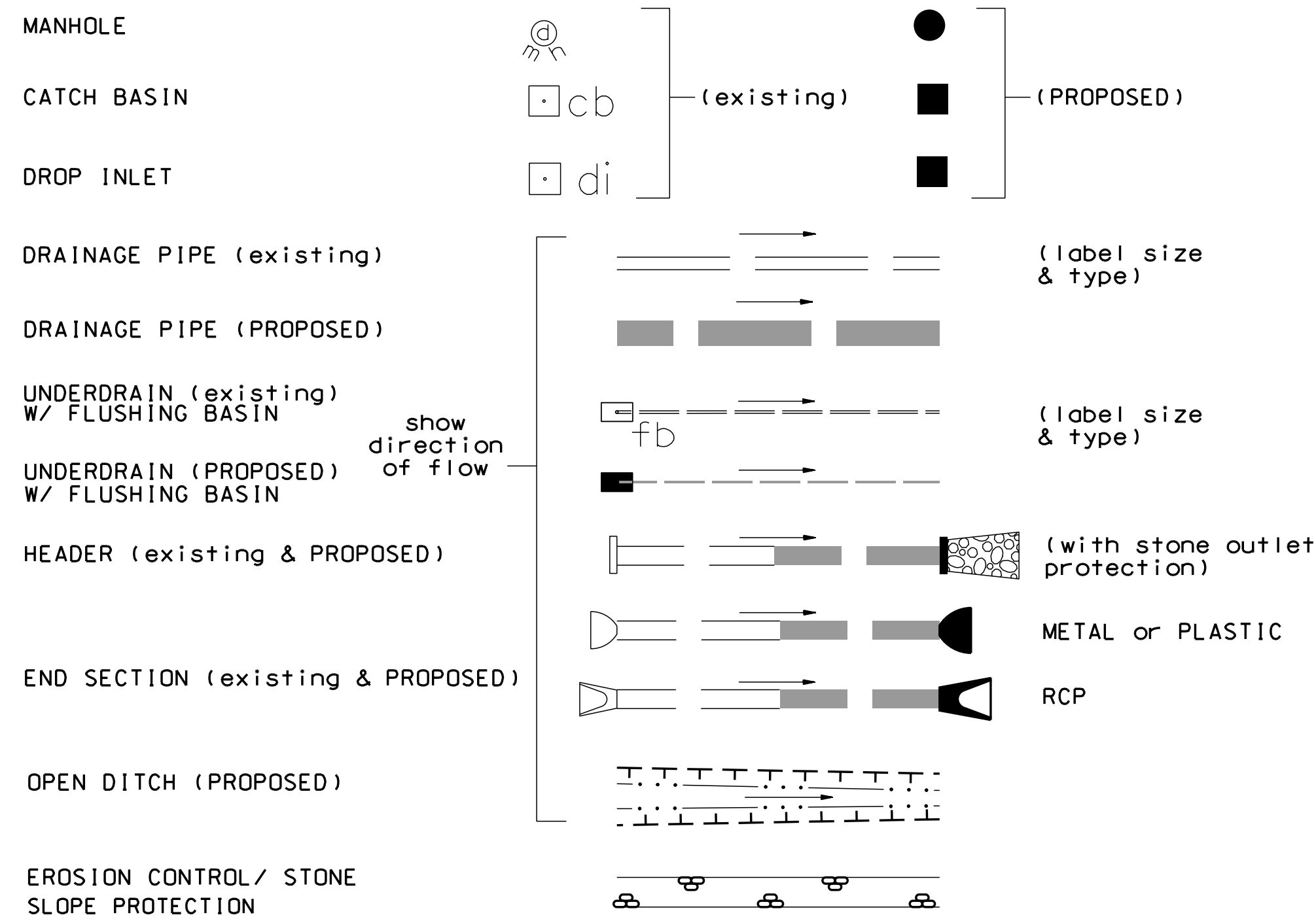

BOUNDARIES / RIGHT-OF-WAY

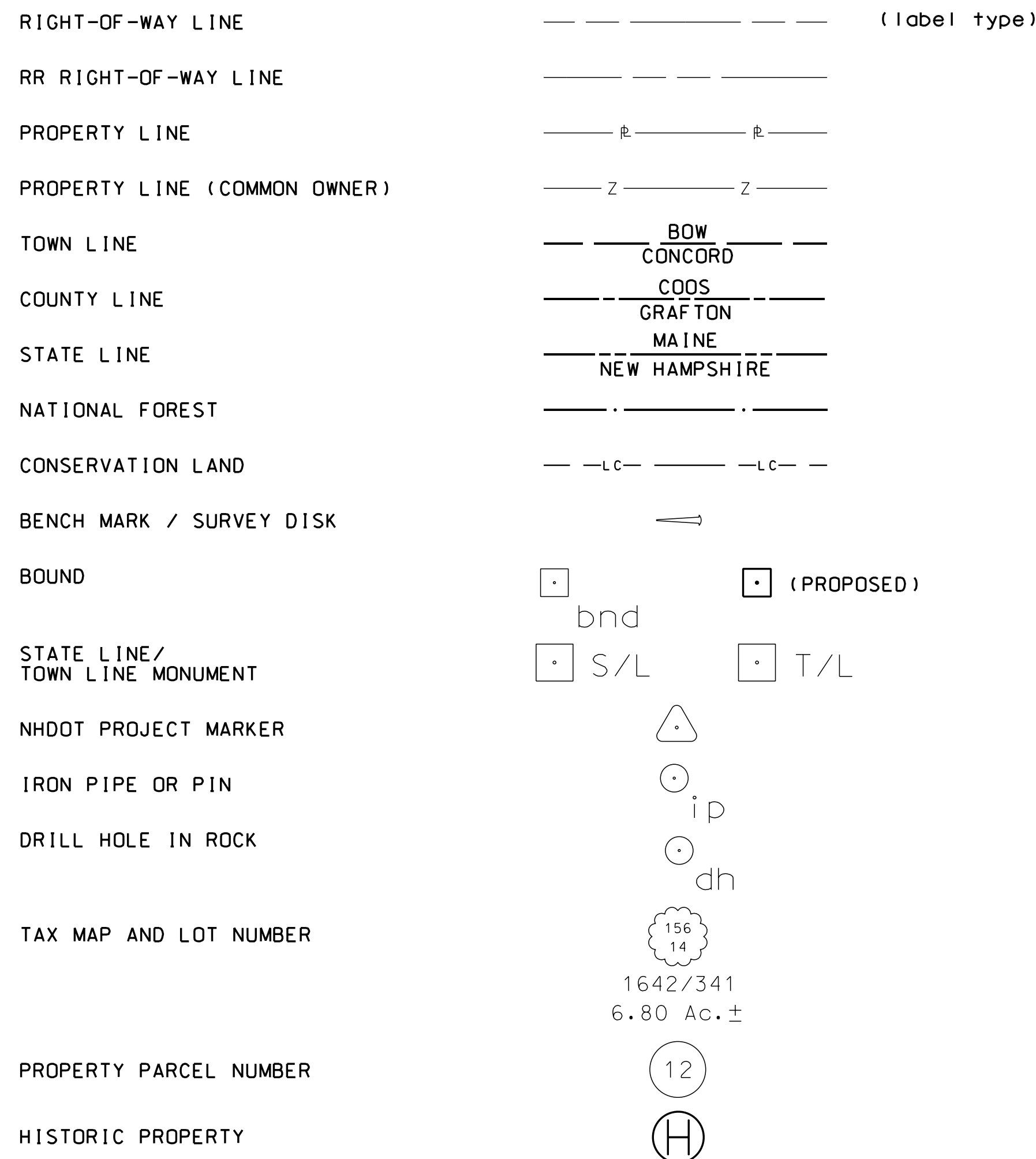

UTILITIES

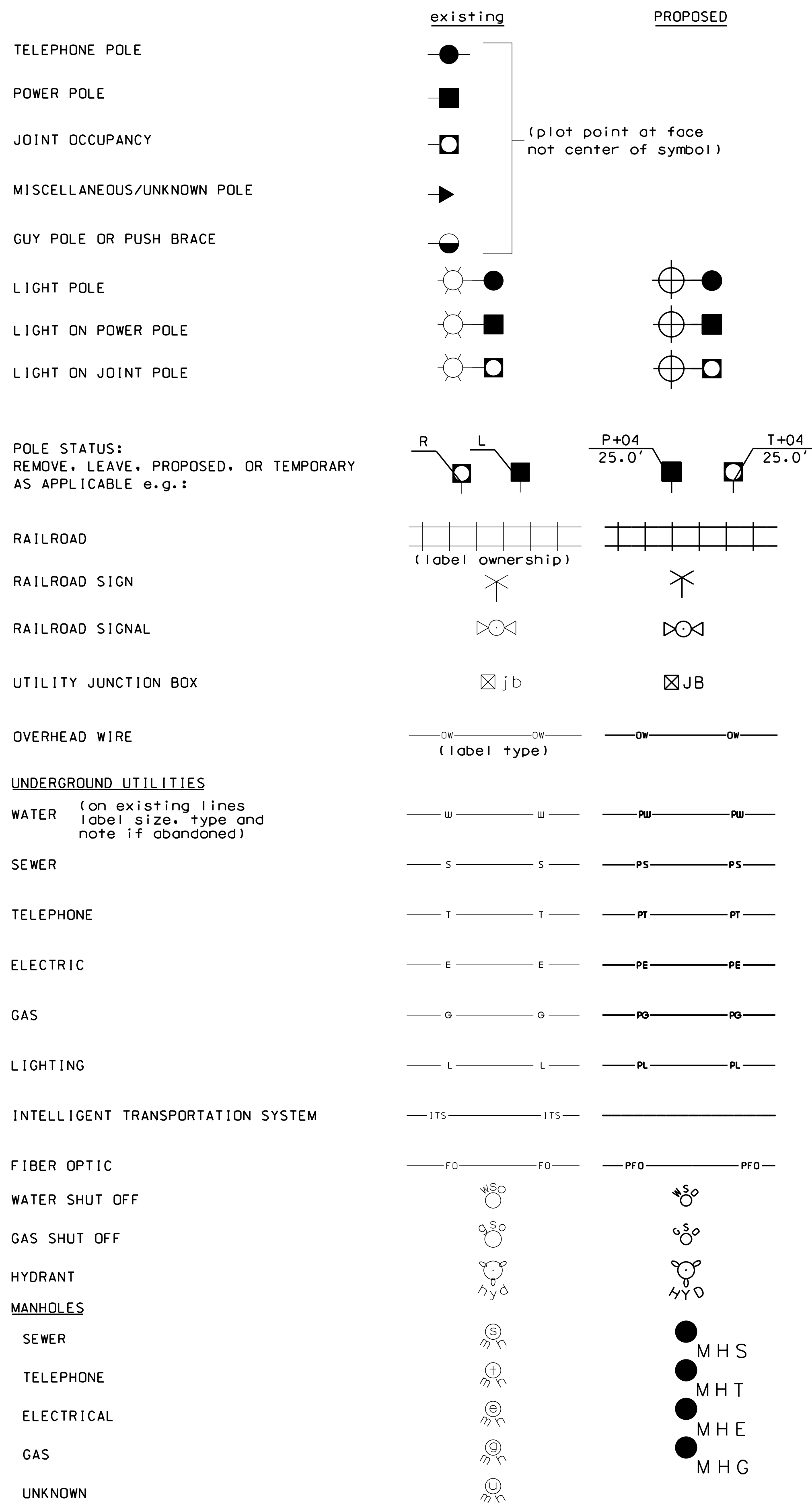

TRAFFIC SIGNALS / ITS

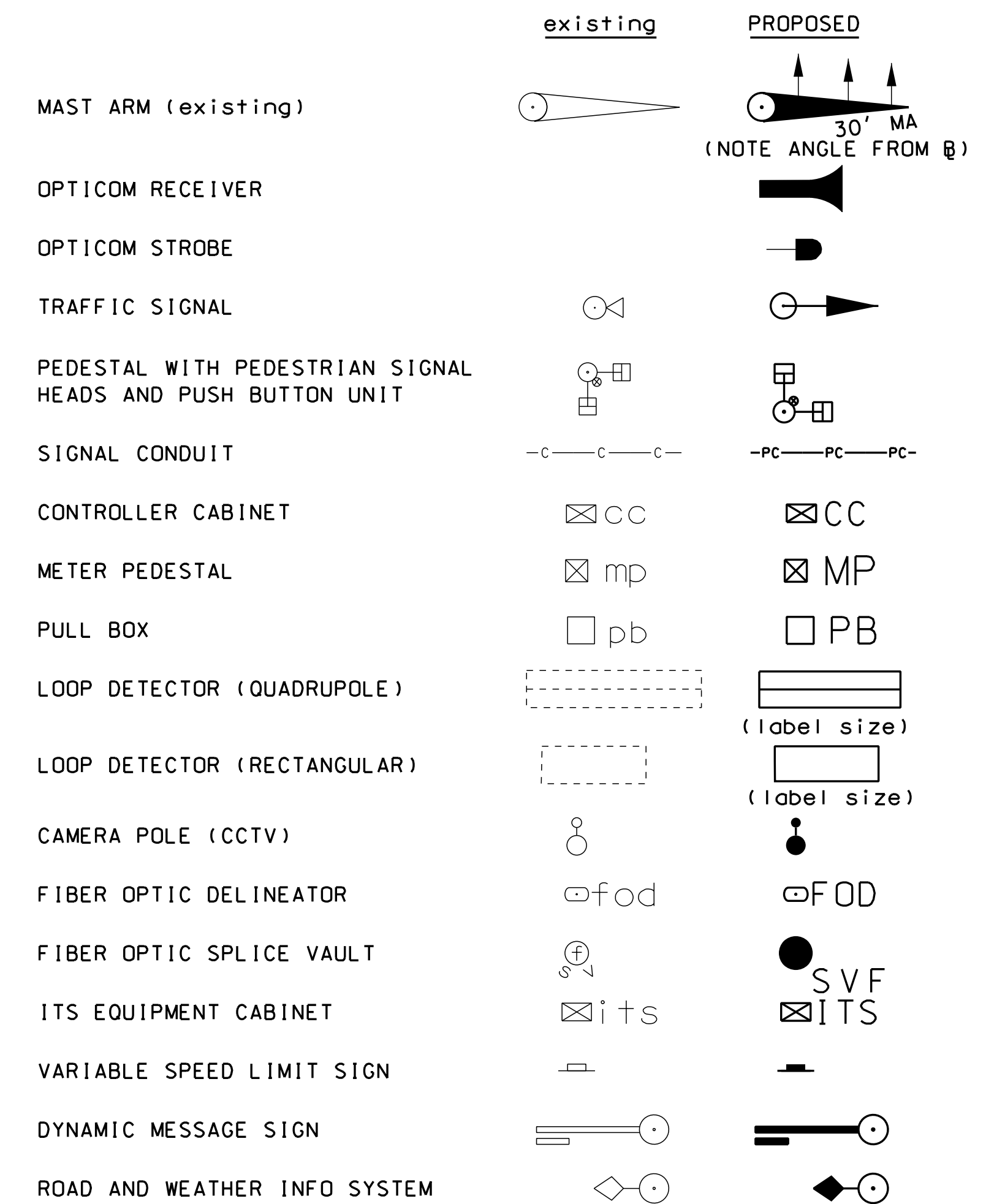

CONSTRUCTION NOTES

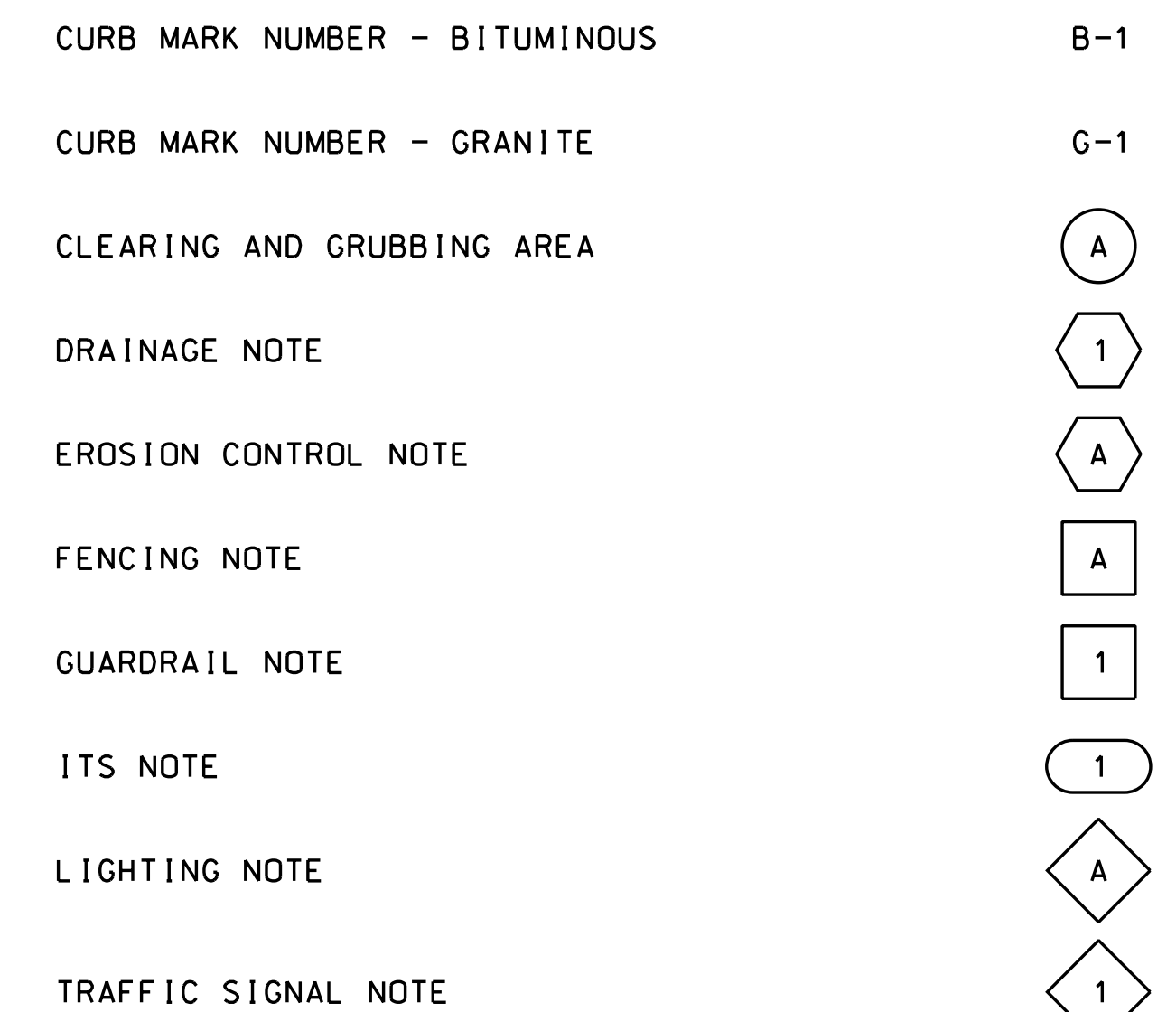

SHEET 2 OF 2

STATE OF NEW HAMPSHIRE				
DEPARTMENT OF TRANSPORTATION • BUREAU OF HIGHWAY DESIGN				
STANDARD SYMBOLS				

REVISION DATE	DGN	STATE PROJECT NO.	SHEET NO.	TOTAL SHEETS
9-1-2016	24579Symbol1_2	24579	3	8

REVISIONS AFTER PROPOSAL

DESCRIPTION

STATION

STATION

DATE

NUMBER

DATE
DATE
DATE
DATE

SDR PROCESSED
NEW DESIGN
SHEET CHECKED
AS BUILT DETAILS

WETLAND CLASSIFICATION CODES		
PFOIE	1	PALUSTRINE, FORESTED, BROAD-LEAVED DECIDUOUS, SEASONALLY FLOODED/SATURATED
PSSI/FOIE	2	PALUSTRINE, SCRUB-SHRUB, BROAD-LEAVED DECIDUOUS/FORESTED, BROAD LEAVED DECIDUOUS, SEASONALLY FLOODED/SATURATED
PSSIIE	3	PALUSTRINE, SCRUB-SHRUB, BROAD-LEAVED DECIDUOUS, SEASONALLY FLOODED/SATURATED
L2AB3/EM2H	4	LACUSTRINE, LITTORAL, AQUATIC BED, ROOTED VASCULAR/EMERGENT, NONPERSISTENT, PERMANENTLY FLOODED
L2AB3/4Hh	5	LACUSTRINE, LITTORAL, AQUATIC BED, ROOTED VASCULAR/FLOATING VASCULAR, PERMANENTLY FLOODED, DIKED/IMPOUNDED
LIUB2Hh	6	LACUSTRINE, LIMNETIC, UNCONSOLIDATED BOTTOM, SAND, PERMANENTLY FLOODED, DIKED/IMPOUNDED
PF01/4E	7	PALUSTRINE, FORESTED, BROAD-LEAVED DECIDUOUS, NEEDLE-LEAVED EVERGREEN, SEASONALLY FLOODED/SATURATED
PF04/1B	8	PAUSTRINE, FORESTED, NEEDLE-LEAVED EVERGREEN/BROAD-LEAVED DECIDUOUS, SATURATED
PEM2/AB3/4H	9	PALUSTRINE, EMERGENT, NONPERSISTENT/AQUATIC BED, ROOTED VASCULAR/FLOATING VASCULAR, PERMANENTLY FLOODED
PUB4/AB3/4H	10	PALUSTRINE, UNCONSOLIDATED BOTTOM, ORGANIC/AQUATIC BED ROOTED VASCULAR/FLOATING VASCULAR, PERMANENTLY FLOODED
PF01/4/SSIIE	11	PALUSTRINE, FORESTED, BROAD-LEAVED DECIDUOUS/NEEDLE-LEAVED EVERGREEN/SCRUB-SHRUB, BROAD-LEAVED DECIDUOUS, SEASONALLY FLOODED/SATURATED

LEGEND

TYPE OF WETLAND IMPACT	SHADING/HATCHING	SYMBOL	DESCRIPTION
NEW HAMPSHIRE WETLANDS BUREAU (PERMANENT NON-WETLAND)		#	WETLAND DESIGNATION NUMBER
NEW HAMPSHIRE WETLANDS BUREAU & ARMY CORP OF ENGINEERS (PERMANENT WETLAND)		#	WETLAND IMPACT LOCATION
TEMPORARY IMPACTS		#	WETLAND MITIGATION AREA
			MITIGATION

WETLAND IMPACT SUMMARY											
WETLAND NUMBER	WETLAND CLASSIFICATION	LOCATION	AREA IMPACTS						LINEAR STREAM IMPACTS FOR MITIGATION		
			PERMANENT				TEMPORARY		PERMANENT		
			N.H.W.B. (NON-WETLAND)		N.H.W.B. & A.C.O.E. (WETLAND)		SF	LF	BANK LEFT	BANK RIGHT	CHANNEL
			SF	LF	SF	LF	SF	LF	LF	LF	
2	PSSI/FOIE	A			105			79			
4	L2AB3/EM2H	B					441	10			
5	L2AB3/4Hh	C			53	8	145	20			
9	PEM2/AB3/4H	D					211	23			
10	PUB4/AB3/4H	E					507	14			
TOTAL			0 SF	0 LF	158 SF	8 LF	1383 SF	67 LF	0 LF	0 LF	

PERMANENT IMPACTS: 158 SF
 TEMPORARY IMPACTS: 1383 SF
 PRIME WETLAND BUFFER IMPACTS: 25,120 SF

TOTAL IMPACTS: 26,661 SF

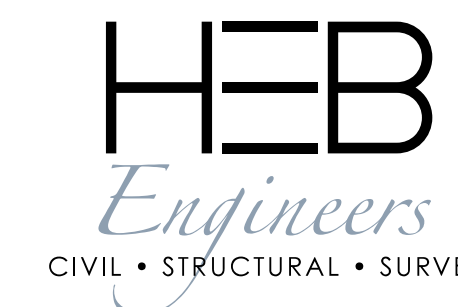

HEB Engineers, Inc.
 Post Office Box 440
 2605 White Mountain Hwy.
 North Conway, NH 03860
 www.hebengineers.com
 Office (603) 356-6936
 Fax (603) 356-7715

STATE OF NEW HAMPSHIRE				
DEPARTMENT OF TRANSPORTATION • BUREAU OF HIGHWAY DESIGN				
WETLAND IMPACT SUMMARY				
SHEET SCALE	DGN	STATE PROJECT NO.	SHEET NO.	TOTAL SHEETS
N/A	24579WetPlans	24579	4	8

REVISIONS AFTER PROPOSAL		STATION	DESCRIPTION
NUMBER	DATE	STATION	DESCRIPTION

SDR PROCESSED	NHDDOT	DATE
NEW DESIGN	EVS	DATE 6/18/2020
SHEET CHECKED	CRF	DATE 6/18/2020
AS BUILT DETAILS		DATE

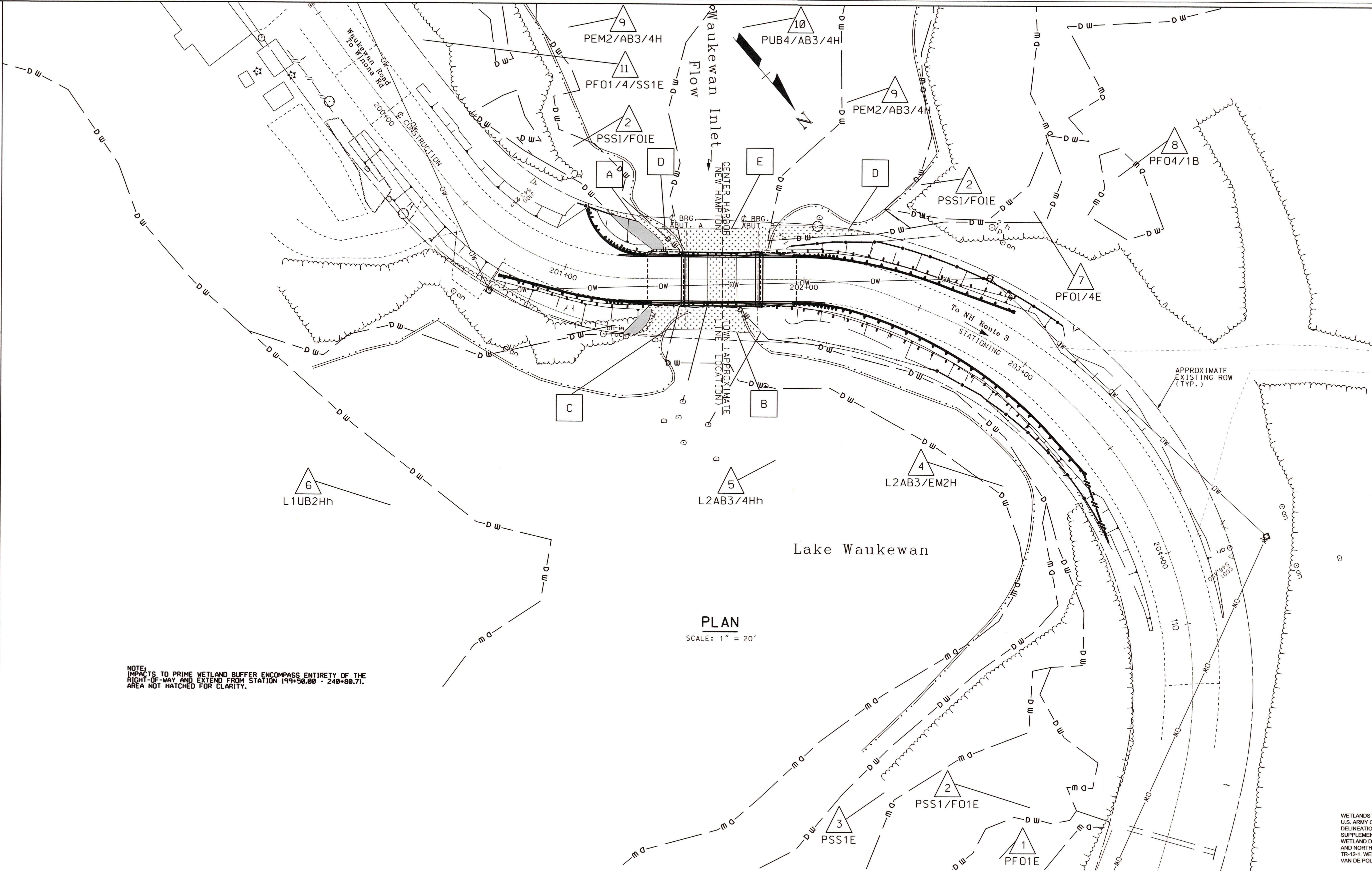

PLAN
SCALE: 1" = 20'

NOTE:
IMPACTS TO PRIME WETLAND BUFFER ENCOMPASS ENTIRETY OF THE
RIGHT-OF-WAY AND EXTEND FROM STATION 199+50.00 - 240+80.71.
AREA NOT HATCHED FOR CLARITY.

WETLANDS WERE DELINEATED ACCORDING TO THE
U.S. ARMY CORPS OF ENGINEERS WETLANDS
DELINEATION MANUAL (Y-1-87) AND THE REGIONAL
SUPPLEMENT TO THE CORPS OF ENGINEERS
WETLAND DELINEATION MANUAL: NORTHCENTRAL
AND NORTHEAST REGION (VERSION 2.0), ERDC/EL
TR-12-1. WETLANDS DELINEATED IN FIELD BY RICK
VAN DE POLL, CWS#110.

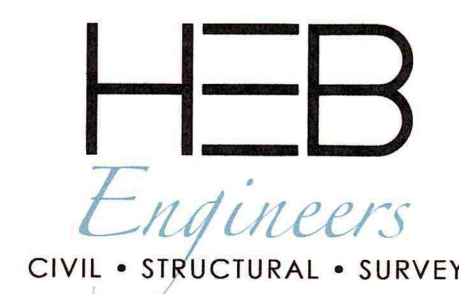
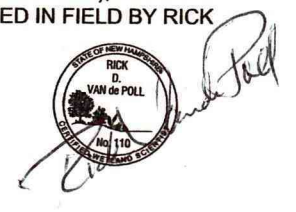

HEB Engineers, Inc.
Post Office Box 440
2605 White Mountain Hwy.
North Conway, NH 03860
www.hebengineers.com
Office (603) 356-6936
Fax (603) 356-7715

STATE OF NEW HAMPSHIRE
DEPARTMENT OF TRANSPORTATION • BUREAU OF HIGHWAY DESIGN

WETLAND IMPACT PLAN

SHEET SCALE	DGN	STATE PROJECT NO.	SHEET NO.	TOTAL SHEETS
1" = 20'	24579WetPlans	24579	5	8

EROSION CONTROL STRATEGIES

1. ENVIRONMENTAL COMMITMENTS:
 - 1.1. THESE GUIDELINES DO NOT RELIEVE THE CONTRACTOR FROM COMPLIANCE WITH ANY CONTRACT PROVISIONS, OR APPLICABLE FEDERAL, STATE, AND LOCAL REGULATIONS.
 - 1.2. THIS PROJECT WILL BE SUBJECT TO THE US EPA'S NATIONAL POLLUTANT DISCHARGE ELIMINATION SYSTEM (NPDES) STORM WATER CONSTRUCTION GENERAL PERMIT AS ADMINISTERED BY THE ENVIRONMENTAL PROTECTION AGENCY (EPA). THIS PROJECT IS SUBJECT TO REQUIREMENTS IN THE MOST RECENT CONSTRUCTION GENERAL PERMIT (CGP).
 - 1.3. THE CONTRACTOR'S ATTENTION IS DIRECTED TO THE NHDES WETLAND PERMIT, THE US ARMY CORPS OF ENGINEERS PERMIT, WATER QUALITY CERTIFICATION AND THE SPECIAL ATTENTION ITEMS INCLUDED IN THE CONTRACT DOCUMENTS.
 - 1.4. ALL STORM WATER, EROSION AND SEDIMENT CONTROL MEASURES SHALL BE INSTALLED AND MAINTAINED IN ACCORDANCE WITH THE NEW HAMPSHIRE STORMWATER MANUAL, VOLUME 3, EROSION AND SEDIMENT CONTROLS DURING CONSTRUCTION (DECEMBER 2008) (BMP MANUAL) AVAILABLE FROM THE NEW HAMPSHIRE DEPARTMENT OF ENVIRONMENTAL SERVICES (NHDES).
 - 1.5. THE CONTRACTOR SHALL COMPLY WITH RSA 485-A:17, AND ALL, PUBLISHED NHDES ALTERATION OF TERRAIN ENV-WO 1500 REQUIREMENTS ([HTTP://DES.NH.GOV/ORGANIZATION/COMMISSIONER/LEGAL/RULES/INDEX.HTM](http://des.nh.gov/organization/commissioner/legal/rules/index.htm))
 - 1.6. THE CONTRACTOR IS DIRECTED TO REVIEW AND COMPLY WITH SECTION 107.1 OF THE CONTRACT AS IT REFERS TO SPILLAGE, AND ALSO WITH REGARDS TO EROSION, POLLUTION, AND TURBIDITY PRECAUTIONS.
2. STANDARD EROSION CONTROL SEQUENCING APPLICABLE TO ALL CONSTRUCTION PROJECTS:
 - 2.1. PERIMETER CONTROLS SHALL BE INSTALLED PRIOR TO EARTH DISTURBING ACTIVITIES. PERIMETER CONTROLS AND STABILIZED CONSTRUCTION EXITS SHALL BE INSTALLED AS SHOWN IN THE BMP MANUAL AND AS DIRECTED BY THE STORMWATER POLLUTION PREVENTION PLAN (SWPPP) PREPARER.
 - 2.2. EROSION, SEDIMENTATION CONTROL MEASURES AND INFILTRATION BASINS SHALL BE CLEANED, REPLACED AND AUGMENTED AS NECESSARY TO PREVENT SEDIMENTATION BEYOND PROJECT LIMITS THROUGHOUT THE PROJECT DURATION.
 - 2.3. EROSION AND SEDIMENT CONTROL MEASURES SHALL BE INSPECTED IN ACCORDANCE WITH THE CONSTRUCTION GENERAL PERMIT AND SECTION 645 OF THE NHDOT SPECIFICATIONS FOR ROAD AND BRIDGES CONSTRUCTION.
 - 2.4. AN AREA SHALL BE CONSIDERED STABLE IF ONE OF THE FOLLOWING HAS OCCURRED:
 - (A) BASE COURSE GRAVELS HAVE BEEN INSTALLED IN AREAS TO BE PAVED;
 - (B) A MINIMUM OF 85% VEGETATED GROWTH HAS BEEN ESTABLISHED;
 - (C) A MINIMUM OF 3" OF NON-EROSIVE MATERIAL SUCH AS STONE OR RIP-RAP HAS BEEN INSTALLED;
 - (D) TEMPORARY SLOPE STABILIZATION CONFORMING TO TABLE 1 HAS BEEN PROPERLY INSTALLED
 - 2.5. ALL STOCKPILES SHALL BE CONTAINED WITH A PERIMETER CONTROL. IF THE STOCKPILE IS TO REMAIN UNDISTURBED FOR MORE THAN 14 DAYS, MULCHING WILL BE REQUIRED.
 - 2.6. A WATER TRUCK SHALL BE AVAILABLE TO CONTROL EXCESSIVE DUST AT THE DIRECTION OF THE CONTRACT ADMINISTRATOR.
 - 2.7. TEMPORARY EROSION AND SEDIMENTATION CONTROL MEASURES SHALL REMAIN UNTIL THE AREA HAS BEEN PERMANENTLY STABILIZED.
 - 2.8. CONSTRUCTION PERFORMED ANY TIME BETWEEN NOVEMBER 30th AND MAY 1st OF ANY YEAR SHALL BE CONSIDERED WINTER CONSTRUCTION AND SHALL CONFORM TO THE FOLLOWING REQUIREMENTS.
 - (A) ALL PROPOSED VEGETATED AREAS WHICH DO NOT EXHIBIT A MINIMUM OF 85% VEGETATIVE GROWTH BY OCTOBER 15th, OR WHICH ARE DISTURBED AFTER OCTOBER 15th, SHALL BE STABILIZED IN ACCORDANCE WITH TABLE 1.
 - (B) ALL DITCHES OR SWALES WHICH DO NOT EXHIBIT A MINIMUM OF 85% VEGETATIVE GROWTH BY OCTOBER 15th, OR WHICH ARE DISTURBED AFTER OCTOBER 15th, SHALL BE STABILIZED TEMPORARILY WITH STONE OR IN ACCORDANCE WITH TABLE 1.
 - (C) AFTER NOVEMBER 30th INCOMPLETE ROAD SURFACES, WHERE WORK HAS STOPPED FOR THE SEASON, SHALL BE PROTECTED IN ACCORDANCE WITH TABLE 1.
 - (D) WINTER EXCAVATION AND EARTHWORK SHALL BE DONE SUCH THAT NO MORE THAN 1 ACRE OF THE PROJECT IS WITHOUT STABILIZATION AT ONE TIME, UNLESS A WINTER CONSTRUCTION PLAN HAS BEEN APPROVED BY NHDOT THAT MEETS THE REQUIREMENTS OF ENV-WO 1505.02 AND ENV-WO 1505.05.
 - (E) A SWPPP AMENDMENT SHALL BE SUBMITTED TO THE DEPARTMENT, FOR APPROVAL, ADDRESSING COLD WEATHER STABILIZATION (ENV-WO 1505.05) AND INCLUDING THE REQUIREMENTS OF NO LESS THAN 30 DAYS PRIOR TO THE COMMENCEMENT OF WORK SCHEDULED AFTER NOVEMBER 30th.

GENERAL CONSTRUCTION PLANNING AND SELECTION OF STRATEGIES TO CONTROL EROSION AND SEDIMENT ON HIGHWAY CONSTRUCTION PROJECTS

3. PLAN ACTIVITIES TO ACCOUNT FOR SENSITIVE SITE CONDITIONS:
 - 3.1. CLEARLY FLAG AREAS TO BE PROTECTED IN THE FIELD AND PROVIDE CONSTRUCTION BARRIERS TO PREVENT TRAFFICKING OUTSIDE OF WORK AREAS.
 - 3.2. CONSTRUCTION SHALL BE SEQUENCED TO LIMIT THE DURATION AND AREA OF EXPOSED SOILS.
 - 3.3. PROTECT AND MAXIMIZE EXISTING NATIVE VEGETATION AND NATURAL FOREST BUFFERS BETWEEN CONSTRUCTION ACTIVITY AND SENSITIVE AREAS.
 - 3.4. WHEN WORK IS PERFORMED IN AND NEAR WATER COURSES, STREAM FLOW DIVERSION METHODS SHALL BE IMPLEMENTED PRIOR TO ANY EXCAVATION OR FILLING.
 - 3.5. WHEN WORK IS PERFORMED WITHIN 50 FEET OF SURFACE WATERS (WETLAND, OPEN WATER OR FLOWING WATER), PERIMETER CONTROL SHALL BE ENHANCED CONSISTENT WITH SECTION 2.1.2.1. OF THE 2012 NPDES CONSTRUCTION GENERAL PERMIT.
4. MINIMIZE THE AMOUNT OF EXPOSED SOIL:
 - 4.1. CONSTRUCTION SHALL BE SEQUENCED TO LIMIT THE DURATION AND AREA OF EXPOSED SOILS. MINIMIZE THE AREA OF EXPOSED SOIL AT ANY ONE TIME. PHASING SHALL BE USED TO REDUCE THE AMOUNT AND DURATION OF SOIL EXPOSED TO THE ELEMENTS AND VEHICLE TRACKING.
 - 4.2. UTILIZE TEMPORARY MULCHING OR PROVIDE ALTERNATE TEMPORARY STABILIZATION ON EXPOSED SOILS IN ACCORDANCE WITH TABLE 1.
 - 4.3. THE MAXIMUM AMOUNT OF DISTURBED EARTH SHALL NOT EXCEED A TOTAL OF 5 ACRES FROM MAY 1st THROUGH NOVEMBER 30th, OR EXCEED ONE ACRE DURING WINTER MONTHS, UNLESS THE CONTRACTOR DEMONSTRATES TO THE DEPARTMENT THAT THE ADDITIONAL AREA OF DISTURBANCE IS NECESSARY TO MEET THE CONTRACTORS CRITICAL PATH METHOD SCHEDULE (CPM), AND THE CONTRACTOR HAS ADEQUATE RESOURCES AVAILABLE TO ENSURE THAT ENVIRONMENTAL COMMITMENTS WILL BE MET.
5. CONTROL STORMWATER FLOWING ONTO AND THROUGH THE PROJECT:
 - 5.1. DIVERT OFF SITE RUNOFF OR CLEAN WATER AWAY FROM THE CONSTRUCTION ACTIVITY TO REDUCE THE VOLUME THAT NEEDS TO BE TREATED ON SITE.
 - 5.2. DIVERT STORM RUNOFF FROM UPSLOPE DRAINAGE AREAS AWAY FROM DISTURBED AREAS, SLOPES, AND AROUND ACTIVE WORK AREAS AND TO A STABILIZED OUTLET LOCATION.
 - 5.3. CONSTRUCT IMPERMEABLE BARRIERS AS NECESSARY TO COLLECT OR DIVERT CONCENTRATED FLOWS FROM WORK OR DISTURBED AREAS.
 - 5.4. STABILIZE, TO APPROPRIATE ANTICIPATED VELOCITIES, CONVEYANCE CHANNELS OR PUMPING SYSTEMS NEEDED TO CONVEY CONSTRUCTION STORMWATER TO BASINS AND DISCHARGE LOCATIONS PRIOR TO USE.
 - 5.5. DIVERT OFF-SITE WATER THROUGH THE PROJECT IN AN APPROPRIATE MANNER SO NOT TO DISTURB THE UPSTREAM OR DOWNSTREAM SOILS, VEGETATION OR HYDROLOGY BEYOND THE PERMITTED AREA.
6. PROTECT SLOPES:
 - 6.1. INTERCEPT AND DIVERT STORM RUNOFF FROM UPSLOPE DRAINAGE AREAS AWAY FROM UNPROTECTED AND NEWLY ESTABLISHED AREAS AND SLOPES TO A STABILIZED OUTLET OR CONVEYANCE.
 - 6.2. CONSIDER HOW GROUNDWATER SEEPAGE ON CUT SLOPES MAY IMPACT SLOPE STABILITY AND INCORPORATE APPROPRIATE MEASURES TO MINIMIZE EROSION.
 - 6.3. CONVEY STORMWATER DOWN THE SLOPE IN A STABILIZED CHANNEL OR SLOPE DRAIN.
 - 6.4. THE OUTER FACE OF THE FILL SLOPE SHOULD BE IN A LOOSE RUFFLED CONDITION PRIOR TO TURF ESTABLISHMENT. TOPSOIL OR HUMUS LAYERS SHALL BE TRACKED UP AND DOWN THE SLOPE, DISKED, HARROWED, DRAGGED WITH A CHAIN OR MAT, MACHINE-RAKED, OR HAND-WORKED TO PRODUCE A RUFFLED SURFACE.
7. ESTABLISH STABILIZED CONSTRUCTION EXITS:
 - 7.1. INSTALL AND MAINTAIN CONSTRUCTION EXITS, ANYWHERE TRAFFIC LEAVES A CONSTRUCTION SITE ONTO A PUBLIC RIGHT-OF-WAY.
 - 7.2. SWEEP ALL CONSTRUCTION RELATED DEBRIS AND SOIL FROM THE ADJACENT PAVED ROADWAYS AS NECESSARY.
8. PROTECT STORM DRAIN INLETS:
 - 8.1. DIVERT SEDIMENT LADEN WATER AWAY FROM INLET STRUCTURES TO THE EXTENT POSSIBLE.
 - 8.2. INSTALL SEDIMENT BARRIERS AND SEDIMENT TRAPS AT INLETS TO PREVENT SEDIMENT FROM ENTERING THE DRAINAGE SYSTEM.
 - 8.3. CLEAN CATCH BASINS, DRAINAGE PIPES, AND CULVERTS IF SIGNIFICANT SEDIMENT IS DEPOSITED.
 - 8.4. DROP INLET SEDIMENT BARRIERS SHOULD NEVER BE USED AS THE PRIMARY MEANS OF SEDIMENT CONTROL AND SHOULD ONLY BE USED TO PROVIDE AN ADDITIONAL LEVEL OF PROTECTION TO STRUCTURES AND DOWN-GRADIENT SENSITIVE RECEPTORS.
9. SOIL STABILIZATION:
 - 9.1. WITHIN THREE DAYS OF THE LAST ACTIVITY IN AN AREA, ALL EXPOSED SOIL AREAS, WHERE CONSTRUCTION ACTIVITIES ARE COMPLETE, SHALL BE STABILIZED.
 - 9.2. IN ALL AREAS, TEMPORARY SOIL STABILIZATION MEASURES SHALL BE APPLIED IN ACCORDANCE WITH THE STABILIZATION REQUIREMENTS (SECTION 2.2) OF THE 2012 CGP. (SEE TABLE 1 FOR GUIDANCE ON THE SELECTION OF TEMPORARY SOIL STABILIZATION MEASURES.)
 - 9.3. EROSION CONTROL SEED MIX SHALL BE SOWN IN ALL INACTIVE CONSTRUCTION AREAS THAT WILL NOT BE PERMANENTLY SEEDED WITHIN TWO WEEKS OF DISTURBANCE AND PRIOR TO SEPTEMBER 15, OF ANY GIVEN YEAR. IN ORDER TO ACHIEVE VEGETATIVE STABILIZATION PRIOR TO THE END OF THE GROWING SEASON.
 - 9.4. SOIL TACKIFIERS MAY BE APPLIED IN ACCORDANCE WITH THE MANUFACTURER'S SPECIFICATIONS AND REAPPLIED AS NECESSARY TO MINIMIZE SOIL AND MULCH LOSS UNTIL PERMANENT VEGETATION IS ESTABLISHED.
10. RETAIN SEDIMENT ON-SITE AND CONTROL DEWATERING PRACTICES:
 - 10.1. TEMPORARY SEDIMENT BASINS (CGP-SECTION 2.1.3.2) OR SEDIMENT TRAPS (ENV-WO 1506.10) SHALL BE SIZED TO RETAIN, ON SITE, THE VOLUME OF A 2-YEAR 24-HOUR STORM EVENT FOR ANY AREA OF DISTURBANCE OR 3,600 CUBIC FEET OF STORMWATER RUNOFF PER ACRE OF DISTURBANCE, WHICHEVER IS GREATER. TEMPORARY SEDIMENT BASINS USED TO TREAT STORMWATER RUNOFF FROM AREAS GREATER THAN 5-ACRES OF DISTURBANCE SHALL BE SIZED TO ALSO CONTROL STORMWATER RUNOFF FROM A 10-YEAR 24 HOUR STORM EVENT. ON-SITE RETENTION OF THE 10-YEAR 24-HOUR EVENT IS NOT REQUIRED.
 - 10.2. CONSTRUCT AND STABILIZE DEWATERING INFILTRATION BASINS PRIOR TO ANY EXCAVATION THAT MAY REQUIRE DEWATERING.
 - 10.3. TEMPORARY SEDIMENT BASINS OR TRAPS SHALL BE PLACED AND STABILIZED AT LOCATIONS WHERE CONCENTRATED FLOW (CHANNELS AND PIPES) DISCHARGE TO THE SURROUNDING ENVIRONMENT FROM AREAS OF UNSTABILIZED EARTH DISTURBING ACTIVITIES.

11. ADDITIONAL EROSION AND SEDIMENT CONTROL GENERAL PRACTICES:
 - 11.1. USE TEMPORARY MULCHING, PERMANENT MULCHING, TEMPORARY VEGETATIVE COVER, AND PERMANENT VEGETATIVE COVER TO REDUCE THE NEED FOR DUST CONTROL. USE MECHANICAL SWEEPERS ON PAVED SURFACES WHERE NECESSARY TO PREVENT DUST BUILDUP. APPLY WATER, OR OTHER DUST INHIBITING AGENTS OR TACKIFIERS, AS APPROVED BY THE NHDES.
 - 11.2. ALL STOCKPILES SHALL BE CONTAINED WITH TEMPORARY PERIMETER CONTROLS. INACTIVE SOIL STOCKPILES SHOULD BE PROTECTED WITH SOIL STABILIZATION MEASURES (TEMPORARY EROSION CONTROL SEED MIX AND MULCH, SOIL BINDER) OR COVERED WITH ANCHORED TARPS.
 - 11.3. EROSION AND SEDIMENT CONTROL MEASURES WILL BE INSPECTED IN ACCORDANCE WITH SECTION 645 OF NHDOT SPECIFICATIONS. WEEKLY AND WITHIN 24 HOURS AFTER ANY STORM EVENT GREATER THAN 0.25 IN. OF RAIN PER 24-HOUR PERIOD. EROSION AND SEDIMENT CONTROL MEASURES WILL ALSO BE INSPECTED IN ACCORDANCE WITH THE GUIDANCE MEMO FROM THE NHDES CONTAINED WITHIN THE CONTRACT PROPOSAL AND THE EPA CONSTRUCTION GENERAL PERMIT.
 - 11.4. THE CONTRACTOR SHOULD UTILIZE STORM DRAIN INLET PROTECTION TO PREVENT SEDIMENT FROM ENTERING A STORM DRAINAGE SYSTEM PRIOR TO THE PERMANENT STABILIZATION OF THE CONTRIBUTING DISTURBED AREA.
 - 11.5. PERMANENT STABILIZATION MEASURES WILL BE CONSTRUCTED AND MAINTAINED IN LOCATIONS AS SHOWN ON THE CONSTRUCTION PLANS TO STABILIZE AREAS. VEGETATIVE STABILIZATION SHALL NOT BE CONSIDERED PERMANENTLY STABILIZED UNTIL VEGETATIVE GROWTH COVERS AT LEAST 85% OF THE DISTURBED AREA. THE CONTRACTOR SHALL BE RESPONSIBLE FOR EROSION AND SEDIMENT CONTROL FOR ONE YEAR AFTER PROJECT COMPLETION.
 - 11.6. CATCH BASINS: CARE SHALL BE TAKEN TO ENSURE THAT SEDIMENTS DO NOT ENTER ANY EXISTING CATCH BASINS DURING CONSTRUCTION. THE CONTRACTOR SHALL PLACE TEMPORARY STONE INLET PROTECTION OVER INLETS IN AREAS OF SOIL DISTURBANCE THAT ARE SUBJECT TO SEDIMENT CONTAMINATION.
 - 11.7. TEMPORARY AND PERMANENT DITCHES SHALL BE CONSTRUCTED, STABILIZED AND MAINTAINED IN A MANNER THAT WILL MINIMIZE SCOUR. TEMPORARY AND PERMANENT DITCHES SHALL BE DIRECTED TO DRAIN TO SEDIMENT BASINS OR STORM WATER COLLECTION AREAS.
 - 11.8. WINTER EXCAVATION AND EARTHWORK ACTIVITIES NEED TO BE LIMITED IN EXTENT AND DURATION, TO MINIMIZE POTENTIAL EROSION AND SEDIMENTATION IMPACTS. THE AREA OF EXPOSED SOIL SHALL BE LIMITED TO ONE ACRE, OR THAT WHICH CAN BE STABILIZED AT THE END OF EACH DAY UNLESS A WINTER CONSTRUCTION PLAN, DEVELOPED BY A QUALIFIED ENGINEER OR A CPESC SPECIALIST, IS REVIEWED AND APPROVED BY THE DEPARTMENT.
 - 11.9. CHANNEL PROTECTION MEASURES SHALL BE SUPPLEMENTED WITH PERIMETER CONTROL MEASURES WHEN THE DITCH LINES OCCUR AT THE BOTTOM OF LONG FILL SLOPES. THE PERIMETER CONTROLS SHALL BE INSTALLED ON THE FILL SLOPE TO MINIMIZE THE POTENTIAL FOR FILL SLOPE SEDIMENT DEPOSITS IN THE DITCH LINE.

BEST MANAGEMENT PRACTICES (BMP) BASED ON AMOUNT OF OPEN CONSTRUCTION AREA

12. STRATEGIES SPECIFIC TO OPEN AREAS LESS THAN 5 ACRES:
 - 12.1. THE CONTRACTOR SHALL COMPLY WITH RSA 485:A:17 AND ENV-WO 1500; ALTERATION OF TERRAIN FOR CONSTRUCTION AND USE ALL CONVENTIONAL BMP STRATEGIES.
 - 12.2. SLOPES STEEPER THAN 3:1 WILL RECEIVE TURF ESTABLISHMENT WITH MATTING.
 - 12.3. SLOPES 3:1 OR FLATTER WILL RECEIVE TURF ESTABLISHMENT ALONE.
 - 12.4. AREAS WHERE HAUL ROADS ARE CONSTRUCTED AND STORMWATER CANNOT BE TREATED THE DEPARTMENT WILL CONSIDER INFILTRATION.
 - 12.5. FOR HAUL ROADS ADJACENT TO SENSITIVE ENVIRONMENTAL AREAS OR STEEPER THAN 5%, THE DEPARTMENT WILL CONSIDER USING EROSION STONE, CRUSHED GRAVEL, OR CRUSHED STONE BASE TO HELP MINIMIZE EROSION ISSUES.
 - 12.6. ALL AREAS THAT CAN BE STABILIZED SHALL BE STABILIZED PRIOR TO OPENING UP NEW TERRITORY.
 - 12.7. DETENTION BASINS SHALL BE DESIGNED AND CONSTRUCTED TO ACCOMMODATE A 2 YEAR STORM EVENT.
13. STRATEGIES SPECIFIC TO OPEN AREAS BETWEEN 5 AND 10 ACRES:
 - 13.1. THE CONTRACTOR SHALL COMPLY WITH RSA 485:A:17 AND ENV-WO 1500 ALTERATION OF TERRAIN AND SHALL USE CONVENTIONAL BMP STRATEGIES AND ALL TREATMENT OPTIONS USED FOR UNDER 5 ACRES WILL BE UTILIZED.
 - 13.2. DETENTION BASINS WILL BE CONSTRUCTED TO ACCOMMODATE THE 2-YEAR 24-HOUR STORM EVENT AND CONTROL A 10-YEAR 24-HOUR STORM EVENT.
 - 13.3. SLOPES STEEPER THAN A 3:1 WILL RECEIVE TURF ESTABLISHMENT WITH MATTING OR OTHER TEMPORARY SOIL STABILIZATION MEASURES DETAILED IN TABLE 1. THE CONTRACTOR MAY ALSO CONSIDER A SOIL BINDER IN ACCORDANCE WITH THE NHDES APPROVALS OR REGULATIONS. OTHER ALTERNATIVE MEASURES, SUCH AS BONDED FIBER MATRIXES (BFMS) OR FLEXIBLE GROWTH MEDIUMS (FGMS) MAY BE UTILIZED, IF MEETING THE NHDES APPROVALS AND REGULATIONS.
 - 13.4. SLOPES 3:1 OR FLATTER WILL RECEIVE TURF ESTABLISHMENT OR OTHER TEMPORARY SOIL STABILIZATION MEASURES DETAILED IN TABLE 1. THE CONTRACTOR MAY ALSO CONSIDER A SOIL BINDER IN ACCORDANCE WITH THE NHDES APPROVALS OR REGULATIONS.
14. STRATEGIES SPECIFIC TO OPEN AREAS OVER 10 ACRES:
 - 14.1. THE CONTRACTOR SHALL COMPLY WITH RSA 485:A:17 AND ENV-WO 1500 ALTERATION OF TERRAIN AND SHALL USE CONVENTIONAL BMP STRATEGIES AND ALL TREATMENT OPTIONS USED FOR UNDER 5 ACRES AND BETWEEN 5 AND 10 ACRES WILL BE UTILIZED.
 - 14.2. THE DEPARTMENT ANTICIPATES THAT SOIL BINDERS WILL BE NEEDED ON ALL SLOPES STEEPER THAN 3:1, IN ORDER TO MINIMIZE EROSION AND REDUCE THE AMOUNT OF SEDIMENT IN THE STORMWATER TREATMENT BASINS.
 - 14.3. THE CONTRACTOR WILL BE REQUIRED TO HAVE AN APPROVED DESIGN IN ACCORDANCE WITH ENV-WO 1506.12 FOR AN ACTIVE FLOCCULANT TREATMENT SYSTEM TO TREAT AND RELEASE WATER CAPTURED IN STORM WATER BASINS. THE CONTRACTOR SHALL ALSO RETAIN THE SERVICES OF AN ENVIRONMENTAL CONSULTANT WHO HAS DEMONSTRATED EXPERIENCE IN THE DESIGN OF FLOCCULANT TREATMENT SYSTEMS. THE CONSULTANT WILL ALSO BE RESPONSIBLE FOR THE IMPLEMENTATION AND MONITORING OF THE SYSTEM.

TABLE 1
GUIDANCE ON SELECTING TEMPORARY SOIL STABILIZATION MEASURES

APPLICATION AREAS	DRY MULCH METHODS				HYDRAULICALLY APPLIED MULCHES ²				ROLLED EROSION CONTROL BLANKETS ³			
	HMT	WC	SG	CB	HM	SMM	BFM	FRM	SNSB	DNSB	DNCSB	DNCB
SLOPES ¹												
STEEPER THAN 2:1	NO	NO	YES	NO	NO	NO	NO	YES	NO	NO	NO	YES
2:1 SLOPE	YES ¹	YES ¹	YES	YES	NO	NO	YES	YES	NO	YES	YES	YES
3:1 SLOPE	YES	YES	YES	YES	NO	YES	YES	YES	YES	YES	YES	NO
4:1 SLOPE	YES	YES	YES	YES	YES	YES	YES	YES	YES	YES	NO	NO
WINTER STABILIZATION	4T/AC	YES	YES	YES	NO	NO	YES	YES	YES	YES	YES	YES
CHANNELS												
LOW FLOW CHANNELS	NO	NO	NO	NO	NO	NO	NO	NO	NO	NO	YES	YES
HIGH FLOW CHANNELS	NO	NO	NO	NO	NO	NO	NO	NO	NO	NO	NO	YES

ABBREV.	STABILIZATION MEASURE	ABBREV.	STABILIZATION MEASURE	ABBREV.	STABILIZATION MEASURE
HMT	HAY MULCH & TACK	HM	HYDRAULIC MULCH	SNSB	SINGLE NET STRAW BLANKET
WC	WOOD CHIPS	SMM	STABILIZED MULCH MATRIX	DNSB	DOUBLE NET STRAW BLANKET
SG	STUMP GRINDINGS	BFM	BONDED FIBER MATRIX	DNCSB	2 NET STRAW-COCONUT BLANKET
CB	COMPOST BLANKET	FRM	FIBER REINFORCED MEDIUM	DNCB	2 NET COCONUT BLANKET

- NOTES:
1. ALL SLOPE STABILIZATION OPTIONS ASSUME A SLOPE LENGTH ≤ 10 TIMES THE HORIZONTAL DISTANCE COMPONENT OF THE SLOPE, IN FEET.
 2. PRODUCTS CONTAINING POLYACRYLAMIDE (PAM) SHALL NOT BE APPLIED DIRECTLY TO OR WITHIN 100 FEET OF ANY SURFACE WATER WITHOUT PRIOR WRITTEN APPROVAL FROM THE NH DEPARTMENT OF ENVIRONMENTAL SERVICES.
 3. ALL EROSION CONTROL BLANKETS SHALL BE MADE WITH WILDLIFE FRIENDLY BIODEGRADABLE NETTING.

STATE OF NEW HAMPSHIRE				
DEPARTMENT OF TRANSPORTATION • BUREAU OF HIGHWAY DESIGN				
<i>WETLAND IMPACT PLANS</i>				
REVISION DATE	DGN	STATE PROJECT NO.	SHEET NO.	TOTAL SHEETS
12-21-2015	erosstrat	24579	6	8

SDR PROCESSED	NHDOT	DATE	10/20/2020
NEW DESIGN	EVS	DATE	10/20/2020
SHEET CHECKED	CRF	DATE	10/20/2020
AS BUILT DETAILS		DATE	

REVISIONS AFTER PROPOSAL	STATION	DATE	DESCRIPTION

EROSION CONTROL PLAN LEGEND

- NATURAL BUFFER / PERIMETER CONTROL**
 SILT FENCE
 EROSION CONTROL MIX BERM
 EROSION CONTROL MIX SOX
 TURBIDITY CURTAIN
 SHEET PILE
 COFFER DAM
- PERIMETER CONTROL**
 SILT FENCE
 EROSION CONTROL MIX BERM
 EROSION CONTROL MIX SOX
 TURBIDITY CURTAIN
 SHEET PILE
 COFFER DAM
- CLEAN WATER BYPASS**
 PUMP THROUGH PIPE
 DRAIN THROUGH PIPE OR CHANNEL

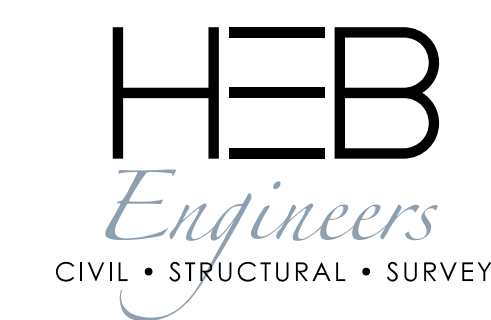
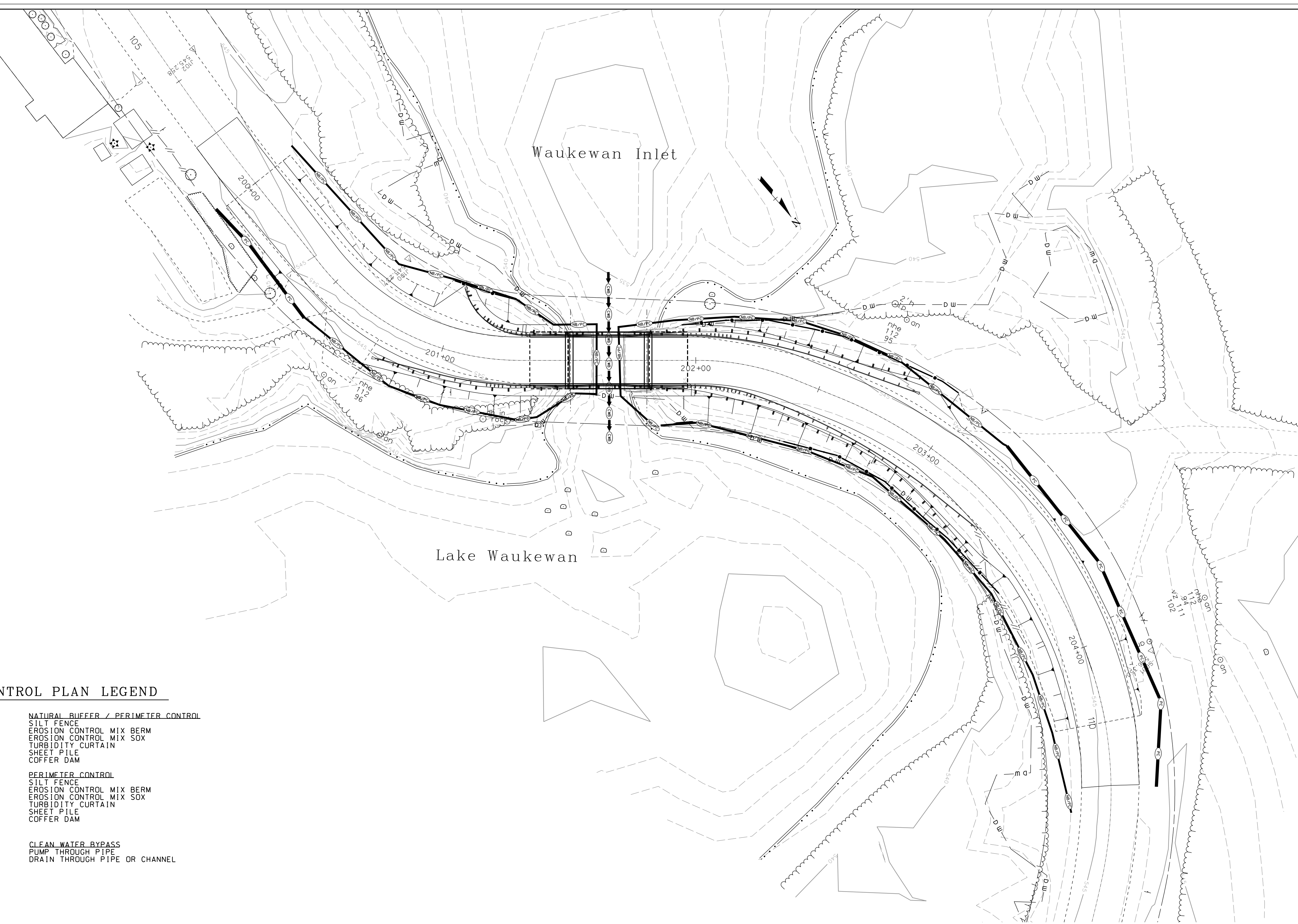

HEB Engineers, Inc.
 Post Office Box 440
 2605 White Mountain Hwy.
 North Conway, NH 03860
 www.hebengineers.com
 Office (603) 356-6936
 Fax (603) 356-7715

STATE OF NEW HAMPSHIRE
 DEPARTMENT OF TRANSPORTATION • BUREAU OF HIGHWAY DESIGN

EROSION CONTROL PLAN

SHEET SCALE	DGN	STATE PROJECT NO.	SHEET NO.	TOTAL SHEETS
1" = 20'	24579eroscontrol	24579	7	8

SDR PROCESSED	NHDDT	DATE	10/20/2020
		DATE	10/20/2020
		DATE	10/20/2020
NEW DESIGN	EVS	DATE	10/20/2020
		DATE	10/20/2020
SHEET CHECKED	CRF	DATE	
		DATE	
AS BUILT DETAILS		DATE	

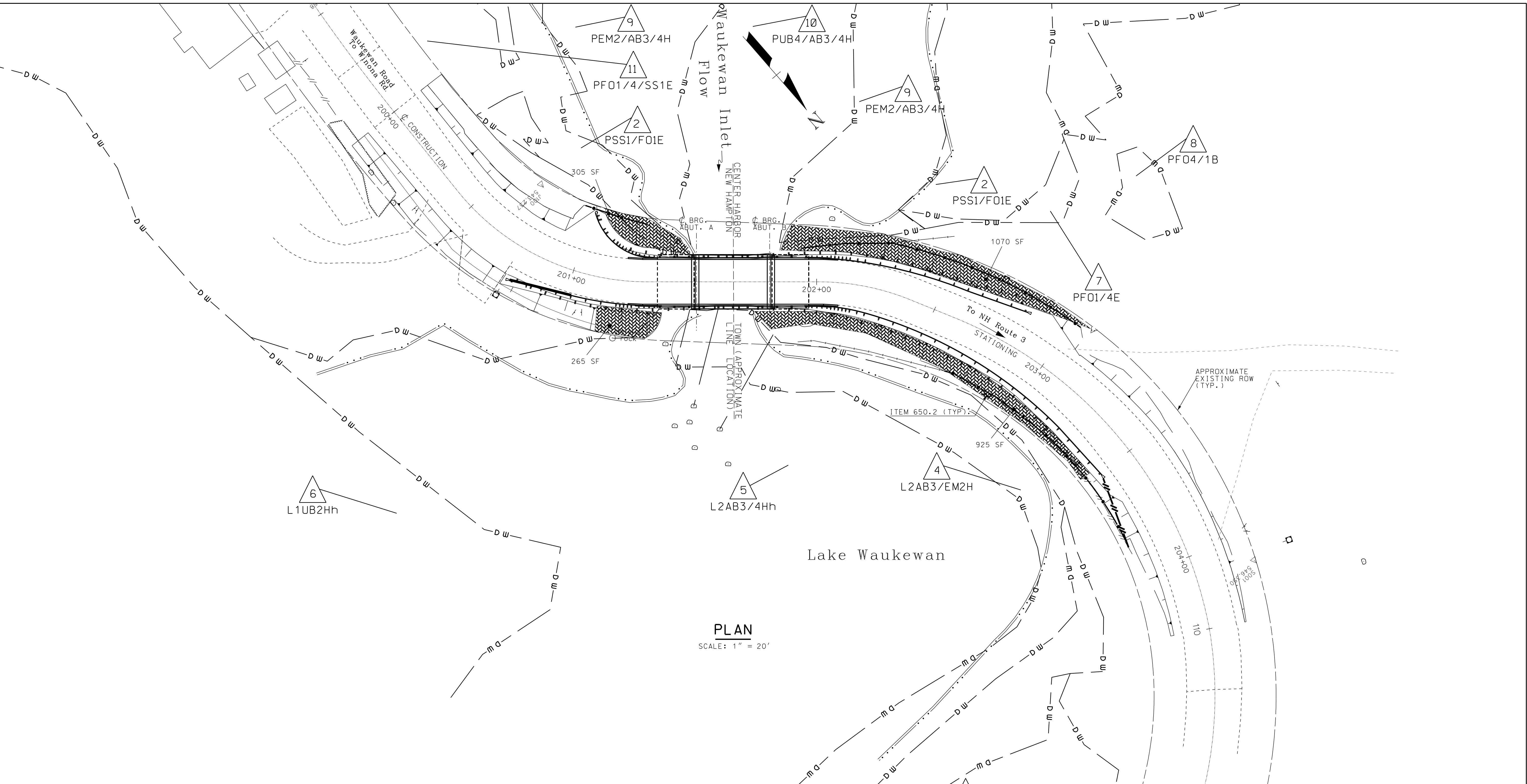

PLAN
SCALE: 1" = 20'

LANDSCAPE LEGEND

- ITEM 650.2 - LANDSCAPING
- LANDSCAPING AREAS (TOTAL AREA = 2565 SF)
- SPACED 5' OC IN GROUPS OF 3, ALTERNATING SPECIES.
- 12 - ALNUS INCANA (RUGOSA), SPECKLED ALDER, 3-4' PC
 - 12 - CEPHALANTHUS OCCIDENTALIS, BUTTON BUSH, 3-4' PC
 - 12 - GAULTHERIA PROCUMBENS, AMERICAN WINTERGREEN, #1 PC
 - 12 - ILEX MUCRONATA, MOUNTAIN HOLLY, 2-3' PC
 - 18 - ILEX VERTICILLATA, WINTERBERRY, 2-3' PC
 - 12 - KALMIA ANGUSTIFOLIA, SHEEP LAUREL, 2-3' PC
 - 12 - OSMUNDA CINNAMONEA, CINNAMON FERN, #1 PC
 - 12 - VACCINIUM ANGUSTIFOLIUM, LOWBUSH BLUEBERRY, 18-24" PC
 - 12 - VACCINIUM CORYMBOSUM, HIGHBUSH BLUEBERRY, 2-3' PC

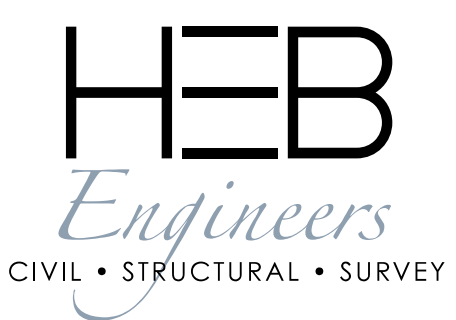
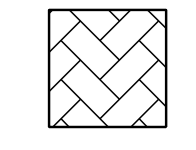

HEB Engineers, Inc.
Post Office Box 440
2605 White Mountain Hwy.
North Conway, NH 03860
www.hebengineers.com
Office (603) 356-6936
Fax (603) 356-7715

STATE OF NEW HAMPSHIRE
DEPARTMENT OF TRANSPORTATION • BUREAU OF HIGHWAY DESIGN

LANDSCAPING PLAN

SHEET SCALE	DGN	STATE PROJECT NO.	SHEET NO.	TOTAL SHEETS
1" = 20'	24579Landscape	24579	8	8