

ROUTE 123A

Alstead - Langdon - Acworth

Pipe #1

SCALE 1" = 20'

DRAWN BY: KTB

1/21/2016

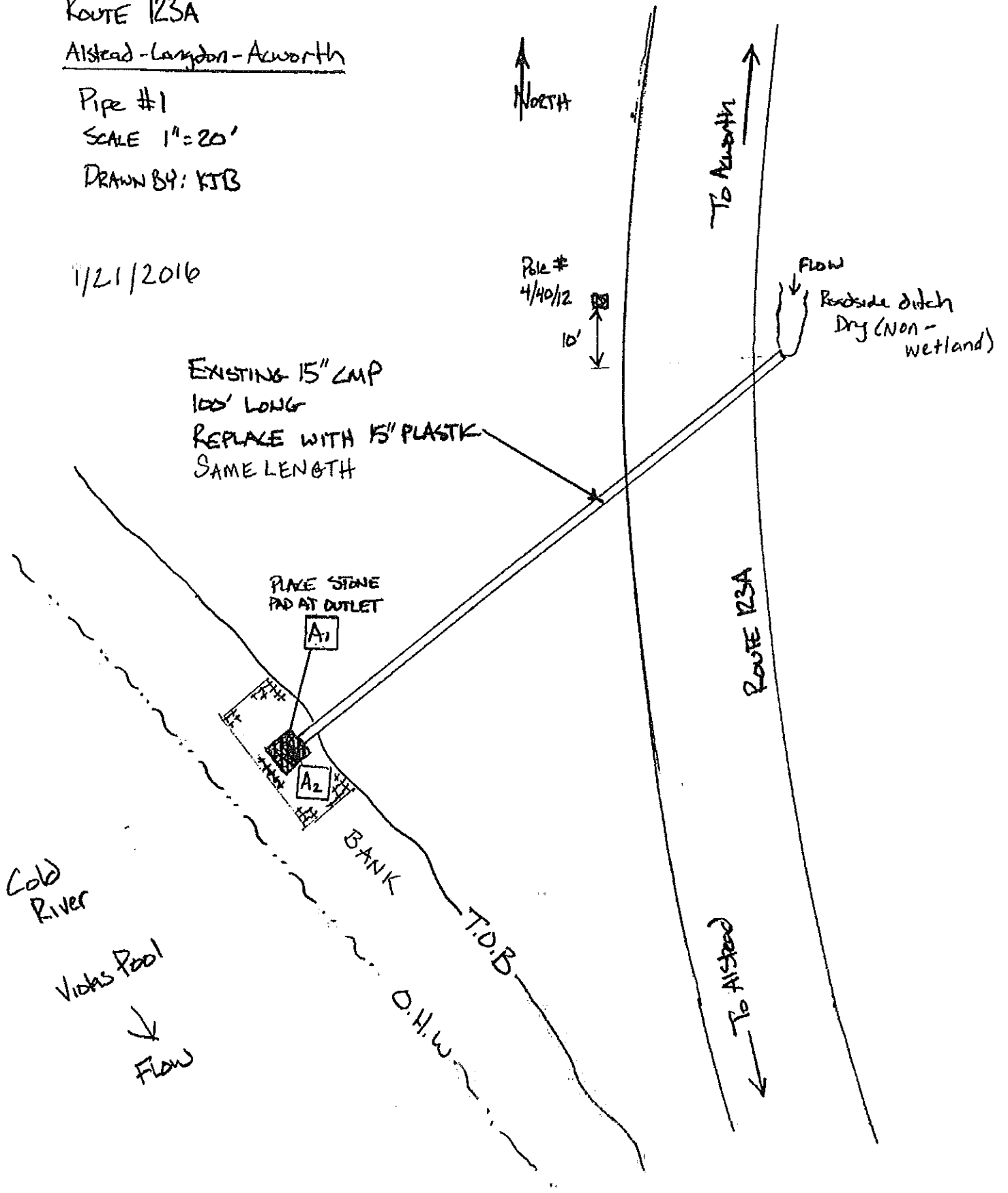

ROUTE 123A

Alstead - Langdon - Acworth

Pipe #3

Scale 1" = 20'

DRAWN BY: KJTB

1/21/2016

EXISTING 15" CMP
30' LONG
REPLACE WITH 18" PLASTIC
40' LONG

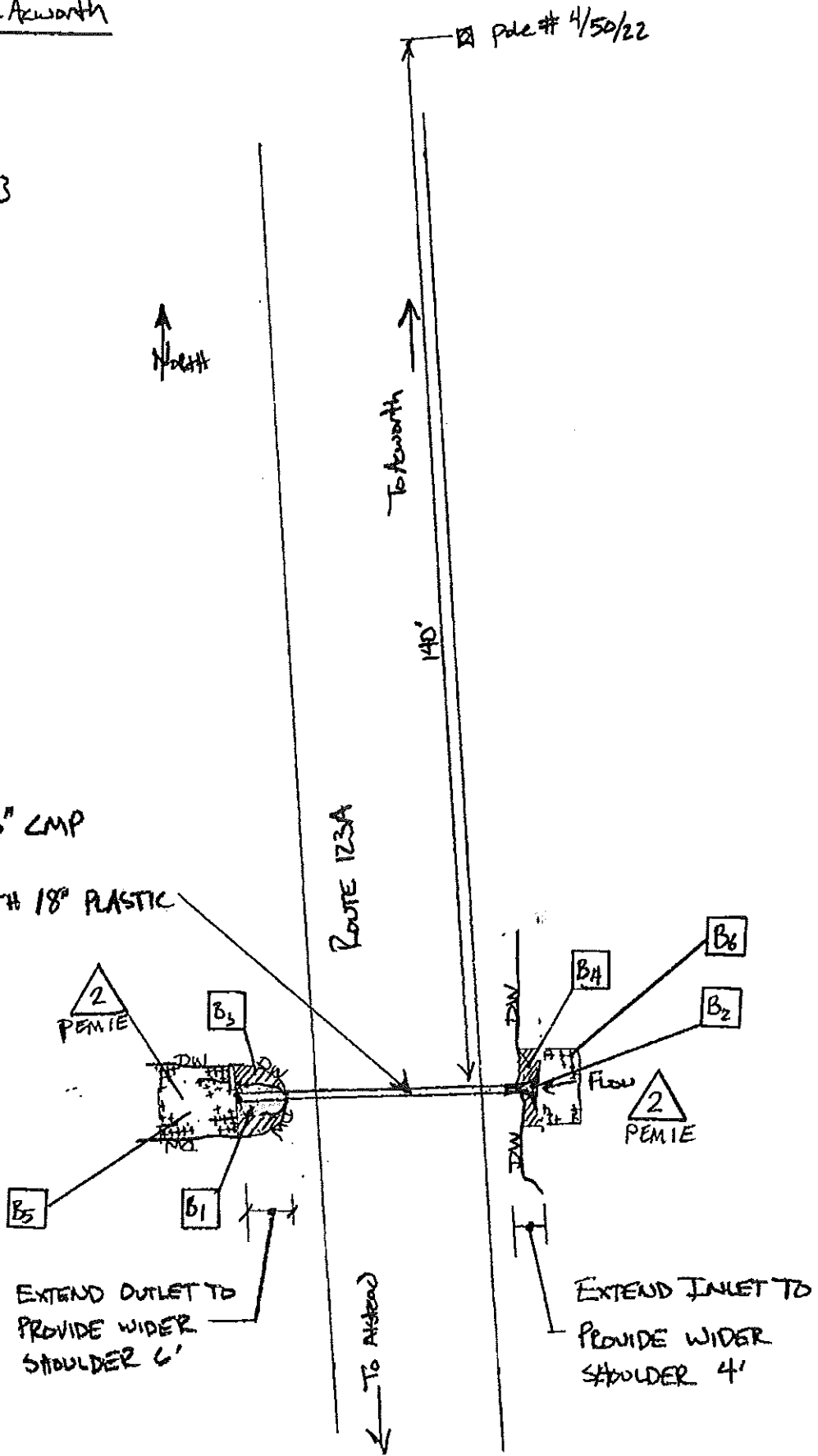

ROUTE 123A

pole # 4/50/22

To Acworth
140'

North

EXTEND OUTLET TO
PROVIDE WIDER
SHOULDER 6'

EXTEND INLET TO
PROVIDE WIDER
SHOULDER 4'

To Alstead

Flow
2
PEMIE

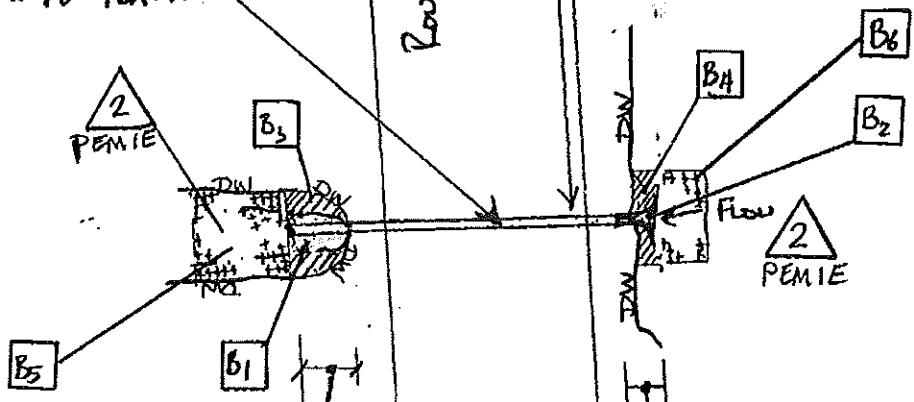

ROUTE 123A

Atshead - Langdon - Asworth

Pipe # 4

Scale: 1" = 20'

Drawn By: KJB

1/21/2016

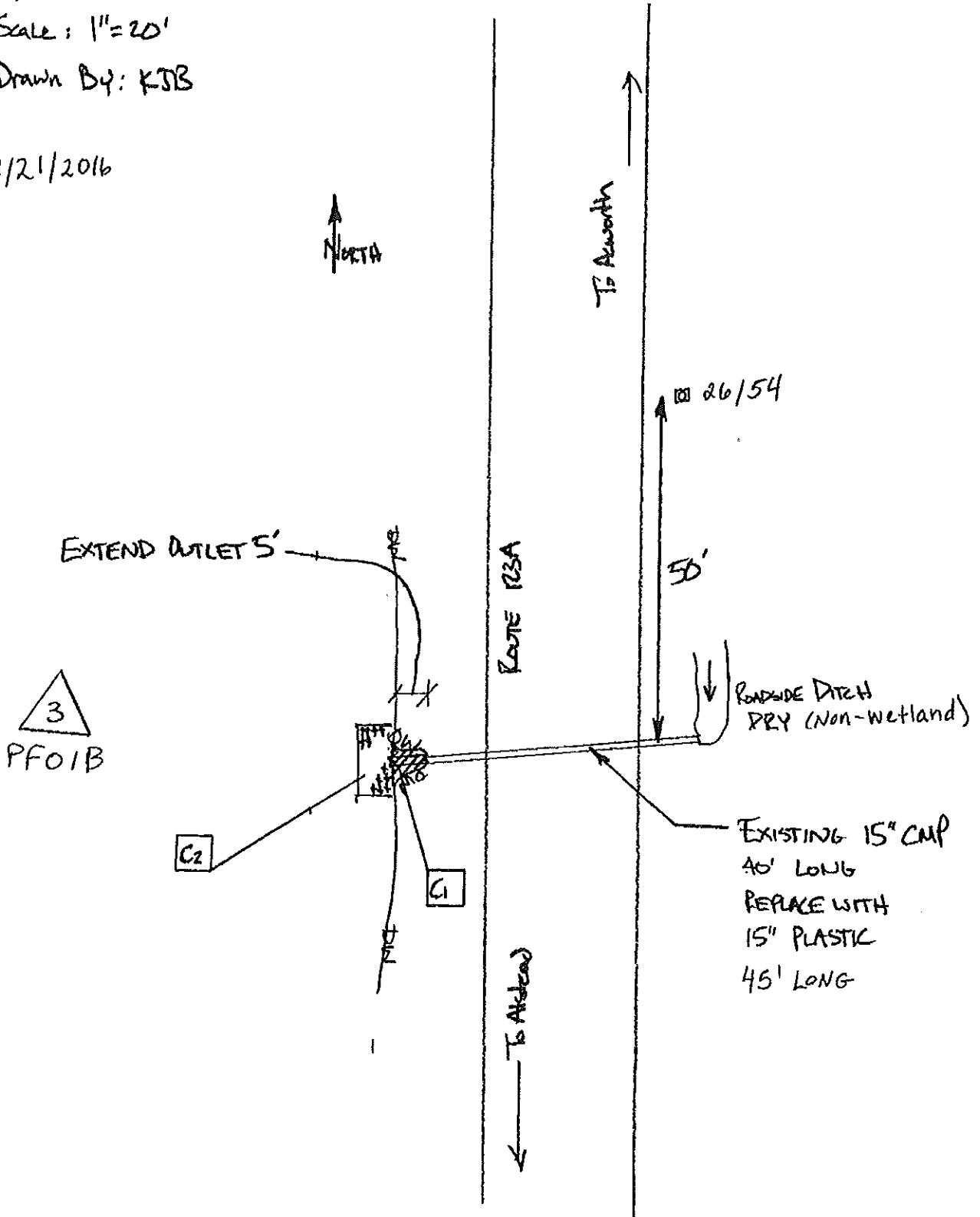

ROUTE 123A

Alstead - Langdon - Acworth

Pipe #6

Scale: 1"=20'

Drawn By: KJB

1/21/2016

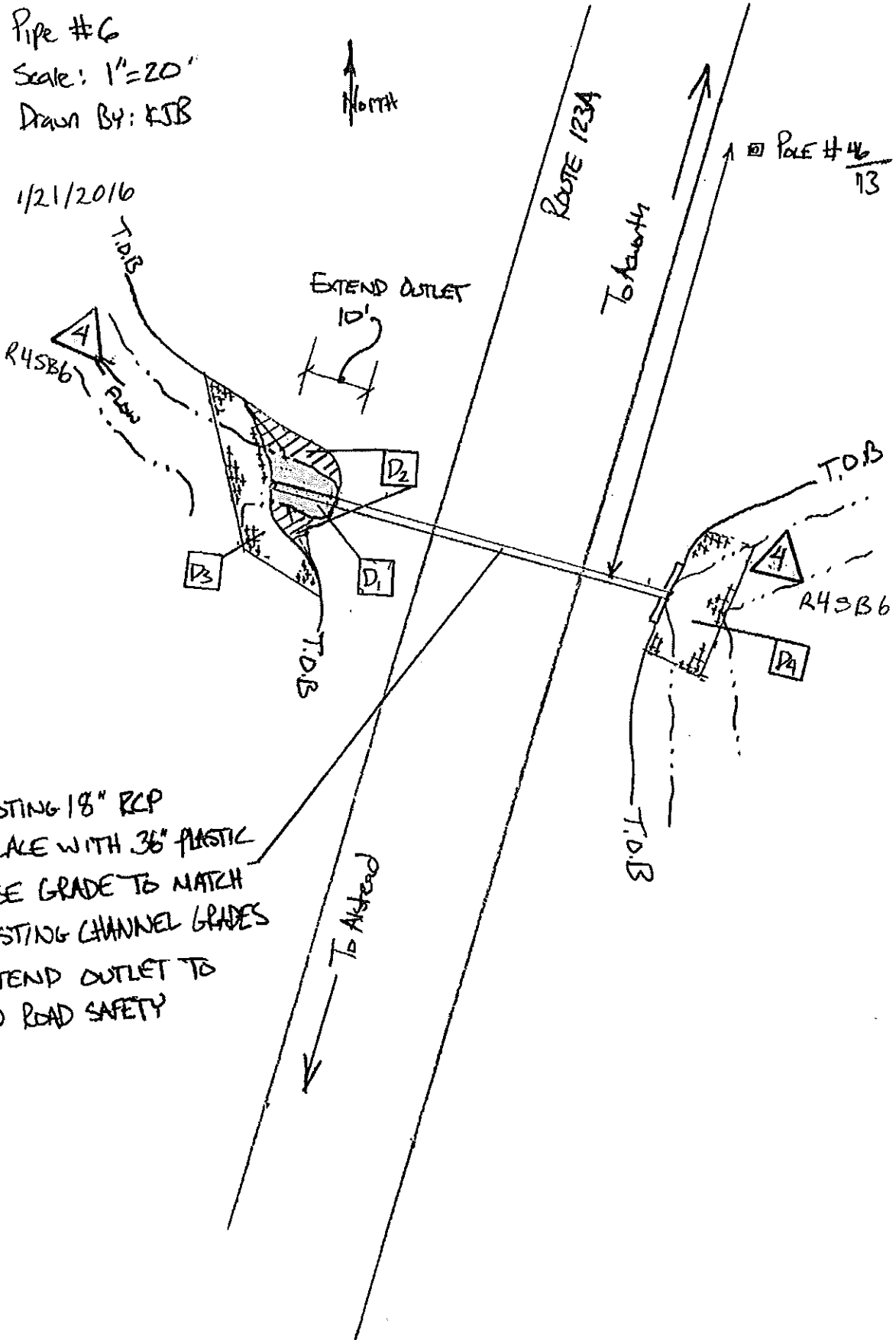

EXISTING 18" RCP
REPLACE WITH 36" PLASTIC
RAISE GRADE TO MATCH
EXISTING CHANNEL GRADES
EXTEND OUTLET TO
ADD ROAD SAFETY

ROUTE 123A

Atstead - Langdon - Acworth

Pipe # 8

Scale 1" = 20'

Drawn By: KJB

1/21/2016

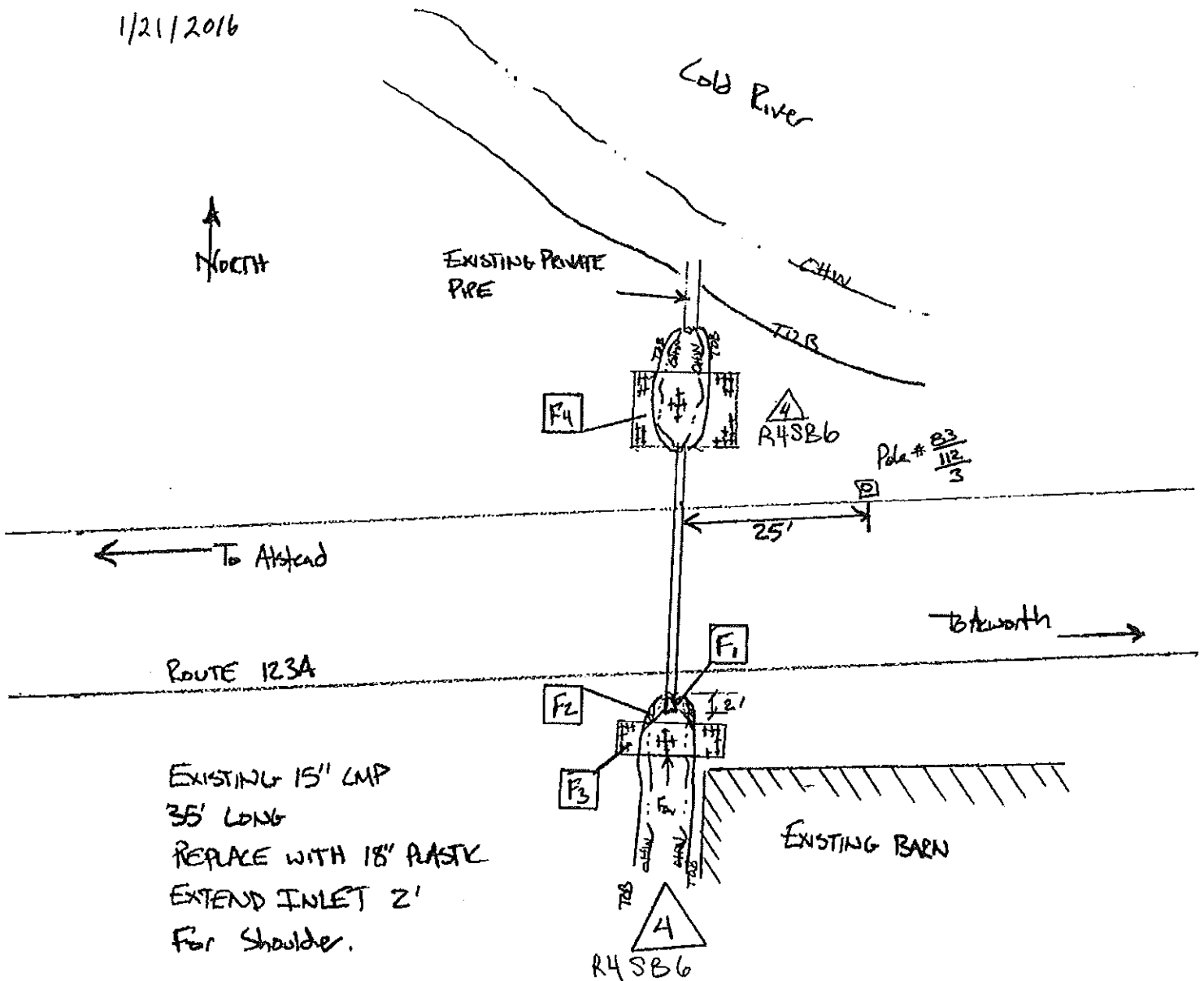

ROUTE 123A

Alstead - Lampton - Acworth

Pipe #9

Scale: 1"=20'

DRAWN BY: KJP

1/21/2016



Cold River

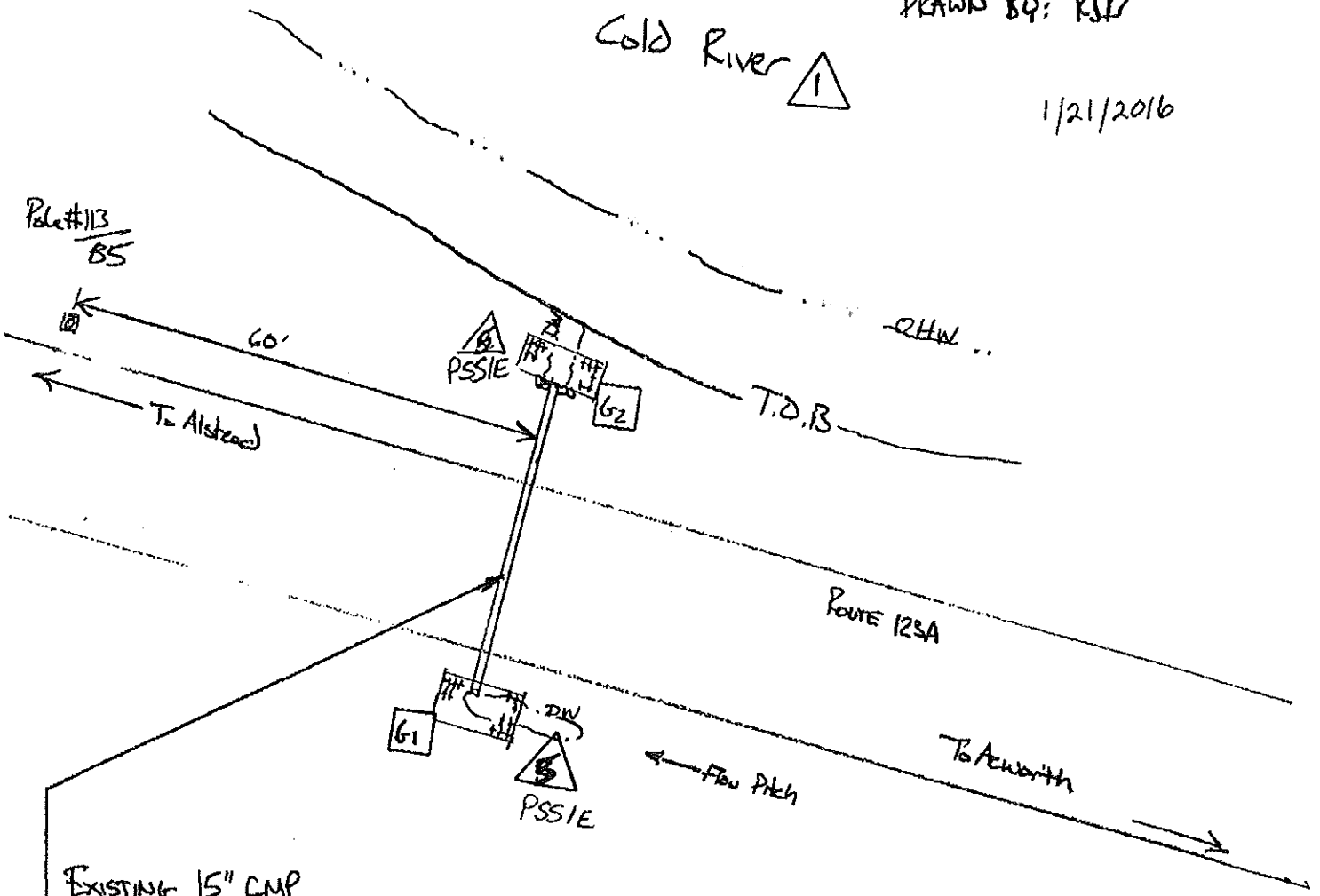

EXISTING 15" CMP
40' LONG
REPLACE WITH 15" PLASTIC
SAME LENGTH

ROUTE 123-A

Atstead - Langdon - Acworth

Pipe #10

Scale 1"=20'

DRAWN BY: KTB

1/21/2016

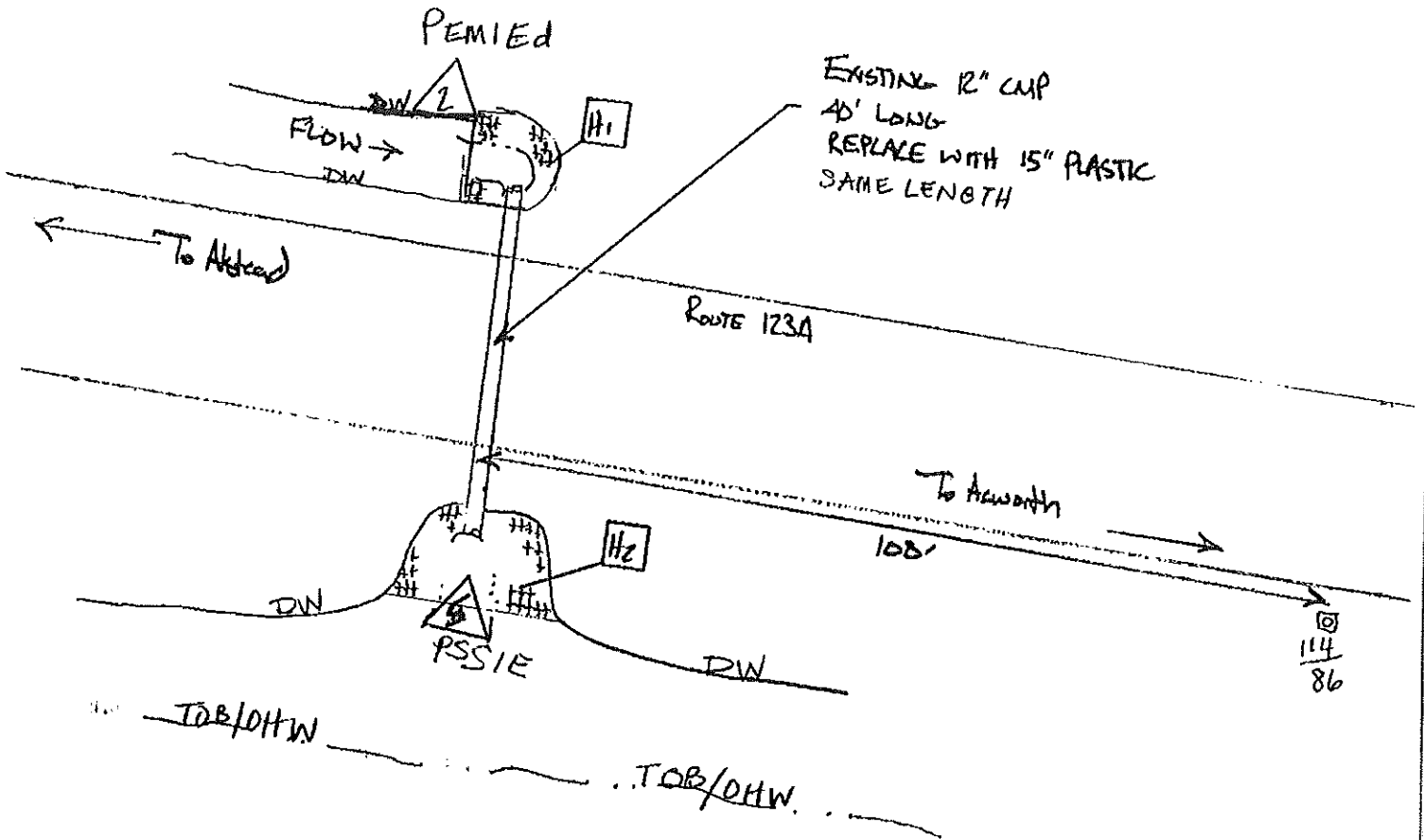

COLD FLOW RIVER →

ROUTE 123A
Alstead - Acworth - Langdon

Pipe # 13
Scale: 1" = 20'
DRAWN BY: KJB
1/21/2016

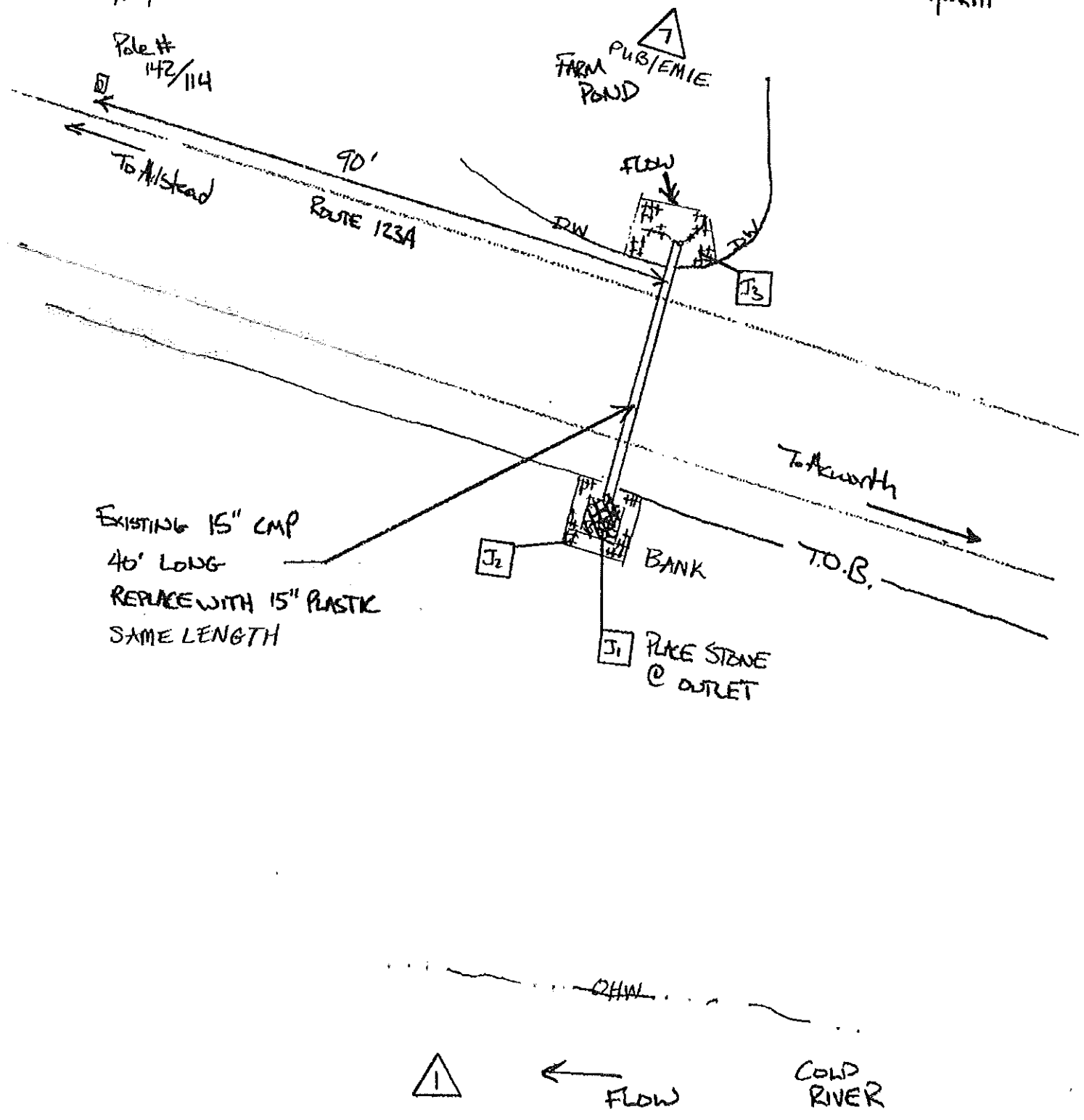

ROUTE 123A

Atstead - Acworth - Langdon

Pipe #14

Scale: 1"=20'

DRAWN BY: KSB

1/21/2016

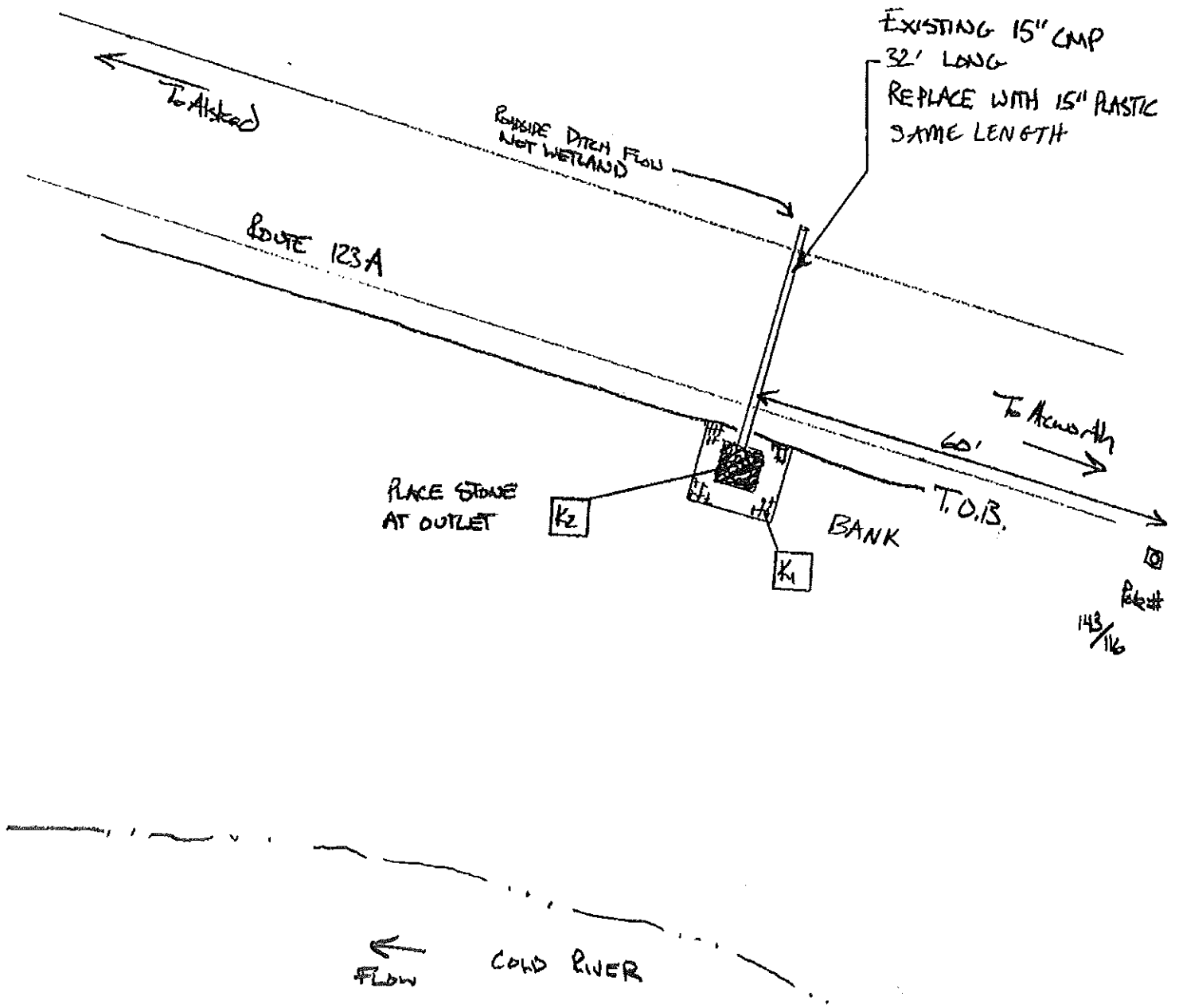

ROUTE 123A

Atstead - Langdon - Acworth

Pipe # 15

Scale: 1" = 20'

DRAWN BY: KJB

1/21/2016

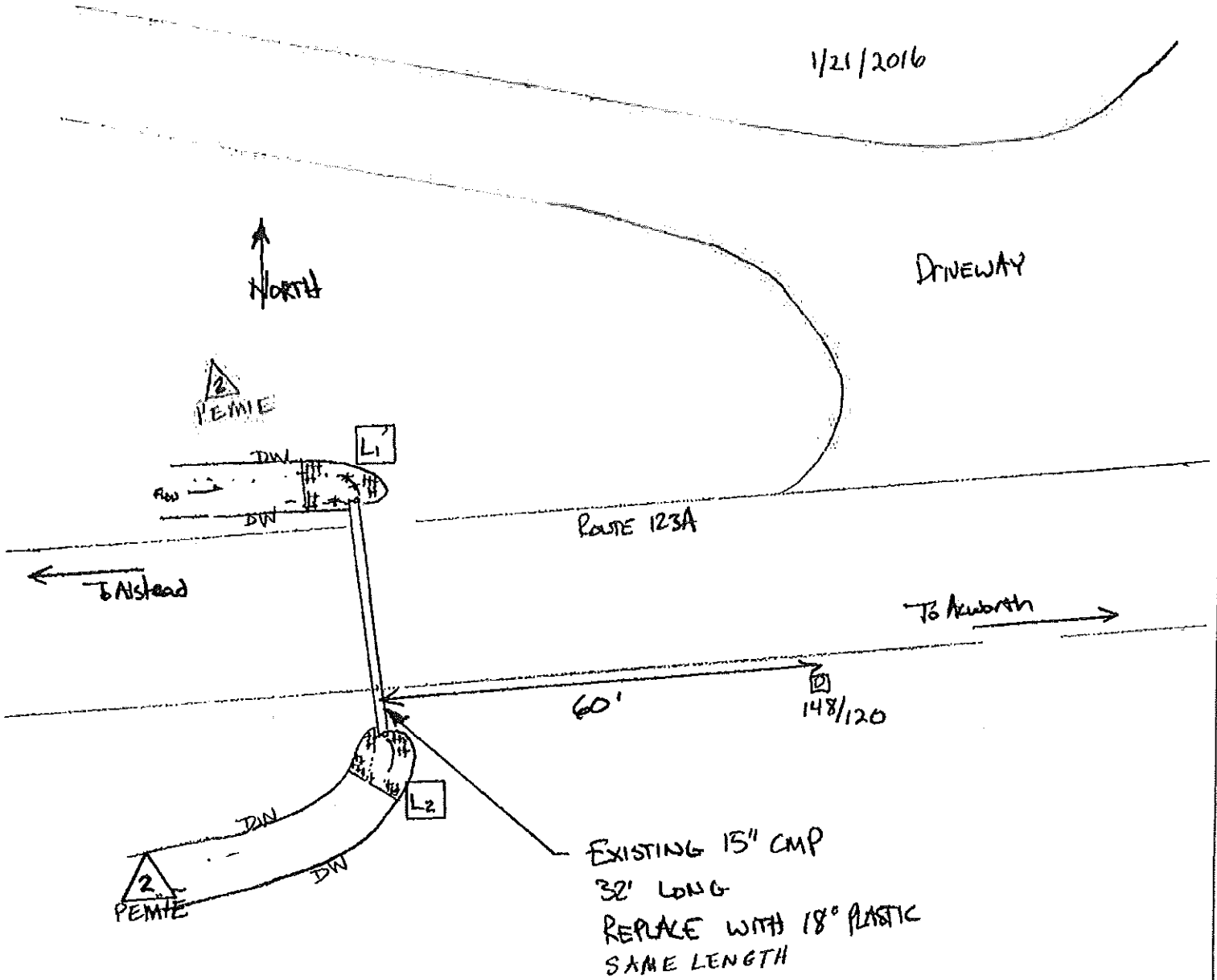

ROUTE 123A

Atstead - Langdon - Akworth

Pipe # K6

Scale: 1" = 20'

DRAWN BY: KTB

1/21/2016

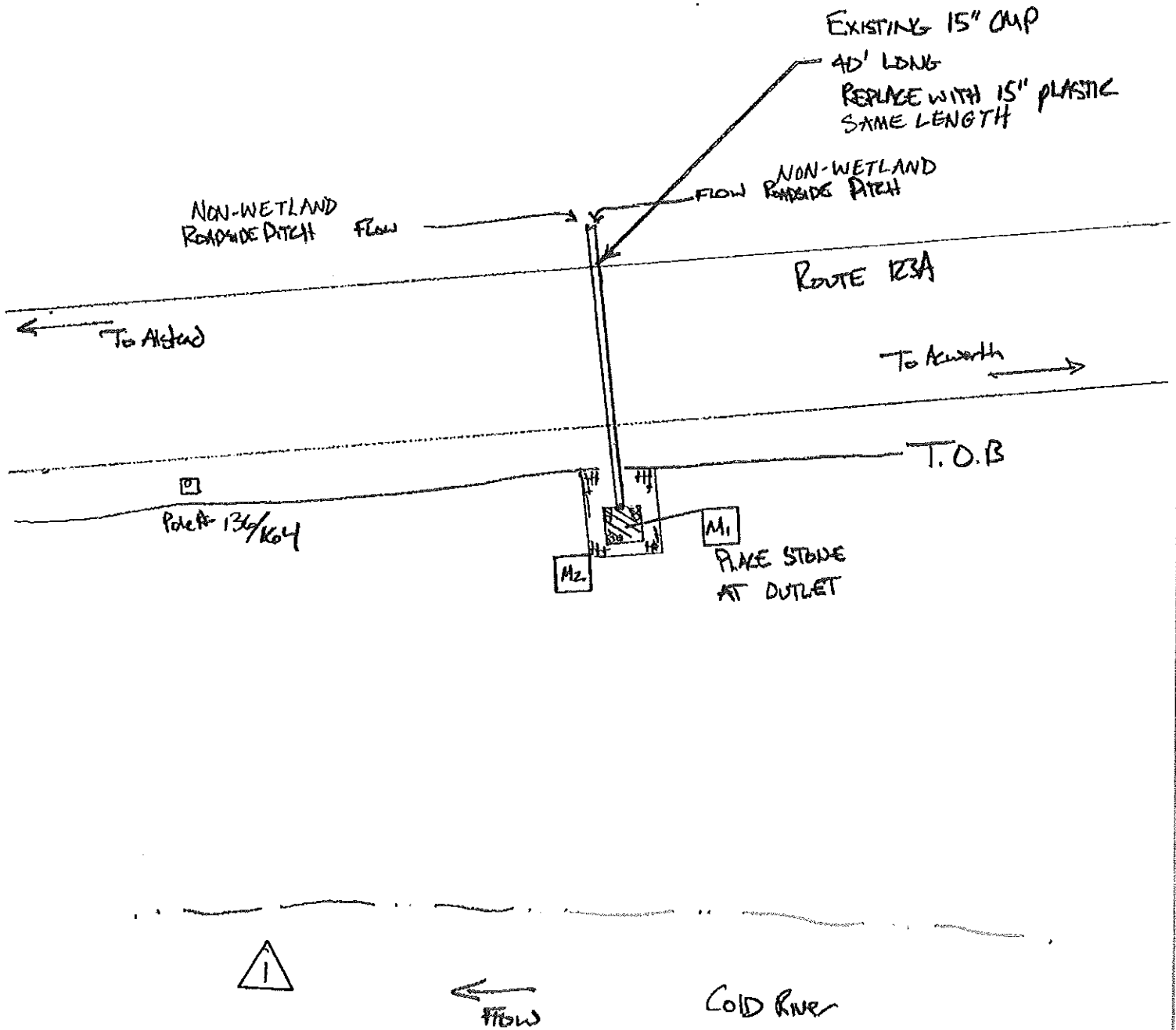

ROUTE 123A

Alstead - Langdon - Acworth

Pipe # 17

Scale: 1" = 20'

Drawn By: FJB

1/21/2016

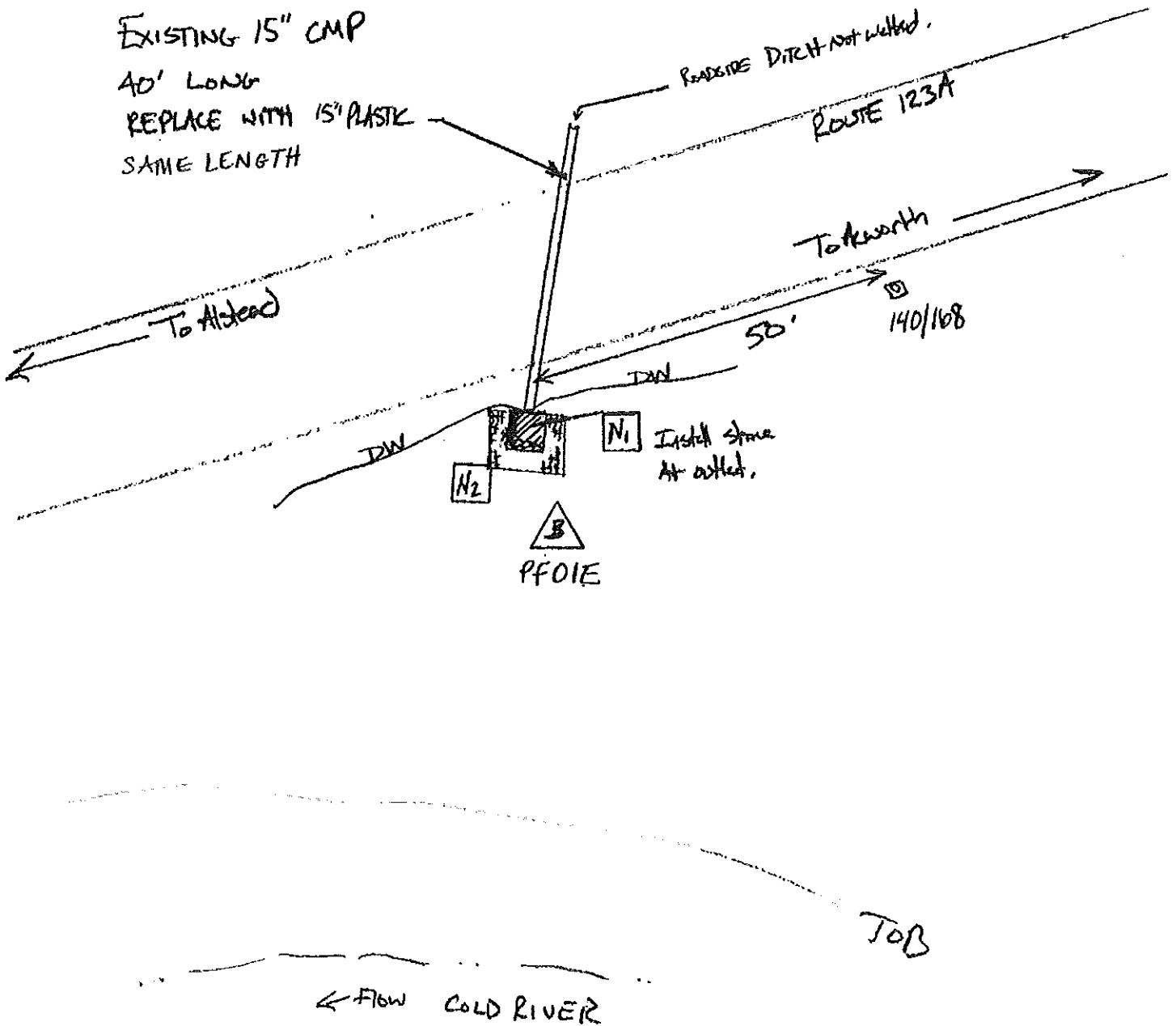

ROUTE 123A

Alstead-Langdon-Azworth

Pipe # 1B

Scale: 1" = 20'

DRAWN BY: KJB

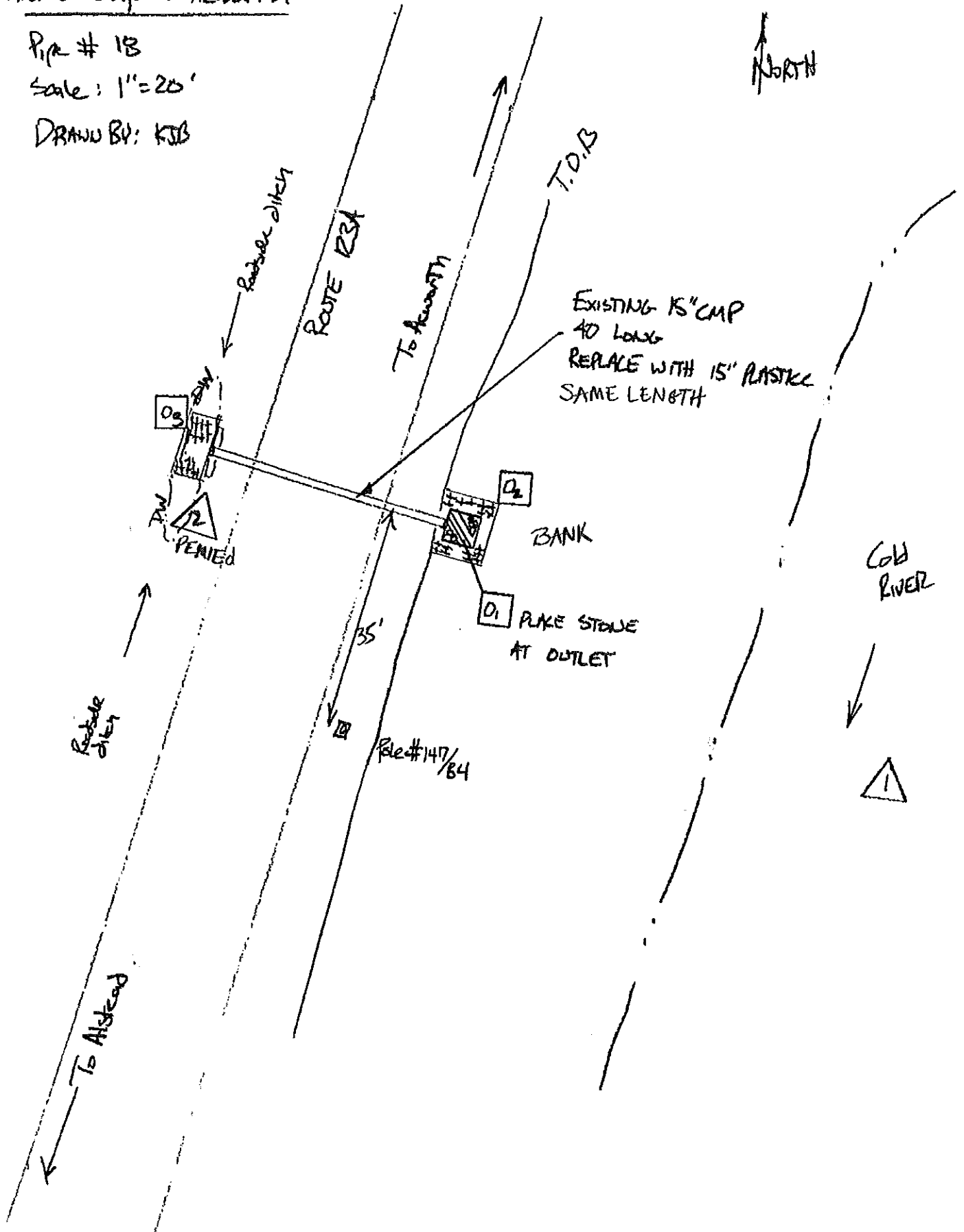

ROUTE 123A

Alstead - Langdon - Acworth

Pipe # 19

Scale: 1" = 20'

Dawn By: KJB

1/21/2016

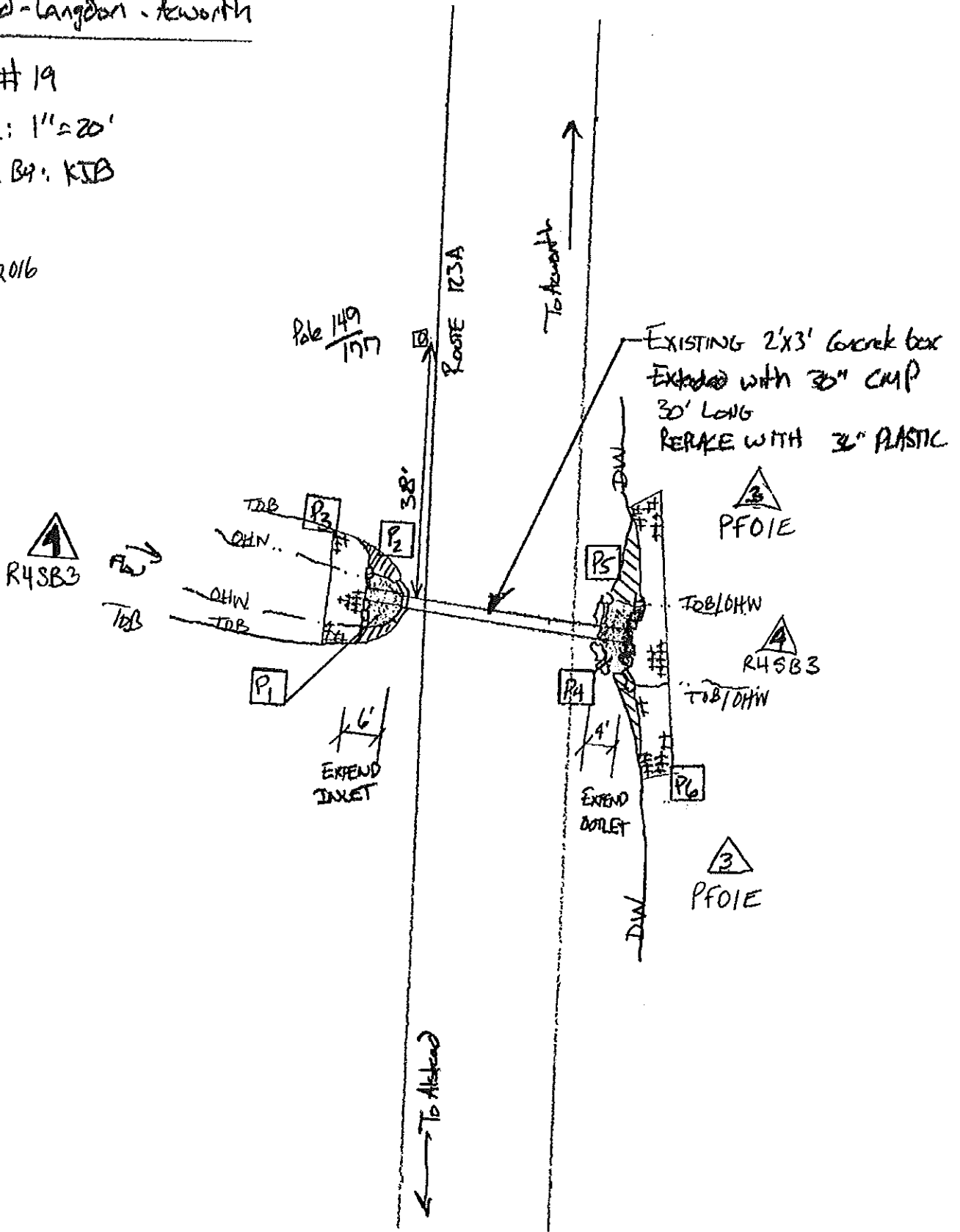

ROUTE 123A

Alstead - Langdon - Acworth

Pipe # 21

Scale: 1" = 20'

DRAWN BY: KJB

1/21/2016

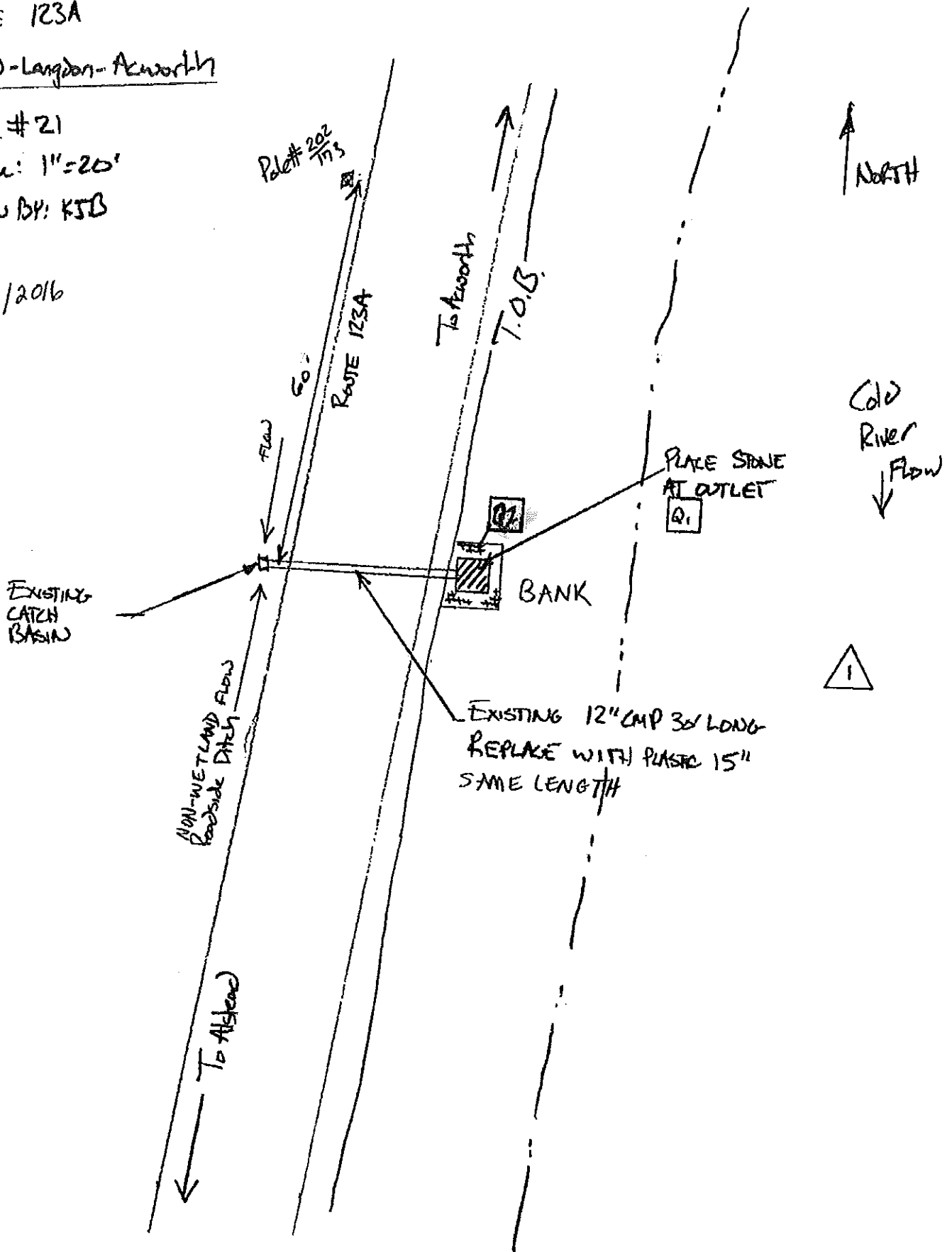

ROUTE 123A

Alstead - Langdon - Acworth

Pipe # 22

Scale: 1"=20'

Drawn By: KTB

1/21/2016

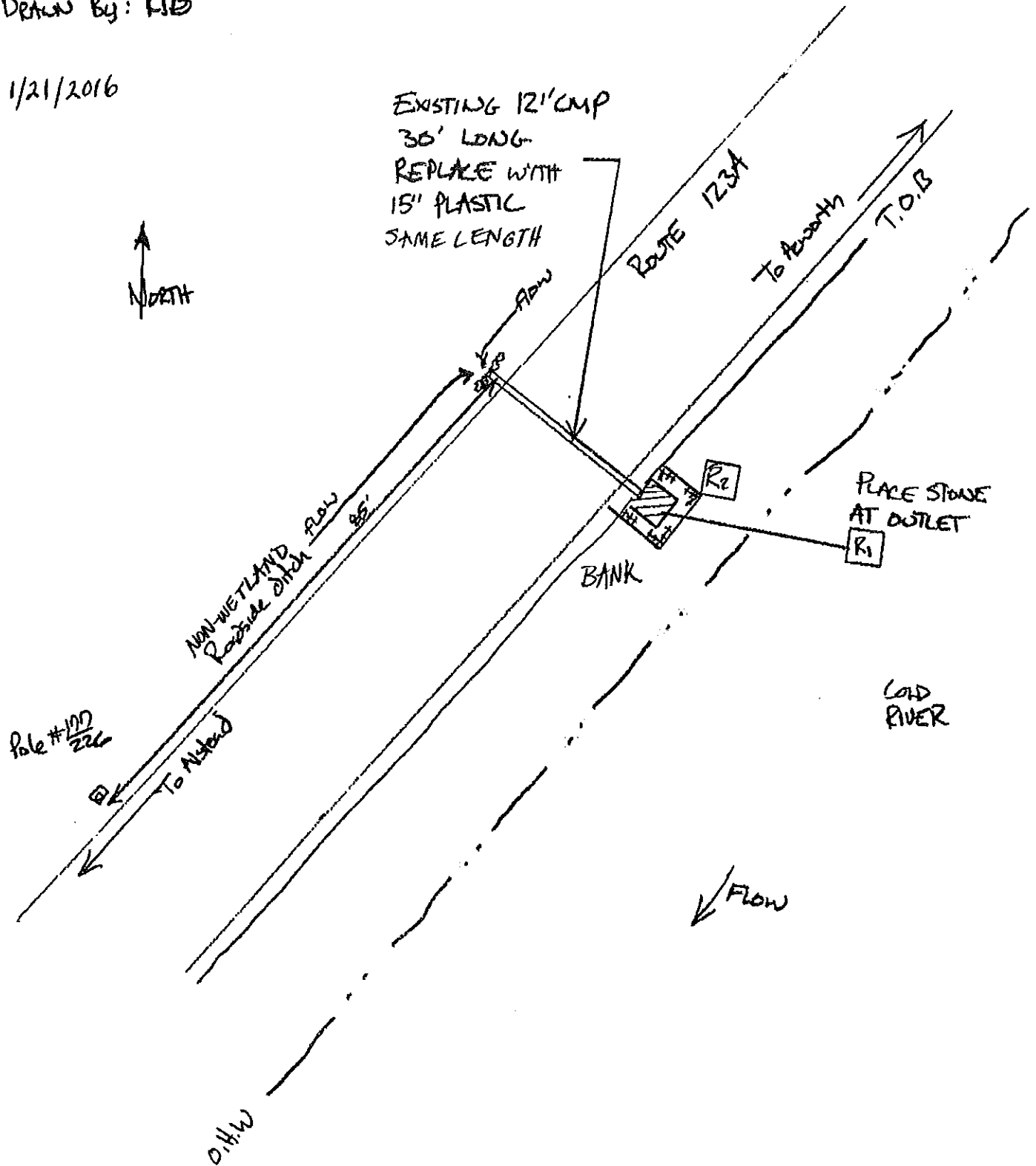

ROUTE 123A

Akwath - Langdon - Alstead

Scale: 1" = 20'

Pipe # 23

DRAWN BY: KJB

1/21/2016

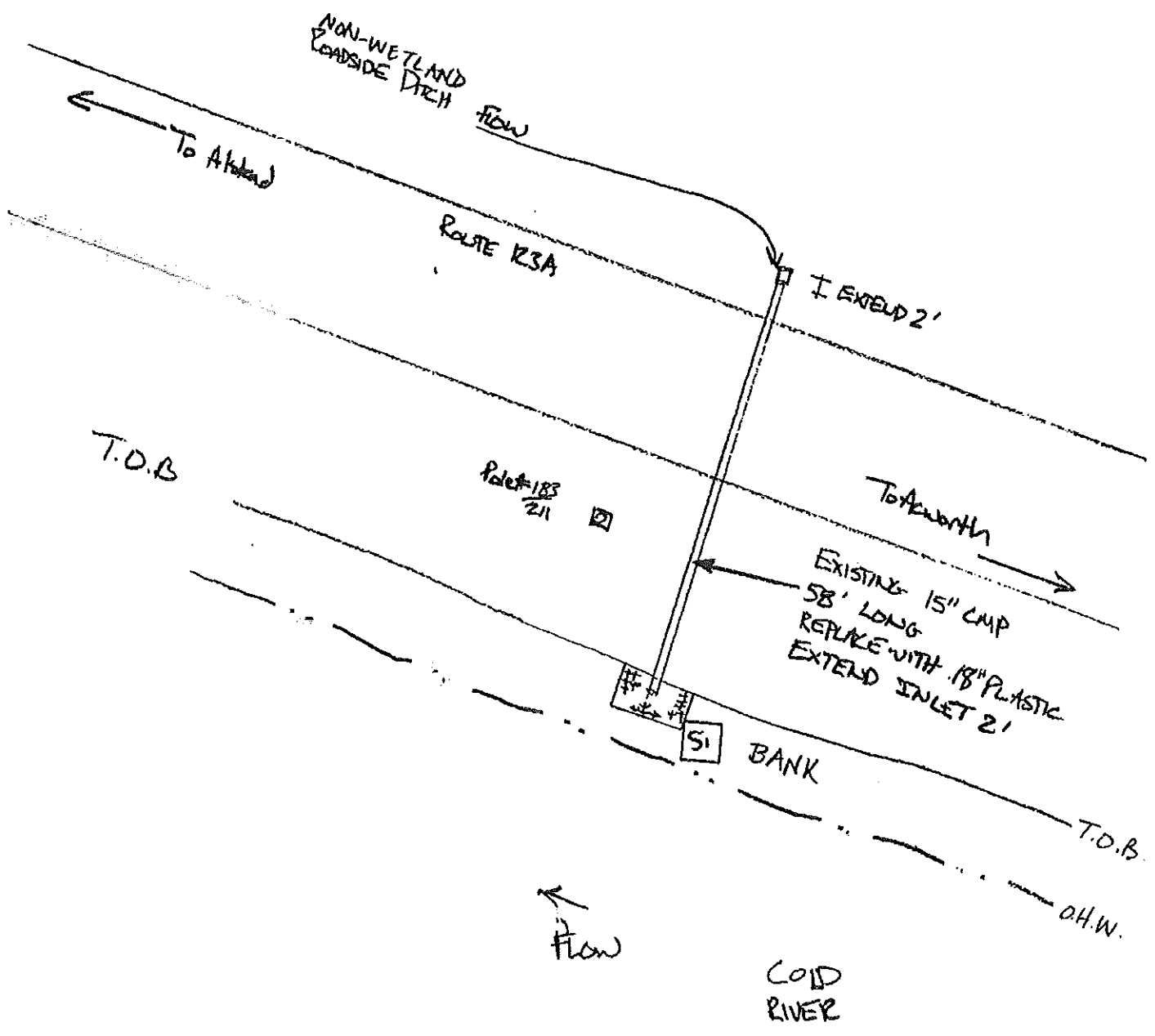

ROUTE 123A

Alstead - Langdon - Acworth

Pipe # 24

Scale: 1" = 20'

DRAWN BY: KJB

1/21/2016

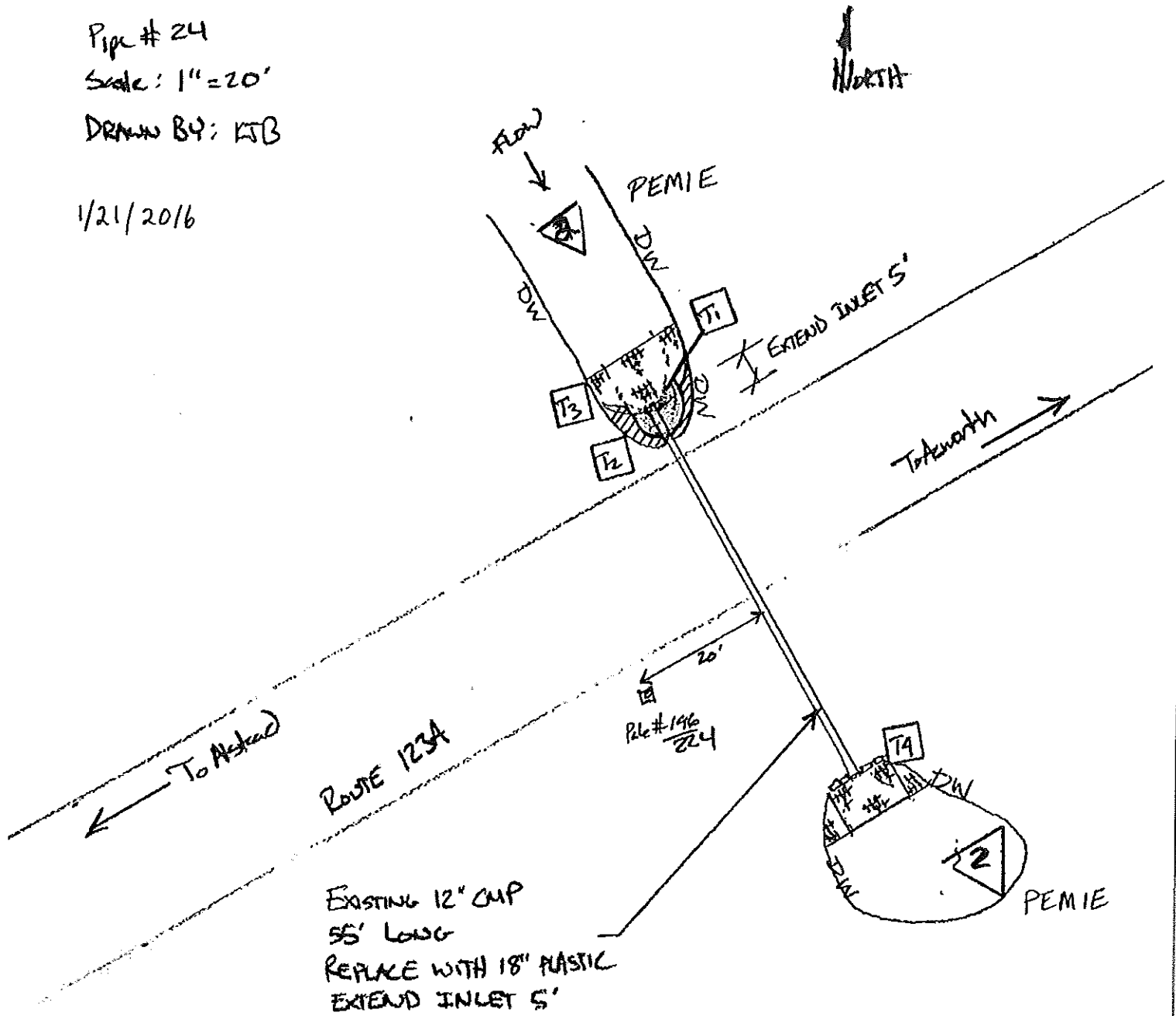

ROUTE 123A

Alstead - Langdon - Acworth

Pipe # 217

SCALE: 1" = 20'

DRAWN BY: KJB

1/21/2016

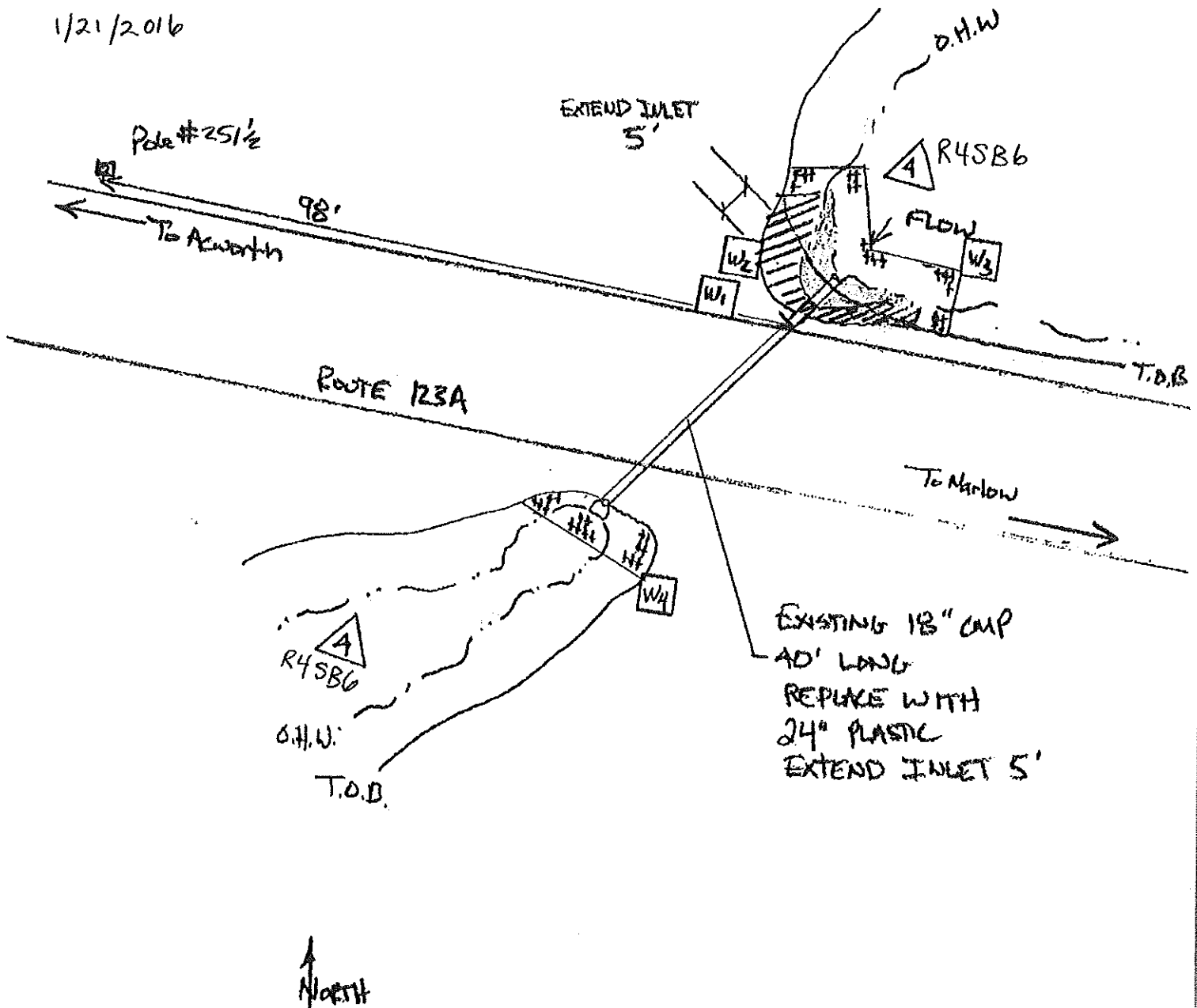

ROUTE 123A

Atskow - Langdon - Acworth

PIPE # 30

SCALE: 1" = 20'

DRAWN BY: KJB



1/21/2016

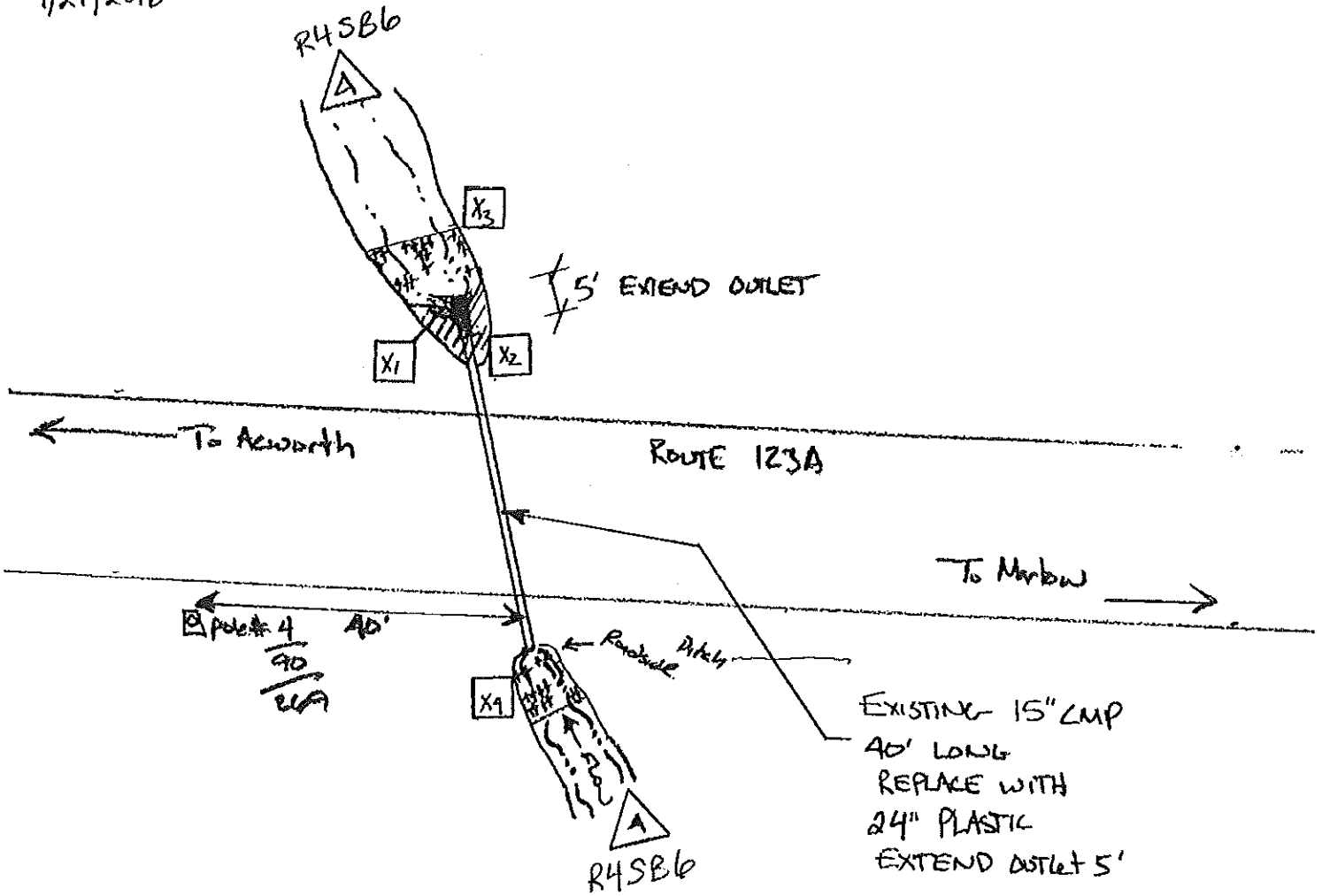

ROUTE 123A

Alstead-Langdon-Akworth

Pipe #31

SCALE: 1"=20'

DRAWN BY: KTB

1/21/2016

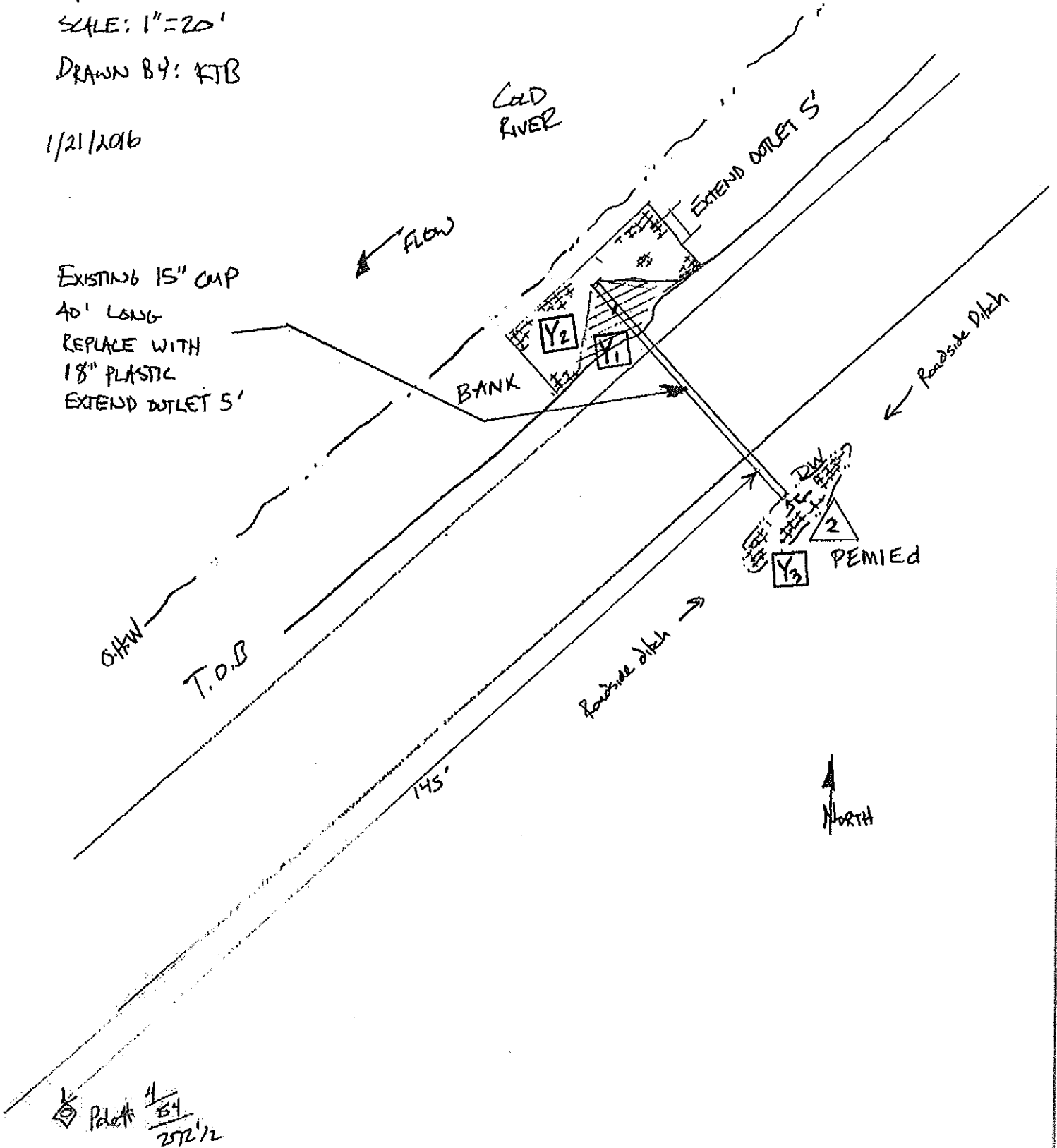

ROUTE 123A

Alstead-Langdon-Acworth

Pipe # 32

SCALE: 1"=20'

DRAWN BY: KTB

1/21/2016

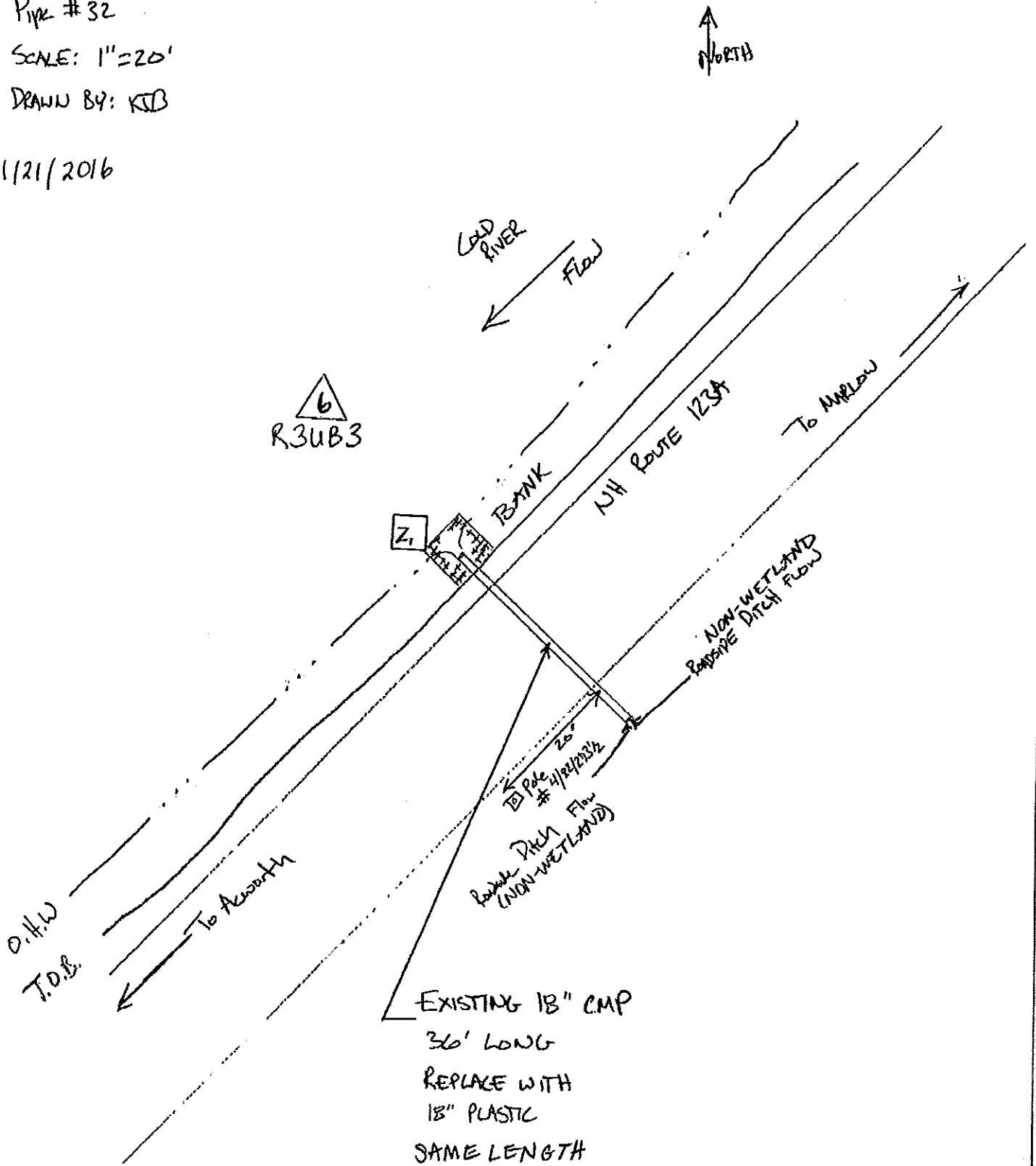

ROUTE 123A

Alstead - Langdon - Acworth

Pipe # 33

SCALE: 1" = 20'

DRAWN BY: KJB

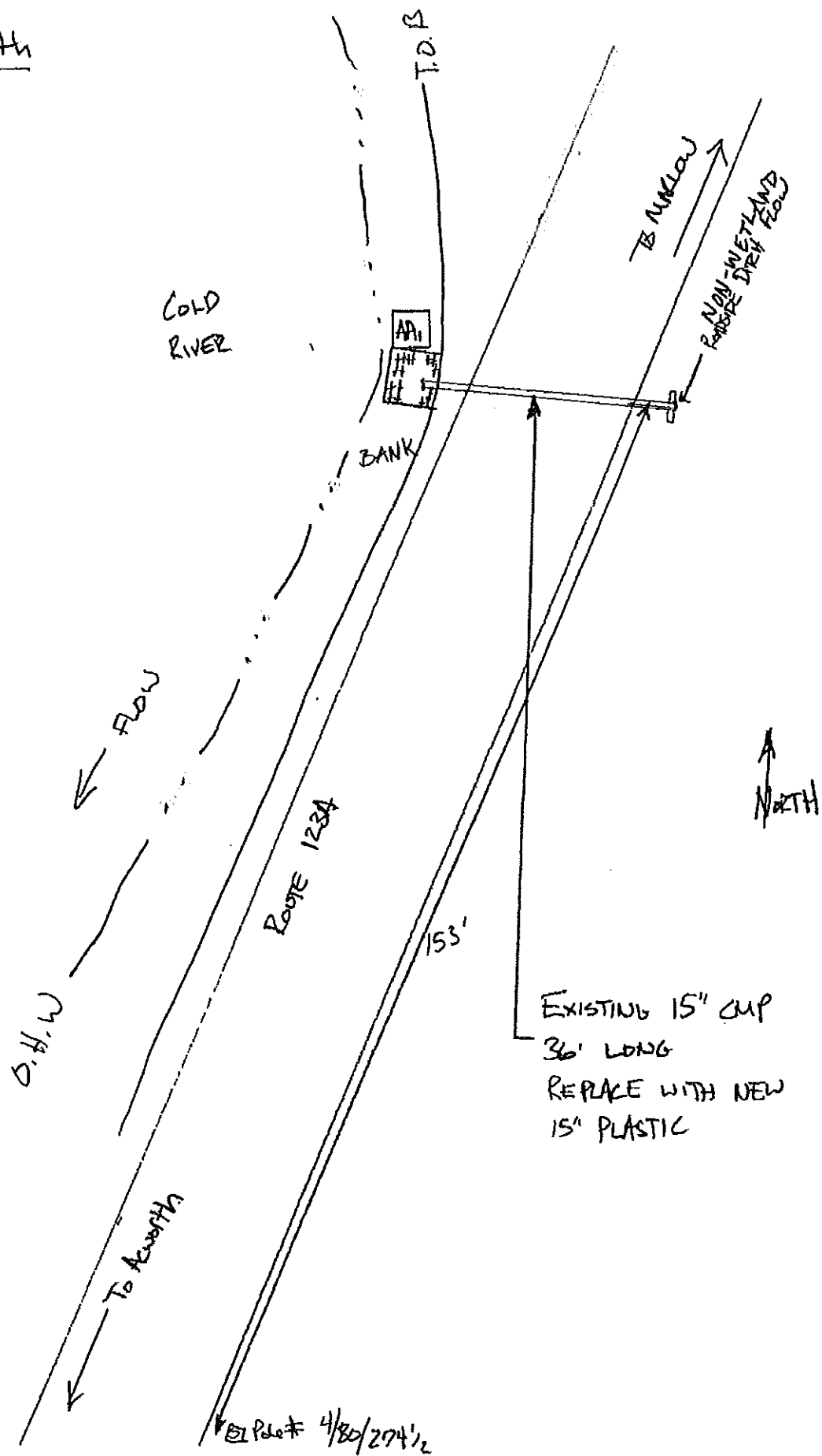

ROUTE 123A

Alstead - Langdon - Acworth

Pipe # 35

Scale: 1" = 20'

DRAWN BY: KJTB

1/21/2016

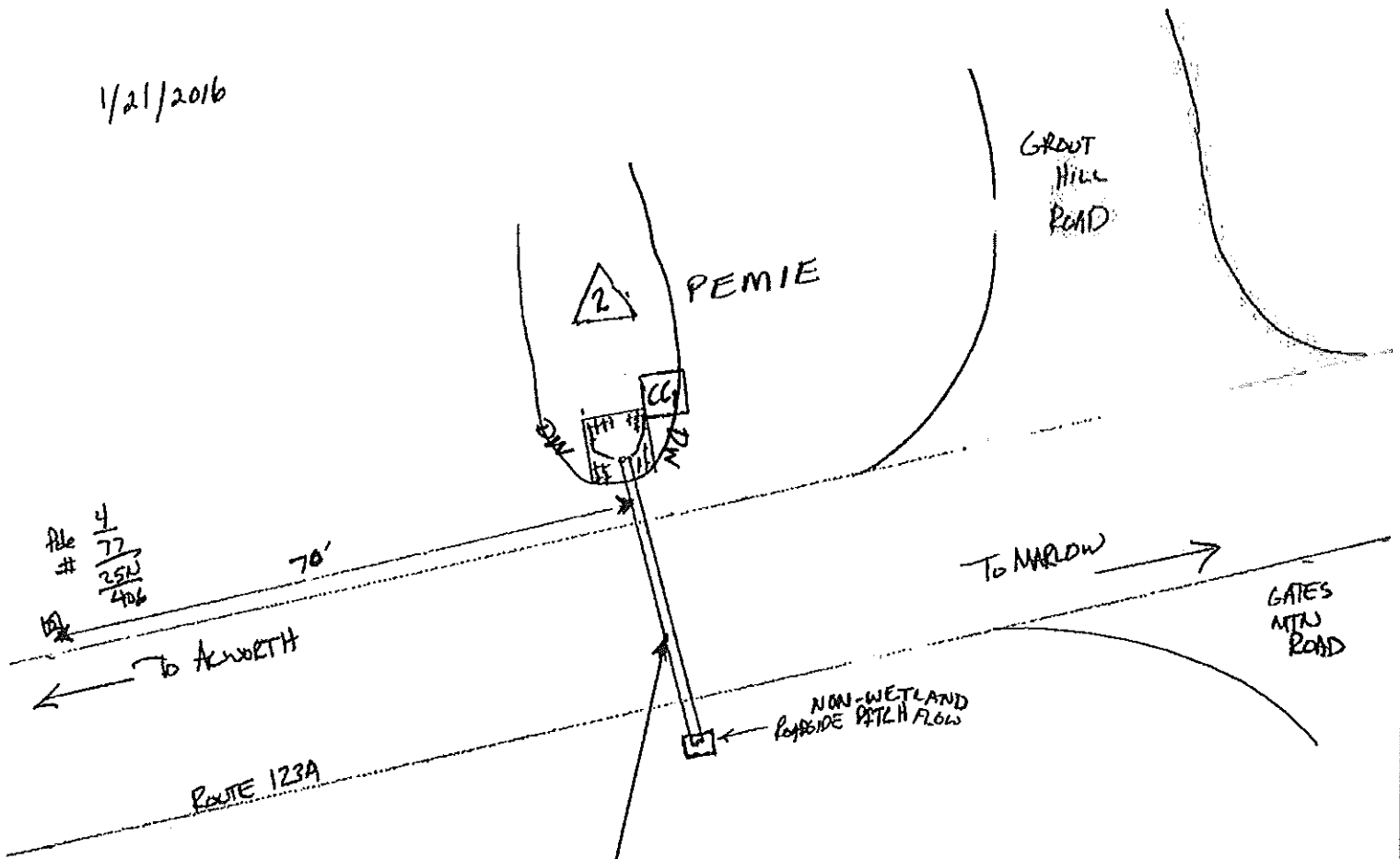

EXISTING 15" CMP
35' LONG
REPLACE WITH
15" PLASTIC
SAME LENGTH

File #
4
77
352
406

70'

TO ACWORTH

ROUTE 123A

PEMIE

GROAT HILL ROAD

TO MARLOW

GATES MT. ROAD

NON-WETLAND
ROADSIDE PATCH FLOW

NORTH

ROUTE 123A

Atstead - Langdon - Acworth

PIPE # 36

SCALE: 1"=20'

DRAWN BY: KTB

1/21/2016

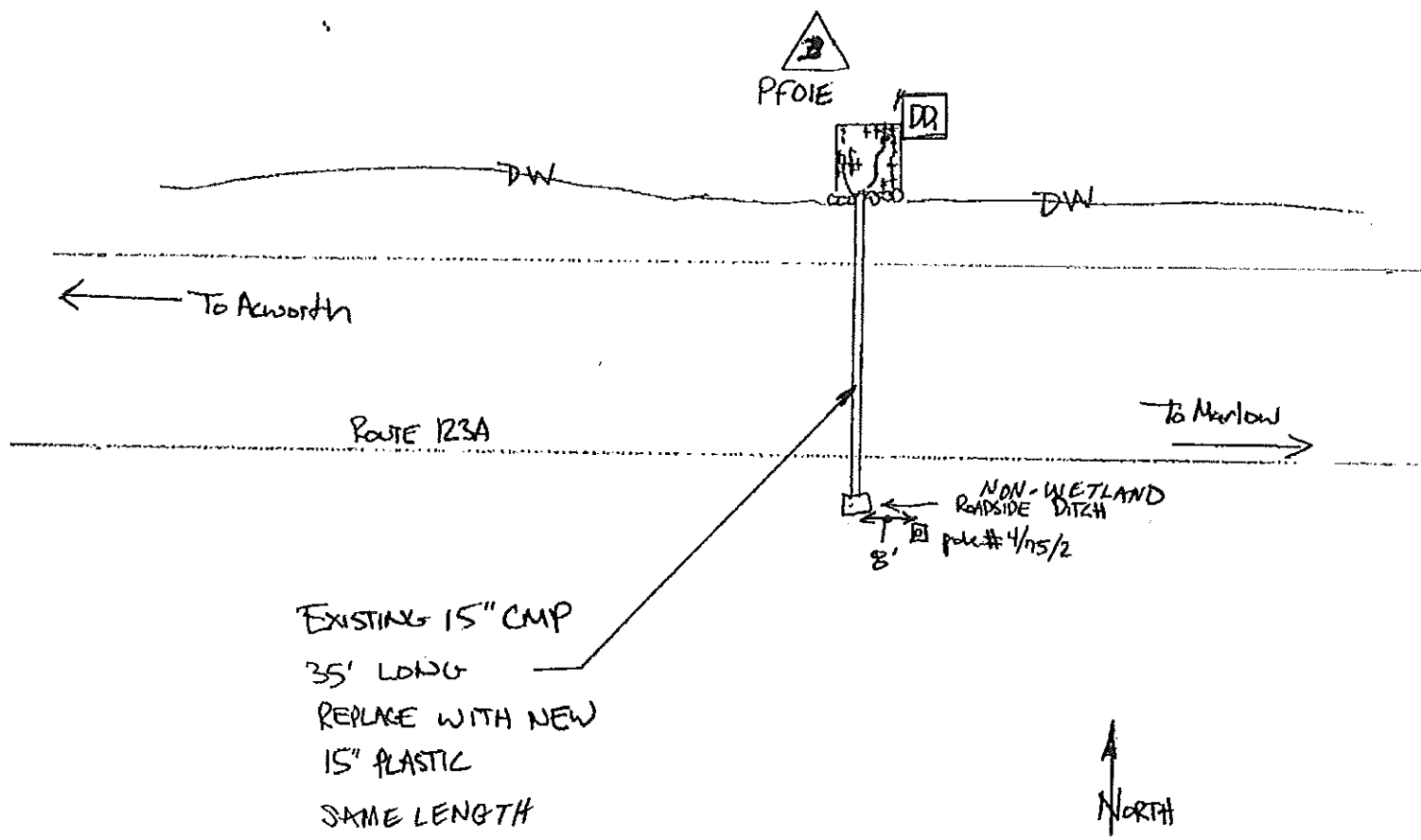

ROUTE 123A

Alstead-Langdon-Acworth

Pipes # 37 and # 38

Scale: 1" = 20'

DRAWN BY: KJB

1/21/2016

