

DANBURY 16303



BRIDGE REPLACEMENT CONCEPTUAL PLAN

LEGEND

- Travel Way of Proposed Roadway
- Shoulder of Proposed Roadway
- Access Points to Proposed Roadway (Drives, etc.)
- Approximate Limit of Slope Work and Landscaping
- Removal of Existing Pavement Outside of Slope Work
- Existing Pavement (Roadways, Drives, Sidewalks, etc.)
- Existing Gravel Surface (Drives, Paths, etc.)
- Existing Tree and/or Brush Line
- Water (Rivers, Streams, Lakes, Ponds, Swamps, etc.)
- Buildings
- Bridge Removal
- Wetlands
- Property Lines
- Existing Easement Lines
- Proposed Easement Lines
- Existing R.O.W. (Right-of-Way)
- Proposed R.O.W.
- Delineated Wetland

Prepared By
New Hampshire Department of Transportation
Highway Design Bureau

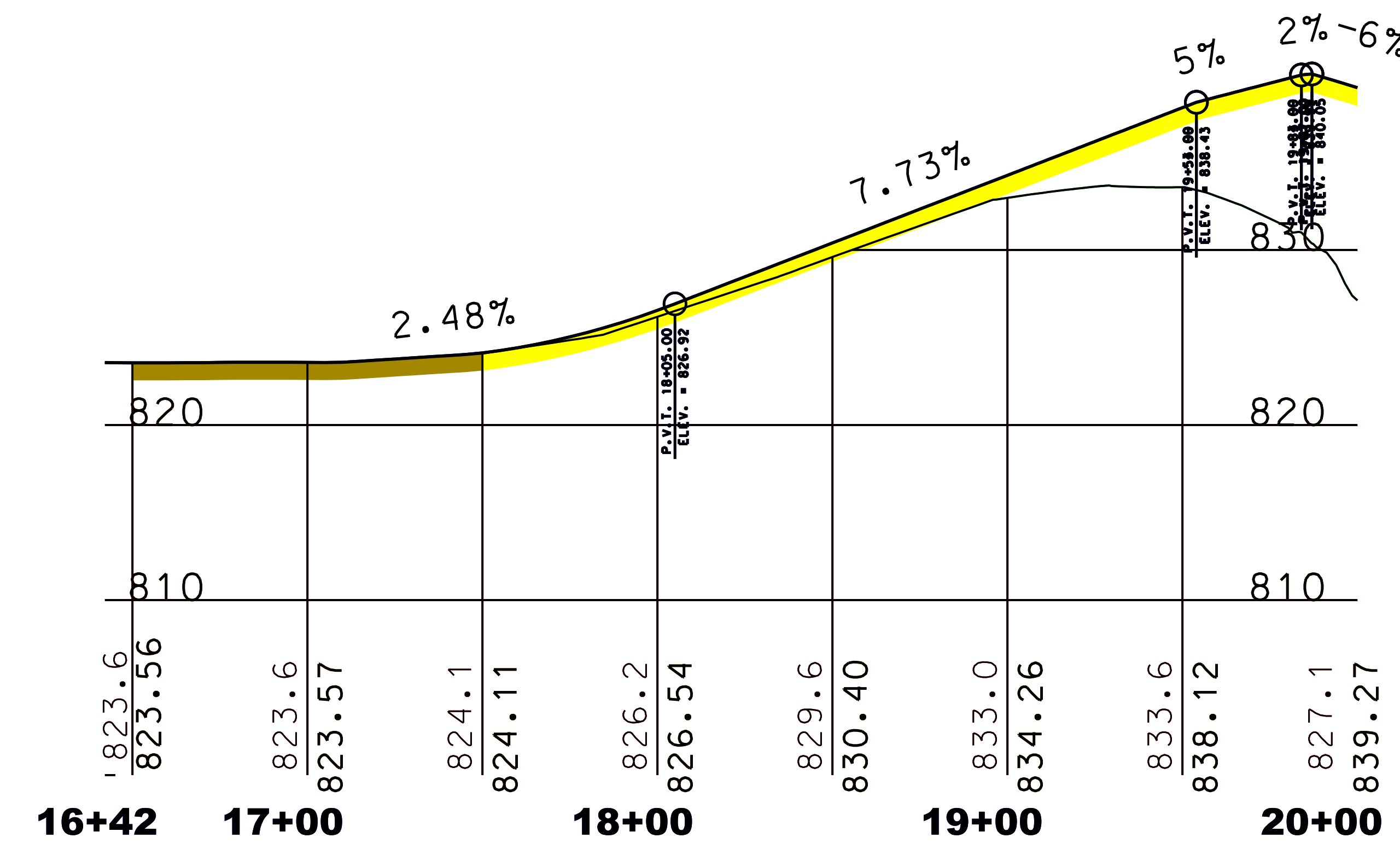


SPEAR HILL ROAD PROFILE

PLAN VIEW

PRELIMINARY PLANS
SUBJECT TO CHANGE
DATE 5/7/2018



PRELIMINARY PLANS
SUBJECT TO CHANGE
DATE 5/7/2018

US 4 PROFILE